

(SBC DEVELOPMENTS, LLLP))

PARCEL #6146100059

(THERE IS A STRIP OF LAND BETWEEN THE TWO LARGER PARCELS, THE LEGAL DESCRIPTION WAS NOT AVAILABLE ON THE MANATEE COUNTY PROPERTY APPRAISER'S WEB SITE. (OWNER: MANATEE FRUIT CO.))

WEST LINE SECTION 17-35S-17E

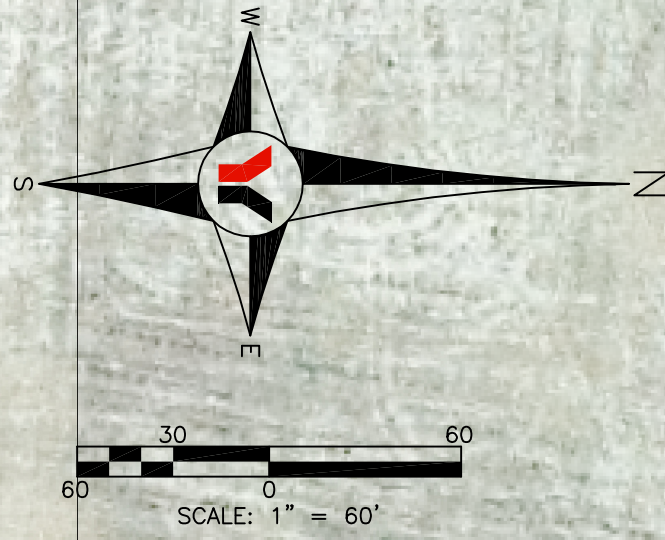

CONQUISTADOR R/W (APPROXIMATE)

(MANATEE FRUIT CO.)

(MANATEE COUNTY)

(MANATEE FRUIT CO.)

(SBC DEVELOPMENTS, LLLP))

50' EASEMENT
(O.R. 647, PG. 609)

30' EASEMENT
(O.R. 647, PG. 609)

NOTE:
SEE SHEET S2 FOR SURVEYOR'S REPORT AND OTHER INFORMATION.

SEE SHEET S6

NO.	BY	DATE	DESCRIPTION
1	P.L.	9/28/12	ADD ADJACENT PROPERTY OWNER PARCEL #6156100059
2			
3			
4			
5			

NO.	BY	DATE	DESCRIPTION
6			
7			
8			
9			
10			

NO.	INITIALS	DATE
CREW CHIEF	TKO	8/03/12
DRAWN	P.L.	9/4/12
CHECKED	MEB	9/5/12
FIELD BOOK		345/48
FIELD DATE		8/03/12

PREPARED FOR:
TOWN OF LONGBOAT KEY
600 GENERAL HARRIS ST.
LONGBOAT KEY, FL. 34228

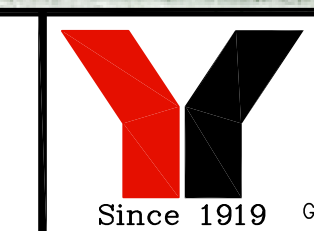

George F. Young, Inc.
10540 PORTAL CROSSING, SUITE 105 BRADENTON, FLORIDA 34211
PHONE (941) 747-2981 FAX (941) 747-7234
BUSINESS ENTITY: LE21
ARCHITECTURE-ENGINEERING-ENVIRONMENTAL-LANDSCAPE-PLANNING-SURVEYING-UTILITIES
GAINESVILLE-LAKEWOOD RANCH-ORLANDO-PALM BEACH GARDENS-ST. PETERSBURG-TAMPA-VENICE

F. PETER LUTZ, JR. PSM LS5506
DATE

LONGBOAT KEY FORCE MAIN
SPECIFIC PURPOSE SURVEY
SECTION 17, TOWNSHIP 35S., RANGE 17E.

JOB NO. 12003800LS
SHEET NO. S7 OF S7