

(SBC DEVELOPMENTS, LLP))

# PARCEL

## #6146100059

(THERE IS A STRIP OF LAND BETWEEN THE TWO LARGER PARCELS, THE LEGAL DESCRIPTION WAS NOT AVAILABLE ON THE MANATEE COUNTY PROPERTY APPRAISER'S WEB SITE. (OWNER: MANATEE FRUIT CO))

WEST LINE SECTION 17-35S-17E.

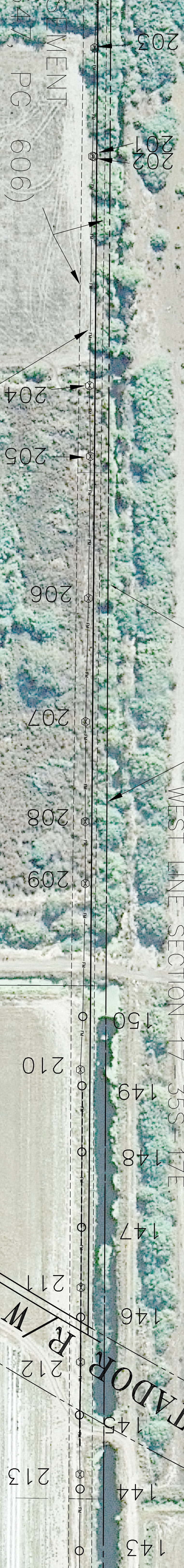
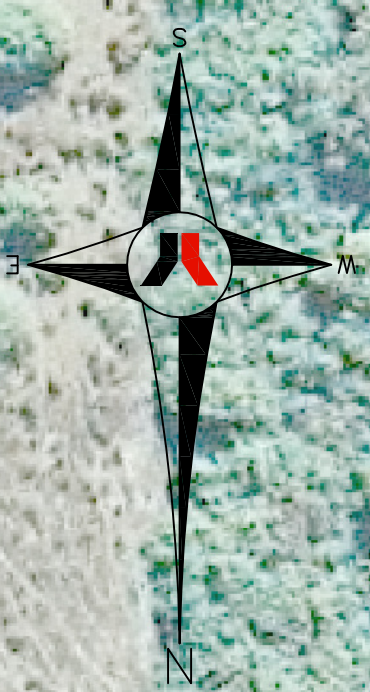

EXISTING FORCE MAIN  
(SEE NOTE #12)

CEMENT EXISTING FORCE MAIN  
(SEE NOTE #12)

SEE SHEET S7

# PARCEL

## #6147110159

SEE SHEET S5

(SBC DEVELOPMENTS, LLP)

NOTE:  
SEE SHEET S7 FOR SURVEYOR'S REPORT AND OTHER INFORMATION.

NO.	BY	DATE	DESCRIPTION
1	P.L.	9/28/12	ADD ADJACENT PROPERTY OWNER PARCEL #6156100059
2			
3			
4			
5			

NO.	BY	DATE	DESCRIPTION	INITIALS	DATE
6			CREW CHIEF	TWO	8/03/12
7			CHECKED	P.L.	9/4/12
8			FIELD BOOK	MEB	3/5/12
9			FIELD DATE		8/03/12
10					

PREPARED FOR:  
**TOWN OF LONGBOAT KEY**  
600 GENERAL HARRIS ST.  
LONGBOAT KEY, FL. 34228

**George F. Young, Inc.**  
10540 PERAL GROSSING, SUITE 105 BRADENTON, FLORIDA 34211  
PHONE (941) 752-2888 FAX (941) 752-7234  
ARCHITECTURE-ENGINEERING-ENVIRONMENTAL-PLANNING-SCIENCE-UTILITIES  
SINCE 1919 GAINESVILLE-KENWOOD BAY-CHERRYLAND-PALE BEACH GARDENS-ST. PETERSBURG-TAMPA-VENICE

LONGBOAT KEY FORCE MAIN  
SPECIFIC PURPOSE SURVEY  
SECTION 17, TOWNSHIP 35S., RANGE 17E.

JOB NO. 12003800LS  
SHEET NO. S6 OF S7