

CONNECT 10" PVC MAIN TO EXISTING 10" PVC WATER MAIN.  
Centerline Sta. 85+71.49  
El. = 4.50

PLAN Scale 1" = 40'

BAY ISLES PARKWAY

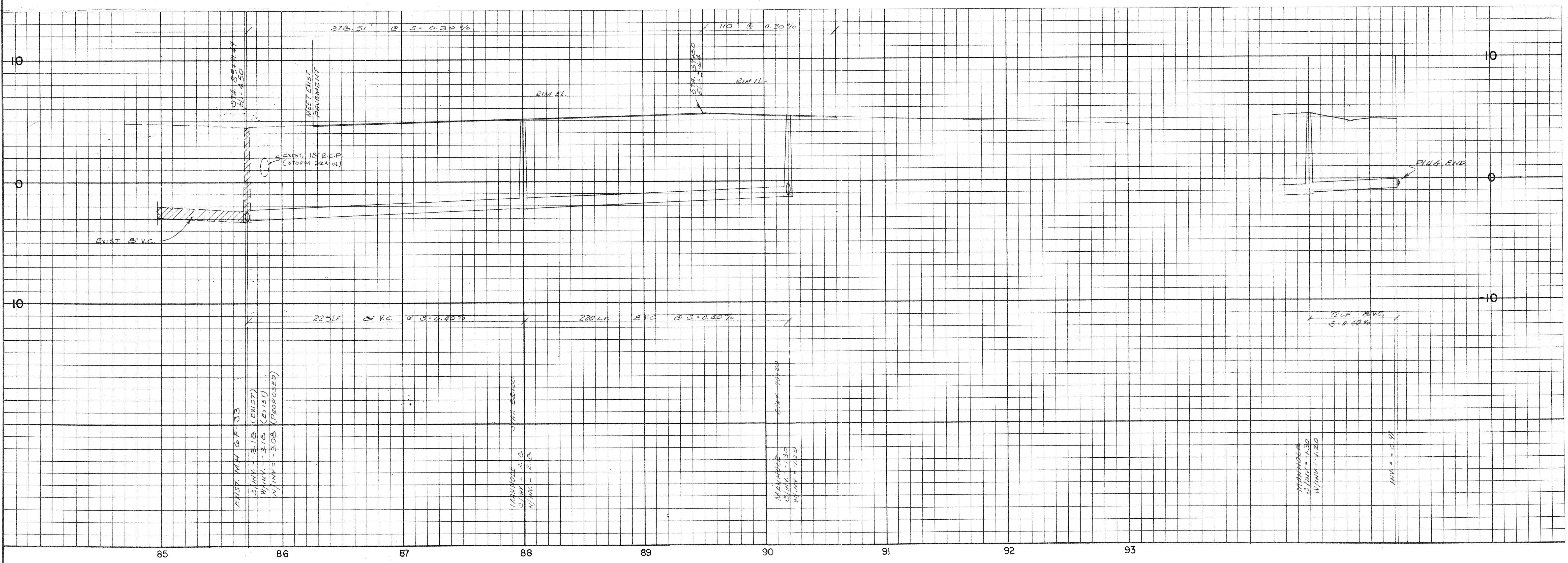

EXIST. MH GF-33  
S/MH = -3.15 (EXIST)  
W/MH = -3.15 (EXIST)  
N/MH = -3.05 (PROPOSED)

MANHOLE START 88+100  
S/MH = -2.15  
W/MH = -2.15

MANHOLE START 90+250  
S/MH = -1.50  
W/MH = -1.50

MANHOLE  
S/MH = -1.50  
W/MH = -1.50

VALVE  
ELEV = -0.10

**ARVIDA CORPORATION**  
GOLF COURSE MAINTENANCE AREA

**BENNETT & BISHOP**  
CONSULTING ENGINEERS SURVEYORS  
SARASOTA, FLORIDA

APPROVED BY: *William S. Bishop*

DATE	SCALE	DESIGN	DRAWN	CHECK	DESCRIPTION
FEB 24, 1982	1" = 40'				CONSTRUCT 10" PVC WATER MAIN, MANHOLES, VALVES, HYDRANT ASSEMBLY, AND SERVICE LINES.

LONGBOAT KEY PI PROFILE

DWRG. No. 191-554