

Notes: 1. PIPE SLEEVE SETS - INSTALL TWO 4" Ø PIPE SLEEVES AND ONE 1" Ø PIPE SLEEVE. 1" MIN. SEPARATION, 24" MIN. COVER, PLUG ENDS.

R/W = R=650' A=512.66' D=64°10'05"

Q CURVE DATA
 Δ = 66°36'05"
 R = 700'
 A = 88.889'
 C = 768.646'
 T = 459.826'

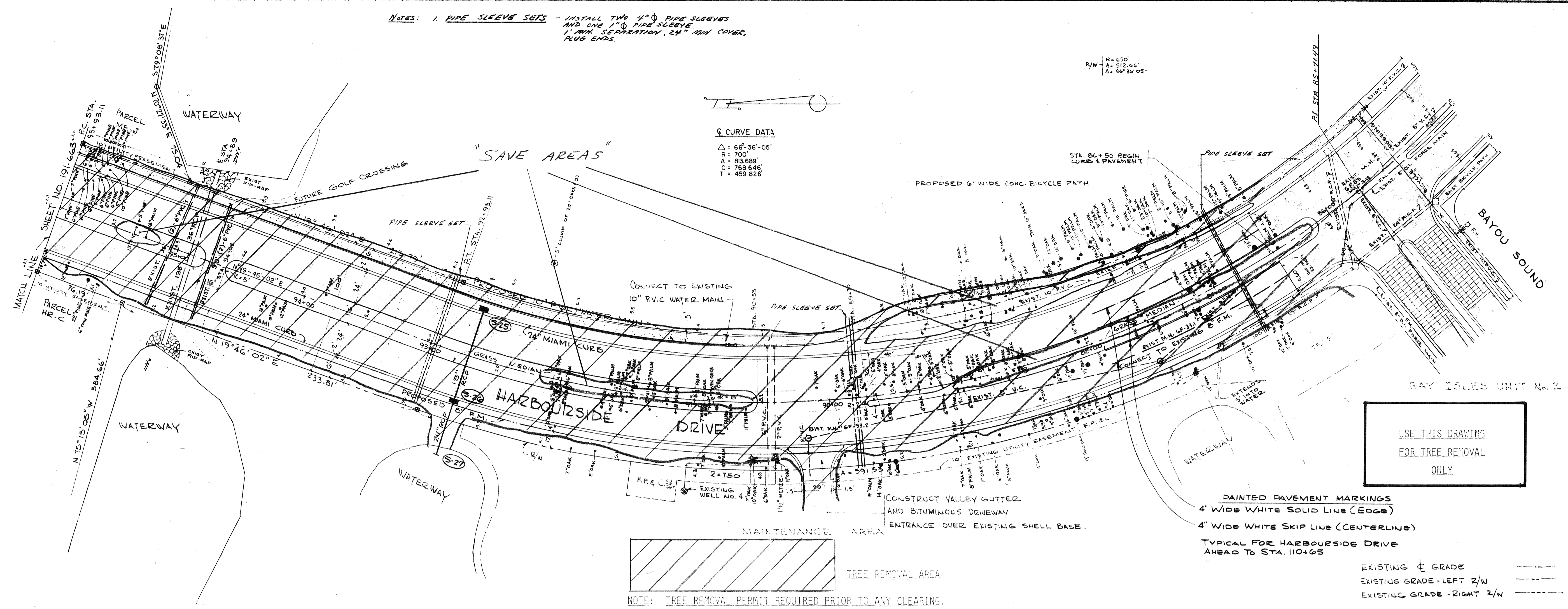

USE THIS DRAWING FOR TREE REMOVAL ONLY

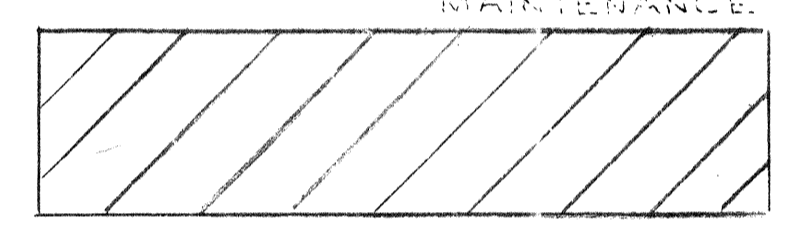

NOTE: TREE REMOVAL PERMIT REQUIRED PRIOR TO ANY CLEARING.

TREES TO BE TRANSPLANTED	
Species	No.
Palm	23
TREES TO BE REMOVED	
Species	No.
Pine	21
Oak	52
Cedar	0
Fig	0
TREES WITHIN SAVE AREA	
Species	No.
Oak	43
Palm	11
Pine	0
Fig	1

PAINTED PAVEMENT MARKINGS
 4" Wide White Solid Line (Edge)
 4" Wide White Skip Line (Centerline)
 TYPICAL FOR HARBOURSIDE DRIVE AHEAD TO STA. 110+65

EXISTING ± GRADE
 EXISTING GRADE - LEFT R/W
 EXISTING GRADE - RIGHT R/W

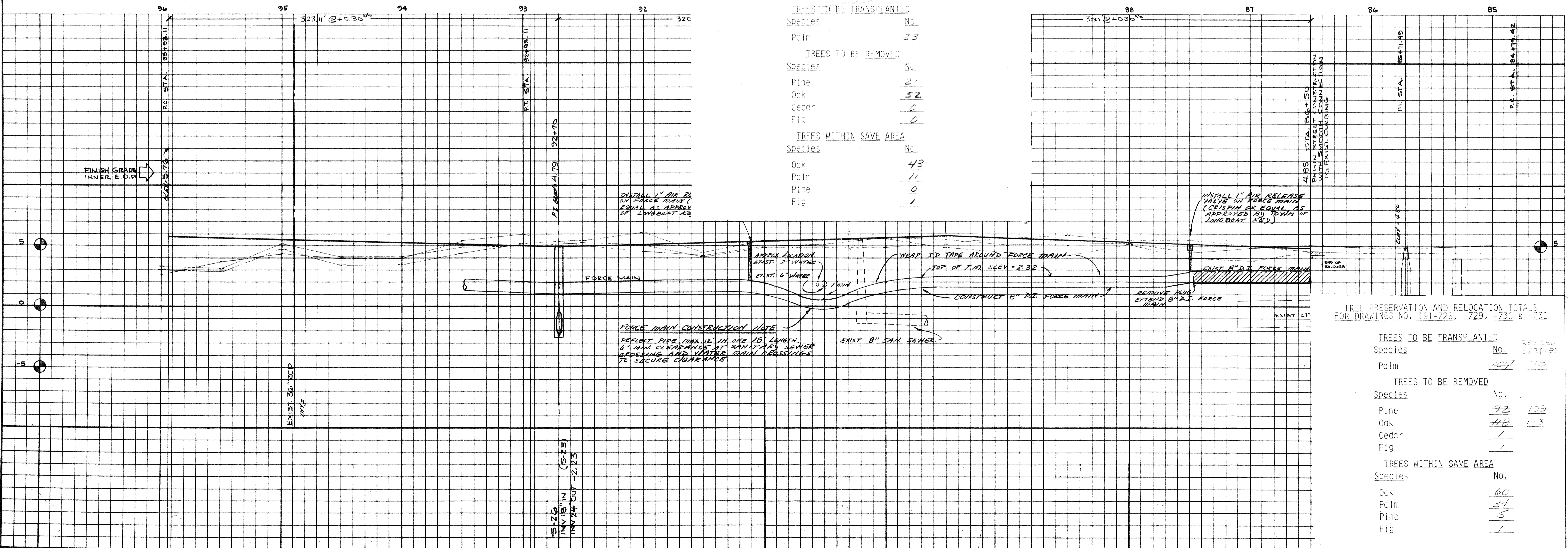

FORCE MAIN CONSTRUCTION NOTE
 DEFLECT PIPE MAX 12" IN ONE 10' LENGTH. 6" MIN. CLEARANCE AT SANITARY SEWER CROSSING AND WATER MAIN CROSSINGS TO SECURE CLEARANCE.

INSTALL 1" AIR RELEASE VALVE IN FORCE MAIN (CORSEPIN OR EQUAL AS APPROVED BY TOWN OF LONGBOAT KEY)

TREE PRESERVATION AND RELOCATION TOTALS FOR DRAWINGS NO. 191-726, -729, -730 & -731

TREES TO BE TRANSPLANTED	
Species	No.
Palm	407
TREES TO BE REMOVED	
Species	No.
Pine	42
Oak	112
Cedar	1
Fig	1
TREES WITHIN SAVE AREA	
Species	No.
Oak	60
Palm	34
Pine	5
Fig	1

BENNETT & BISHOP
 CONSULTING ENGINEERS & SURVEYORS
 SARASOTA, FLORIDA

ARVIDA CORPORATION
 HARBOURSIDE DRIVE
 TREE PRESERVATION AND RELOCATION DRAWING

DATE: 1-5-83
 SCALE: AS SHOWN
 DRAWN: [Signature]
 CHECK: [Signature]
 APPROVED: [Signature]

DWG. No. 191-728