

BENNETT & BISHOP
 SARASOTA, FLORIDA
 CONSULTING ENGINEERS & SURVEYORS

APPROVED BY

RWG	REV	DESCRIPTION
7-85	REV	LOCKER PAVILION LOC.
7-85	add	note
3-84	REV	CLUB CART PAVILION DEED.
1-84	GENERAL REV.	PER TALK. 7-12-84
1-84	CHANGE	BOUNDARY LINE AS HAND-DRAWN
84	GENERAL REVISION	
84	REV	ELEV. DECK WALK

DATE	NOV. 8 (85)
SCALE	1" = 40'
DESIGN	D.D.
DRAWN	D.D.
CHECK	
APPROVED	

ARVIDA CORPORATION
HARBORSIDE CLUBHOUSE

DETAIL SITE PLAN

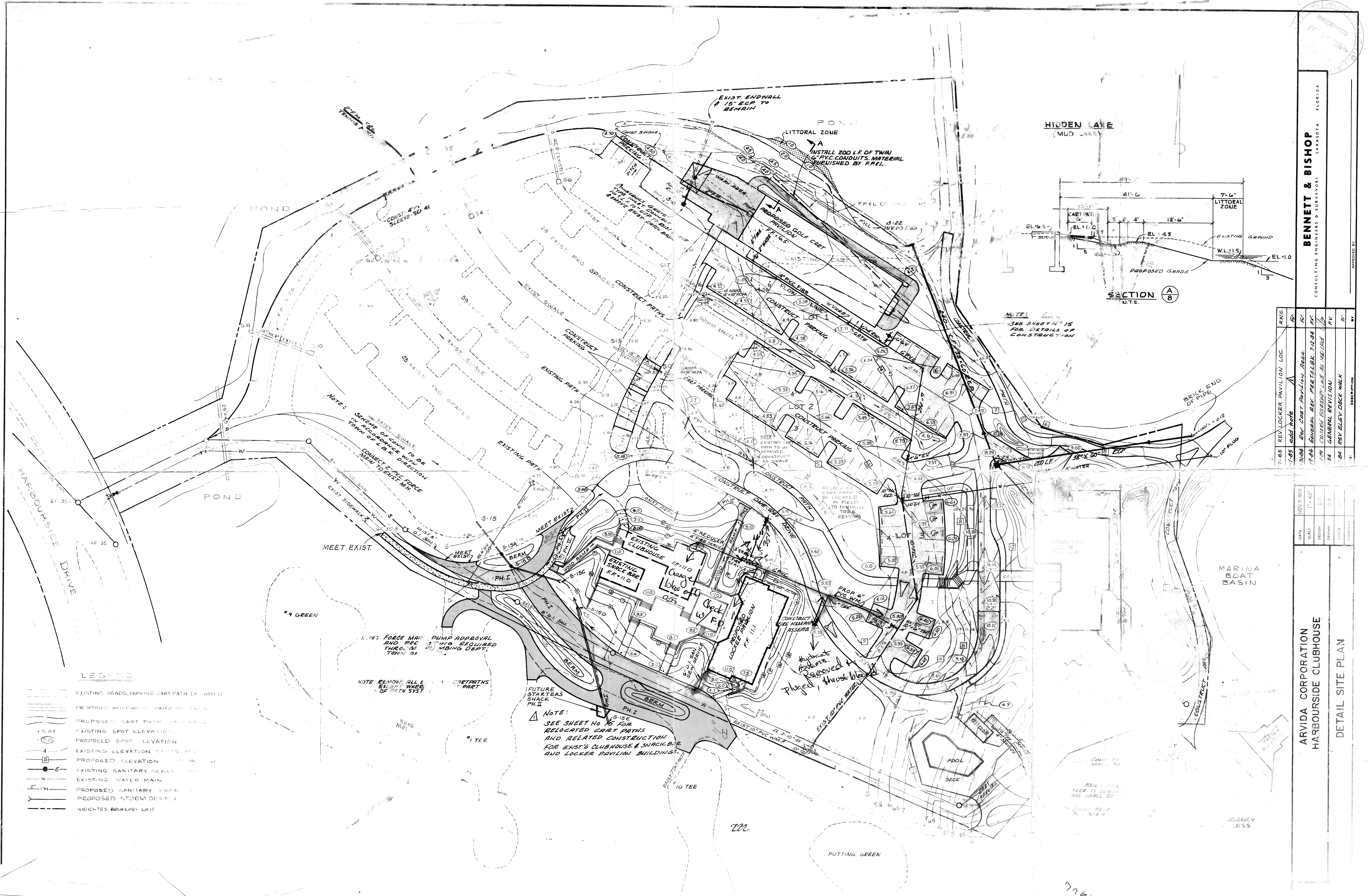

HIDDEN LAKE (MUD LAKE)

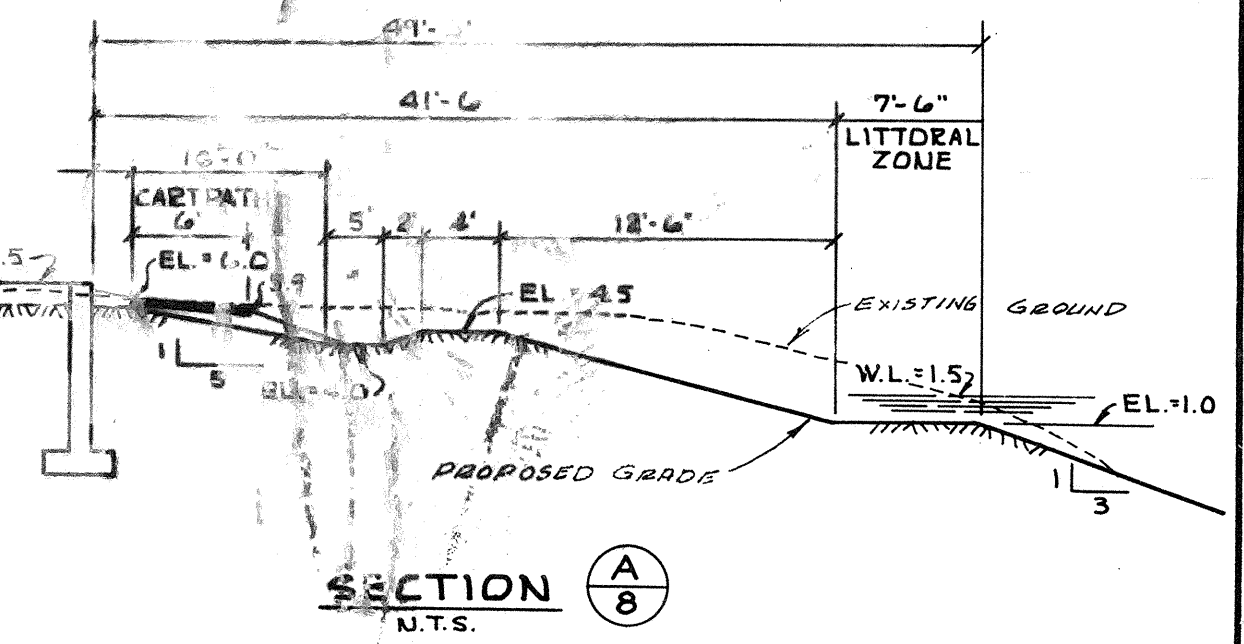

NOTE:
 SEE SHEET NO. 1015
 FOR DETAILS OF
 CONSTRUCTION

LEGEND

- EXISTING ROADS, PARKING, CART PATH (A - NOTE 1)
- PROPOSED ROADWAYS, PARKING, CART PATH
- PROPOSED CART PATH (A - NOTE 1)
- 5.07 EXISTING SPOT ELEVATION
- 5.25 PROPOSED SPOT ELEVATION
- 4 EXISTING ELEVATION CONTROL POINT
- 5 PROPOSED ELEVATION CONTROL POINT
- EXISTING SANITARY SERVICE LINE
- W EXISTING WATER MAIN
- 2" FM PROPOSED SANITARY FUTURE MAIN
- PROPOSED STORM DRAIN
- INDICATES BOUNDARY LINE

NOTE: FORCE MAIN AND 2" PIPES REQUIRED THROUGH TOWN OF ARVIDA. PUMP APPROVAL AND PERMITS REQUIRED BY PUB. WORKS DEPT.

NOTE: REMOVE ALL EXISTING WIRES OF POTN SYST. RETRACKS PREP.

NOTE:
 SEE SHEET NO. 1008
 RELOCATED CART PATHS
 AND RELATED CONSTRUCTION
 FOR EXIST'G CLUBHOUSE & SNACK BAR
 AND LOCKER PAVILION BUILDINGS.

Hydroent. Assemblies Proposed through lake.

7-9-85