

HARBORSIDE TENNIS CLUB

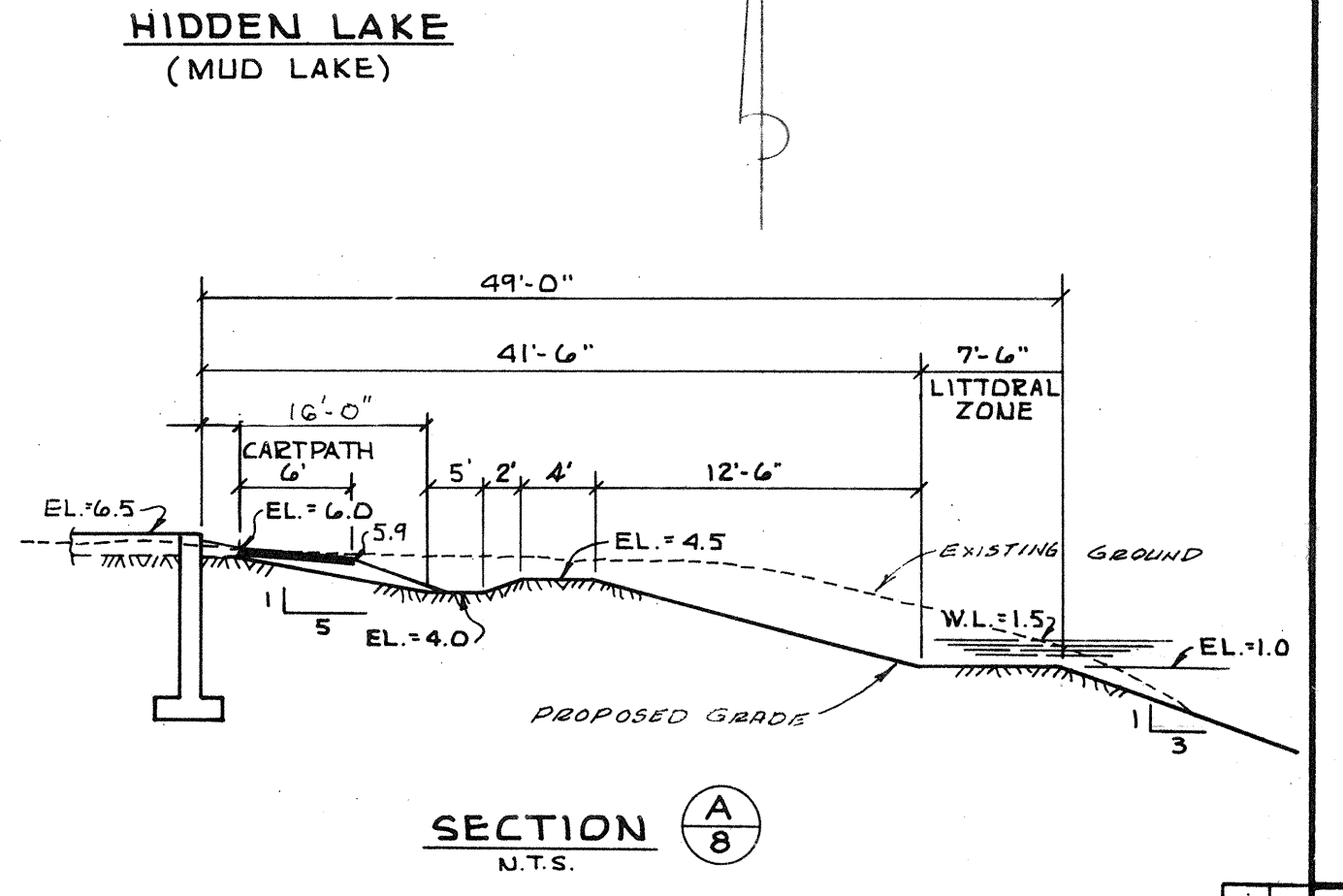
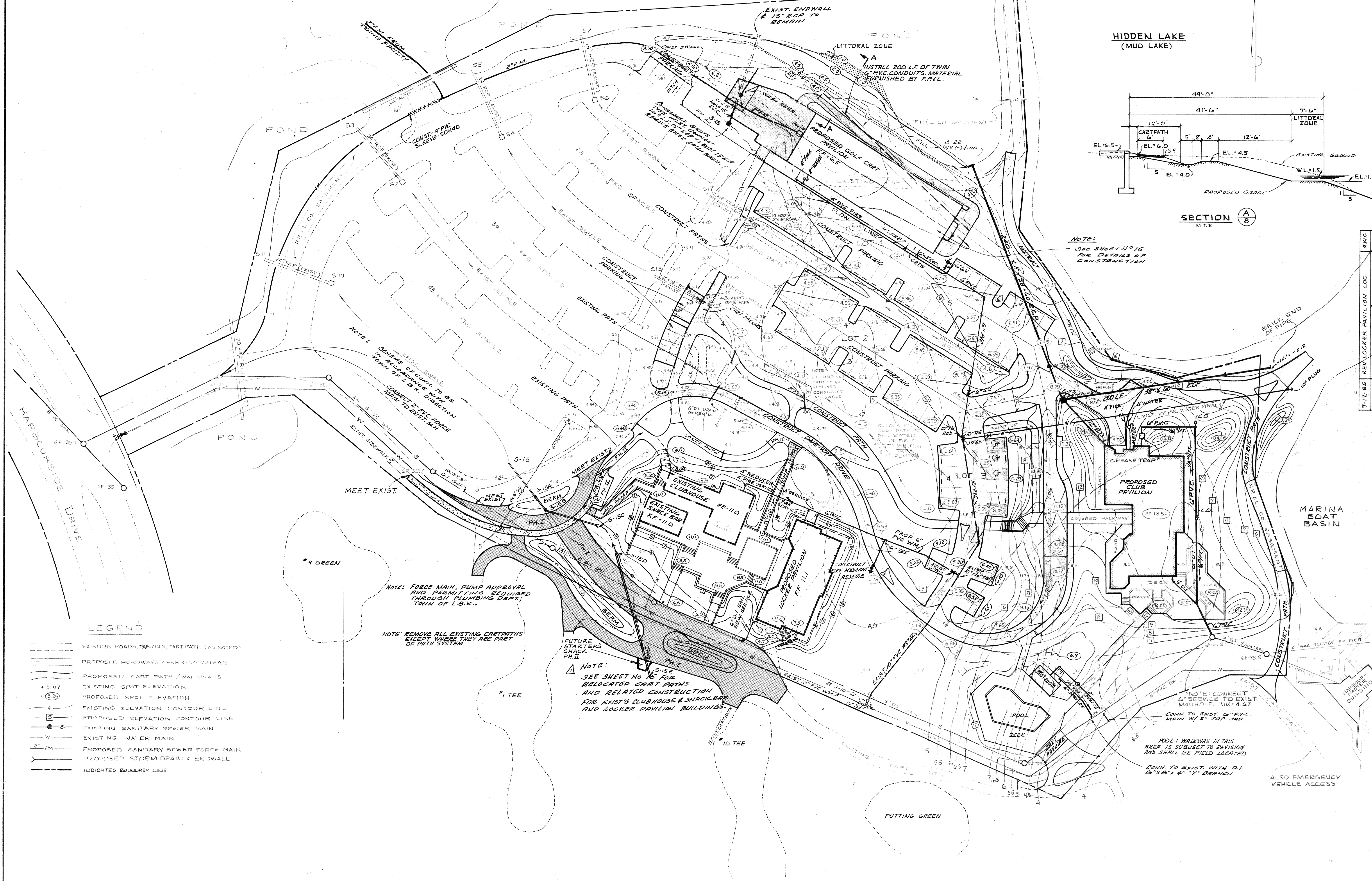

NOTE:  
SEE SHEET NO. 15  
FOR DETAILS OF  
CONSTRUCTION

LEGEND

- EXISTING ROADS, PARKING, CART PATH (AS NOTED)
- PROPOSED ROADWAYS / PARKING AREAS
- PROPOSED CART PATH / WALKWAYS
- 5.07 EXISTING SPOT ELEVATION
- 5.25 PROPOSED SPOT ELEVATION
- 4 EXISTING ELEVATION CONTOUR LINE
- 5 PROPOSED ELEVATION CONTOUR LINE
- EXISTING SANITARY SEWER MAIN
- W EXISTING WATER MAIN
- 2" FM PROPOSED SANITARY SEWER FORCE MAIN
- PROPOSED STORM DRAIN & ENDWALL
- - - - - UNLOCATED BOUNDARY LINE

NOTE: FORCE MAIN, PUMP APPROVAL  
AND PERMITTING REQUIRED  
THROUGH PLUMBING DEPT.,  
TOWN OF L.B.K.

NOTE: REMOVE ALL EXISTING CARTPATHS  
EXCEPT WHERE THEY ARE PART  
OF PATH SYSTEM.

NOTE:  
SEE SHEET NO. 14 FOR  
RELOCATED CART PATHS  
AND RELATED CONSTRUCTION  
FOR EXIST' CLUBHOUSE & SNACKBAR  
AND LOCKER PAVILION BUILDINGS.

NOTE: CONNECT  
L" SERVICE TO EXIST.  
MANHOLE INV. 4.67  
CONN. TO EXIST. 6" P.V.C.  
MAIN W/ 2" TRAP. SHD.

POOL 1 WALKWAY IN THIS  
AREA IS SUBJECT TO REVISION  
AND SHALL BE FIELD LOCATED  
CONN. TO EXIST. WITH D.I.  
8" X 8" X 4" Y" BRANCH

NO.	DATE	DESCRIPTION
1	7-17-85	REV. LOCKER PAVILION LOC.
2	7-1-85	add note
3	11-3-84	Rev. Cart Pavilion DEEP.
4	7-19-84	GENERAL REV. PARALLEL TIE-INS
5	5-20-84	CHANGE SUBMITTAL LINE TO ADDRESS
6	2-3-84	GENERAL REVISION
7	1-25-84	REV. ELEY DECK WALK

DATE	SCALE	DESIGN	DRAWN	CHECK	APPROVED
NOV. 8, 1985	1" = 40'				

ARVIDA CORPORATION  
HARBORSIDE CLUBHOUSE  
DETAIL SITE PLAN

BENNETT & BISHOP  
CONSULTING ENGINEERS & SURVEYORS  
FLORIDA  
SARASOTA