

SANITARY SEWER PIPE SCHEDULE								
STR. NO.	TYPE	RIM EL.	INV IN	INV OUT	FROM - TO	LENGTH	SIZE AND TYPE	GRADE
MH7F-7	EX. MANHOLE	4.80	-5.85	-5.92				
MH 1	MANHOLE	5.83	-5.45	-5.50	MH7F-7 MH 1	125 LF	10" PVC	0.28%
MH 2	MANHOLE	6.31	-5.05	-5.10	MH 1 MH 2	126 LF	10" PVC	0.28%
MH 3	MANHOLE	5.98	-4.27	-4.32	MH 2 MH 3	260 LF	10" PVC	0.28%
MH 4	MANHOLE	5.83	-3.23	-3.28	MH 3 MH 4	353 LF	10" PVC	0.28%
MH 5	MANHOLE	6.20	-2.91	-2.96	MH 4 MH 5	93 LF	10" PVC	0.28%
MH 6	MANHOLE	5.54	-2.09	-2.14	MH 5 MH 6	277 LF	10" PVC	0.28%
MH 7	MANHOLE	6.16	-1.56	-1.61	MH 6 MH 7	120 LF	8" PVC	0.40%
MH 8	MANHOLE	5.87	0.09	0.04	MH 7 MH 8	400 LF	8" PVC	0.40%
MH 9	MANHOLE	5.55	0.48	0.43	MH 8 MH 9	86 LF	8" PVC	0.40%
MH10	MANHOLE	5.91	0.90	0.85	MH 9 MH10	93 LF	8" PVC	0.40%
MH11	MANHOLE	5.88	2.04	1.99	MH10 MH11	272 LF	8" DIP	0.40%
MH12	MANHOLE	5.67	2.48		MH11 MH12	109 LF	8" DIP	0.40%
MH 1	MANHOLE	5.83	-4.04	-5.50	MH 1 MH13	109 LF	8" PVC	1.38%
MH13	MANHOLE	5.27	-7.95	-3.00	MH13 MH14	221 LF	8" PVC	1.38%
MH14	MANHOLE	6.08	-0.10					

SANITARY SEWER PIPE SCHEDULE								
STR. NO.	TYPE	RIM EL.	INV IN	INV OUT	FROM - TO	LENGTH	SIZE AND TYPE	GRADE
MH 9	MANHOLE	5.55	0.48	0.43	MH 9 MH15	109 LF	8" PVC	0.40%
MH15	MANHOLE	5.94	0.97	0.92	MH15 MH16	143 LF	8" PVC	0.40%
MH16	MANHOLE	7.40	1.54					
MH 6	MANHOLE	5.54	-2.09	-2.14	MH 6 MH17	93 LF	8" PVC	0.40%
MH17	MANHOLE	5.88	-1.66	-1.71	MH17 MH18	343 LF	8" PVC	0.40%
MH18	MANHOLE	5.93	-0.24	-0.29	MH18 MH19	147 LF	8" PVC	0.40%
MH19	MANHOLE	5.87	0.40	0.35	MH19 MH20	86 LF	8" PVC	0.40%
MH20	MANHOLE	5.57	0.79	0.74	MH20 MH21	264 LF	8" DIP	0.40%
MH21	MANHOLE	5.81	1.85					

NOTE 1) CONTRACTOR TO CONSTRUCT 10" WATERMAIN WITHIN EASEMENT FROM FAIROAKS LN. TO BAYOU CIRCLE, AND 8" WATERMAIN NEAR LOT 32 THROUGH OPEN SPACE, TO BE CONNECTED TO 10" WATERMAIN, AS SHOWN ON THIS SHEET.

2) CONTRACTOR TO CONSTRUCT SWALE BEHIND LOTS 1-21 WHICH SHOULD BE GRADED TO DISCHARGE TO INLETS B-1 & B-2, AS SHOWN, AND BEHIND LOTS 32-35 WHICH SHOULD BE GRADED TO DISCHARGE TO INLETS S-F1 & S-F2, AS SHOWN (SEE SECTION A, SHEET 22 FOR DETAILS)

3) CONTRACTOR TO CONSTRUCT 12' WIDE EMERGENCY ACCESS LANE WITHIN EASEMENT CONNECTING FAIROAKS LN. & BAYOU CIR., AS SHOWN (SEE SHEET 22 FOR DETAILS)

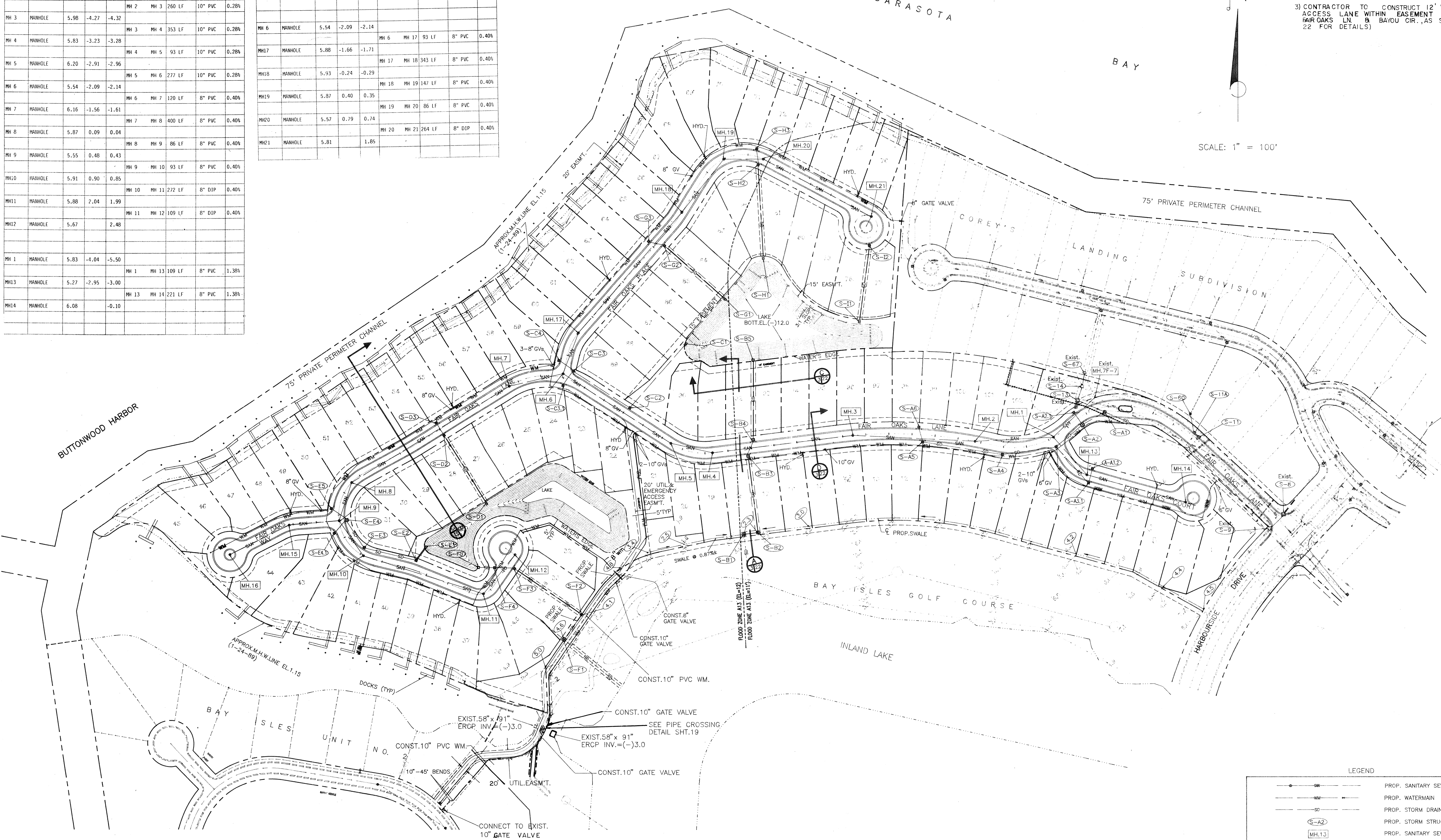
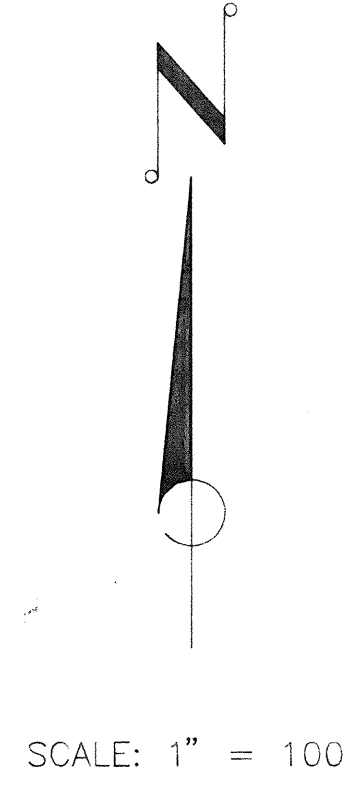

CLIENT/TITLE: _____
 PROJECT NO: _____
 SHEET NO: _____
 DATE: _____
 SCALE: _____
 REV. DATE: _____

LEGEND	
	PROP. SANITARY SEWER
	PROP. WATERMAIN
	PROP. STORM DRAIN
	PROP. STORM STRUCTURE
	PROP. SANITARY SEWER

BISHOP & ASSOCIATES
 Consulting Engineers • Surveyors
 78 SARASOTA CENTER BLVD., SARASOTA, FLORIDA 34240
 813/371-6362 • Fax 813/378-3215

REVISION	BY	DATE	DESCRIPTION

DATE: 8-28-81
 SCALE: 1"=100'
 DESIGN: SR
 DRAWN: RWC
 CHECKED: [Signature]
 APPROVED: [Signature]

CLIENT/TITLE: MANCHESTER BAY
 DIAMOND - CARVER, INC.
 GENERAL SITE PLAN

PROJECT NO: DBDS-0018
 SHEET NO: 3