

NOTE: ALL STATIONING FOR SANITARY MANHOLE'S; STORM CATCH BASIN'S & INLETS ETC. ARE GIVEN RELATIVE TO THE CENTERLINE STATIONING FOR THE PROPOSED ROADWAY.

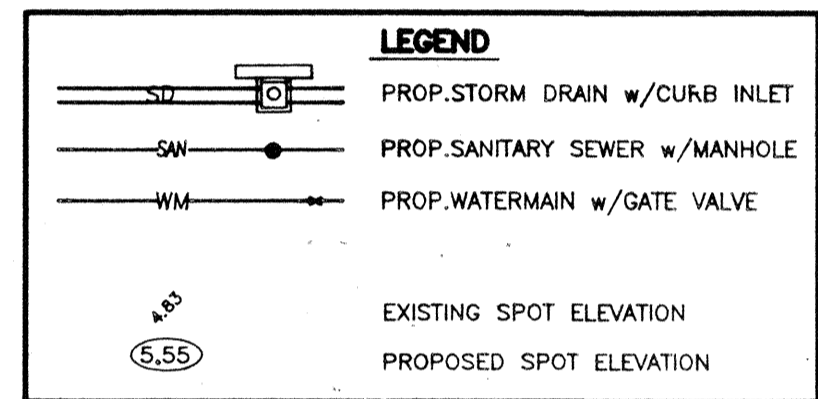

NOTE: ALL CURB IS TYPE "K" CURB UNLESS OTHERWISE NOTED

FLOOD ZONE A13 (EL.12')

FLOOD ZONE A13 (EL.11')

SCALE:
HORIZ. 1" = 20'
VERT. 1" = 4'

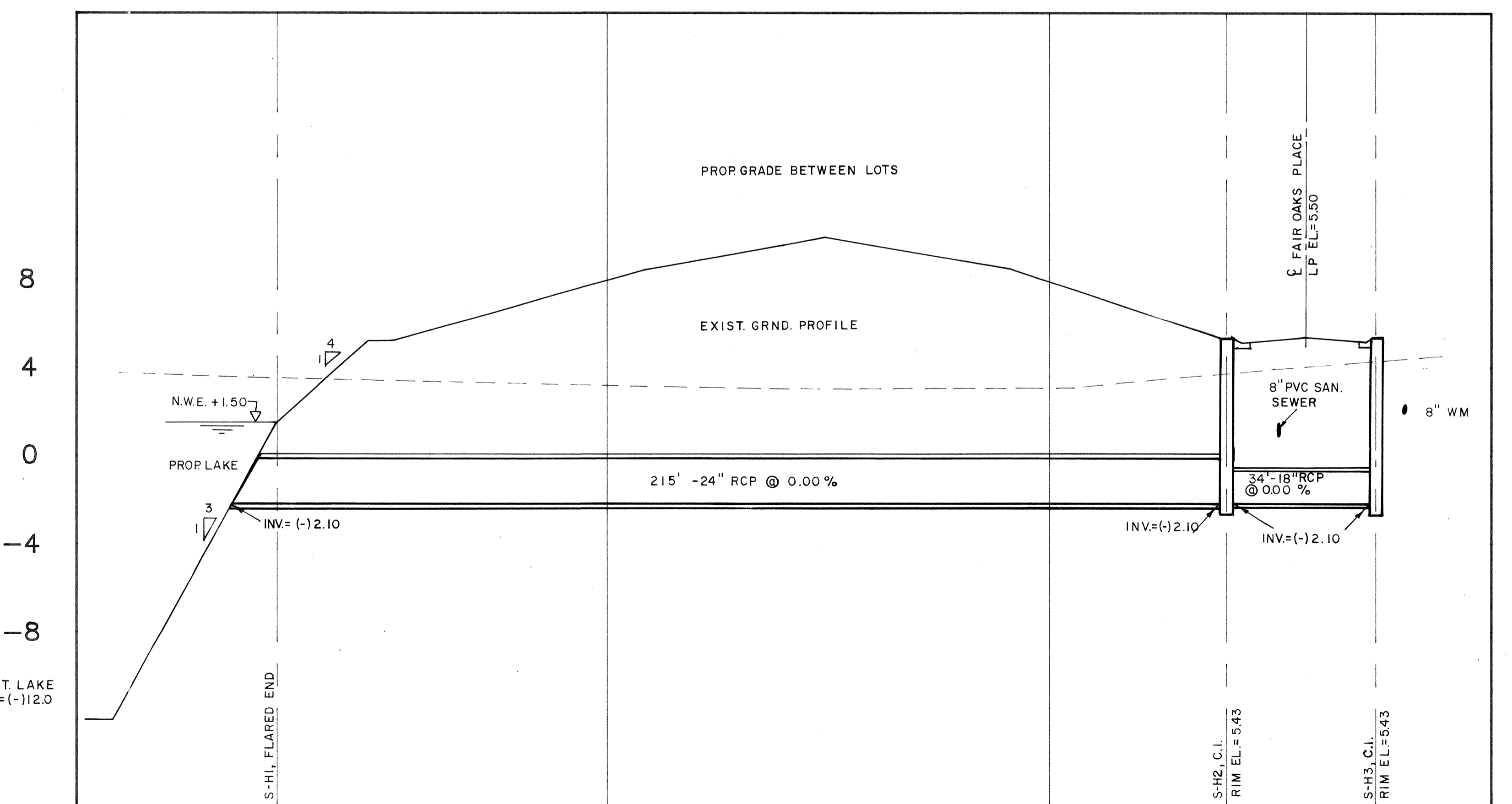
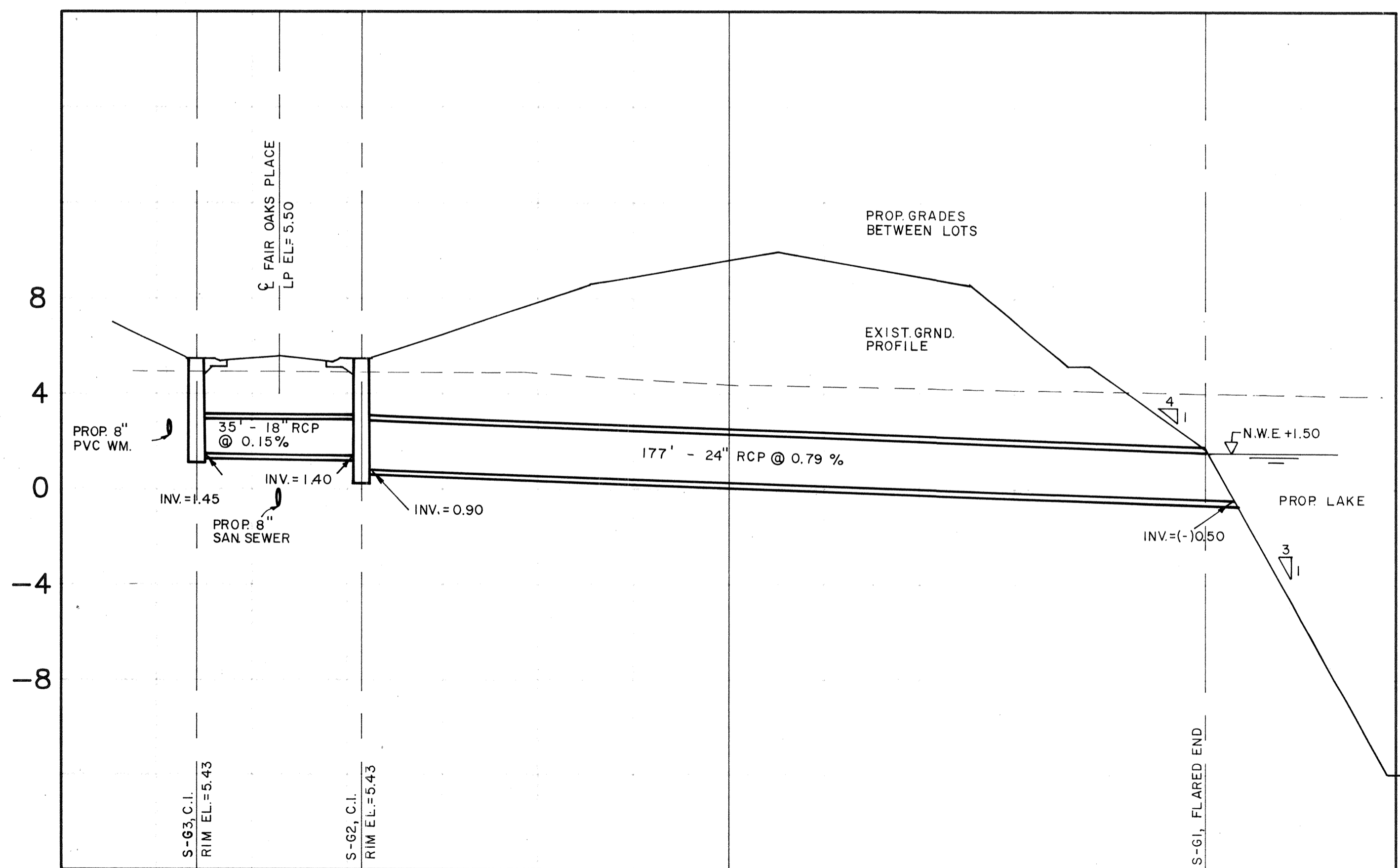

CONSTRUCTION PLANS

REVISED	BY	DATE	DESCRIPTION

DATE	9-8-89
SCALE	AS NOTED
DESIGN	S.R.
DRAWN	R.W.C.
CHECKED	PKJ/jsk
APPROVED	