

**LEGEND**

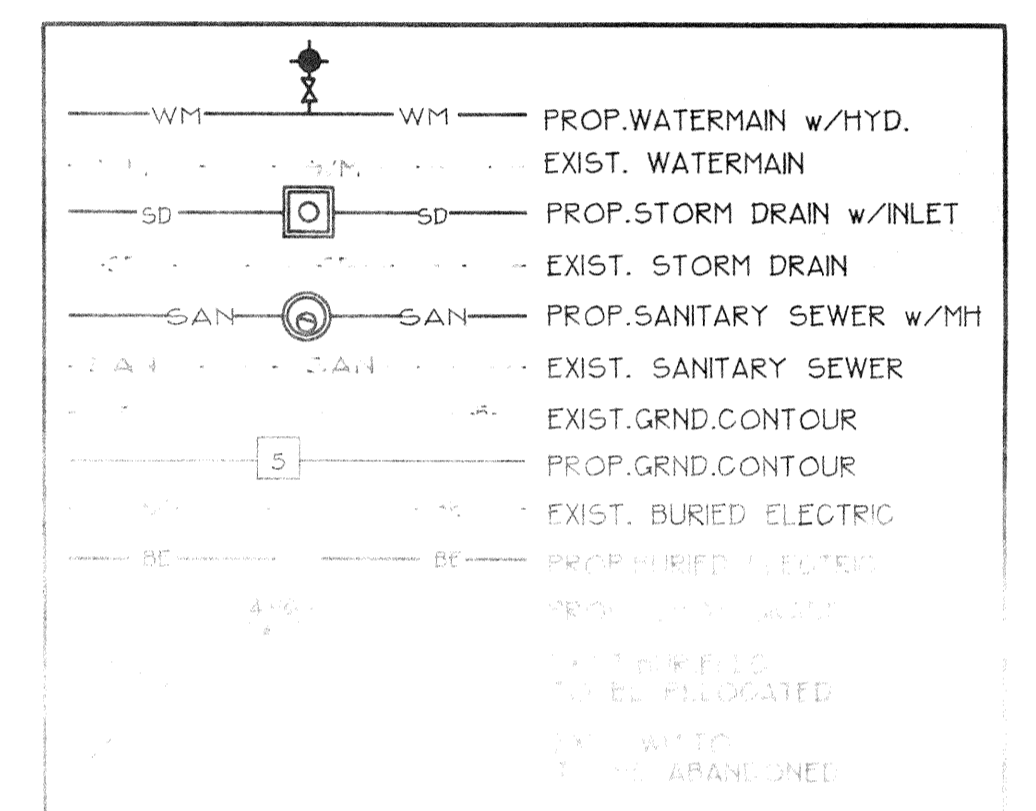

**GENERAL DATA**

1. NAME: LONGBOAT KEY YACHT CLUB + MARINA
2. OWNER: LONGBOAT KEY MARINA ASSOCIATES, LTI  
7241 S.W. 168 ST., SUITE 'C'  
MIAMI, FLORIDA 33157  
(305) 255-7333
3. LANDSCAPE ARCHITECT: DAVID W. JOHNSTON ASSOCIATES, INC.  
2055 WOOD ST.  
SARASOTA, FLORIDA 34237  
(813) 366-3159
4. ENGINEER: BISHOP + ASSOCIATES, INC.  
78 SARASOTA CENTER BLVD.  
SARASOTA, FLORIDA 34240
5. SEWAGE COLLECTION SYSTEM: TOWN OF LONGBOAT KEY  
MANATEE COUNTY UTILITY SYSTEMS
6. WATER DISTRIBUTION: TOWN OF LONGBOAT KEY  
MANATEE COUNTY UTILITY SYSTEMS
7. DRAINAGE SYSTEM: SURFACE RUNOFF TO GRATED INLETS.  
UNDERGROUND PIPES TO RETENTION POND  
WITHIN THE GOLF COURSE.
8. ALL CONSTRUCTION IN ACCORDANCE WITH  
APPLICATION PROVISIONS OF THE TOWN OF  
LONGBOAT KEY TREE ORDINANCE
9. ZONING: P.D. (PARCEL P3) COMMERCIAL AREA APPROVED IN  
LONGBOAT KEY CLUB P.D. LAND INTENSITY SCHEDULE.

**NOTES:**

- 1) TOTAL PROPOSED BUILDING FLOOR AREA= 10,050 SQ. FT.  
ALLOWABLE BUILDING FLOOR AREA= 12,000 SQ. FT. (RESOLUTION 90-43 ITEM 7)
- 2) PROPOSED BUILDING HEIGHT NOT TO EXCEED 28' ABOVE ELEV. 4.5 (TOP OF EXIST. SEAWALL).
- 3) BUILDING OUTLINE INDICATES FURTHEST OUTWARD PROJECTION (ROOF, WALL, ETC.).
- 4) BUILDING SETBACKS ARE MEASURED TO OVERHANGS OR BUILDING WALLS IN ACCORDANCE WITH TOWN OF LONGBOAT KEY CODE REQUIREMENTS.
- 5) SEE LANDSCAPE ARCHITECT PLANS EXHIBIT 'D' FOR LANDSCAPING DETAILS.
- 6) TOTAL PROPOSED PARKING SPACES= 50  
ALLOWABLE PARKING SPACES= 50 (RESOLUTION 90-43 ITEM 6).
- 7) TOTAL PROPOSED RESTAURANT SEATING= 100 SEATS  
ALLOWABLE RESTAURANT SEATING= 100 SEATS (RESOLUTION 90-43 ITEM 5)

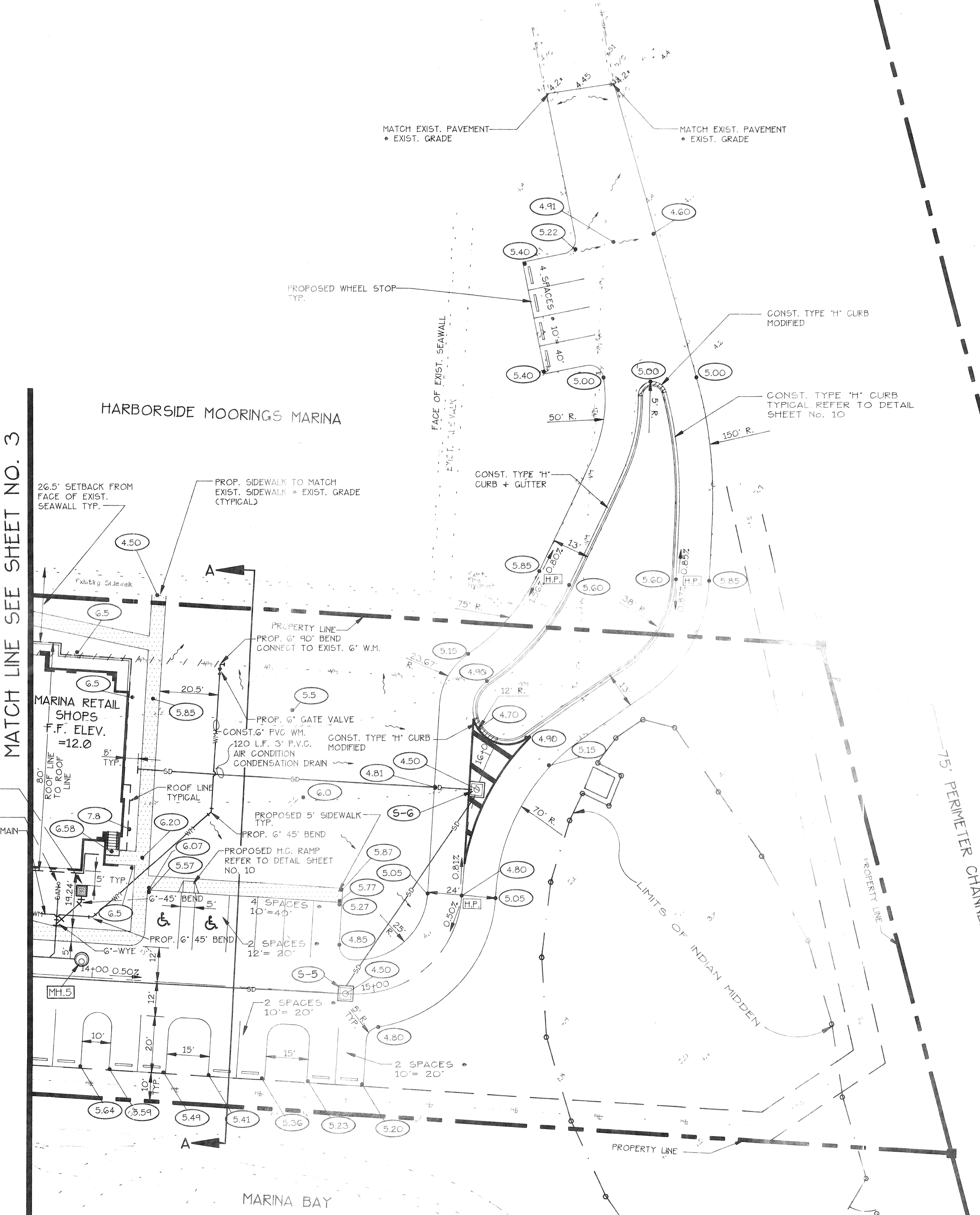

FIELD BOOK NO. \_\_\_\_\_  
PAGE \_\_\_\_\_  
DATE \_\_\_\_\_  
PLOT DATE: \_\_\_\_\_  
CAD FILE: \_\_\_\_\_  
PLOT NO.: \_\_\_\_\_

**BISHOP & ASSOCIATES**  
Consulting Engineers • Surveyors  
AN EMPLOYEE OWNED COMPANY  
78 SARASOTA CENTER BLVD., SARASOTA, FLORIDA 34241  
813/371-6362 • Fax 813/376-3215

BY	DATE	Q.C.	DATE	DESCRIPTION

TASK	INITIALS	DATE
DESIGN	G.K.L.	10.24.91
DRAWN	P.S.N.	10.24.91
CHECKED		
QUALITY CHK.		

1"=20'  
SEAL: \_\_\_\_\_  
ENGINEER: \_\_\_\_\_  
DATE: 10/24/91

LONGBOAT KEY MARINA COMMERCIAL COMPLEX  
LONGBOAT KEY MARINA ASSOCIATES, LTD.  
PAVING, GRADING, AND UTILITY PLAN  
PROJECT NO. VERN-0003  
SHEET NO. 4