

SCALE: 1" = 100'

SECTION A-A
SCALE: 1/4" = 1'-0"

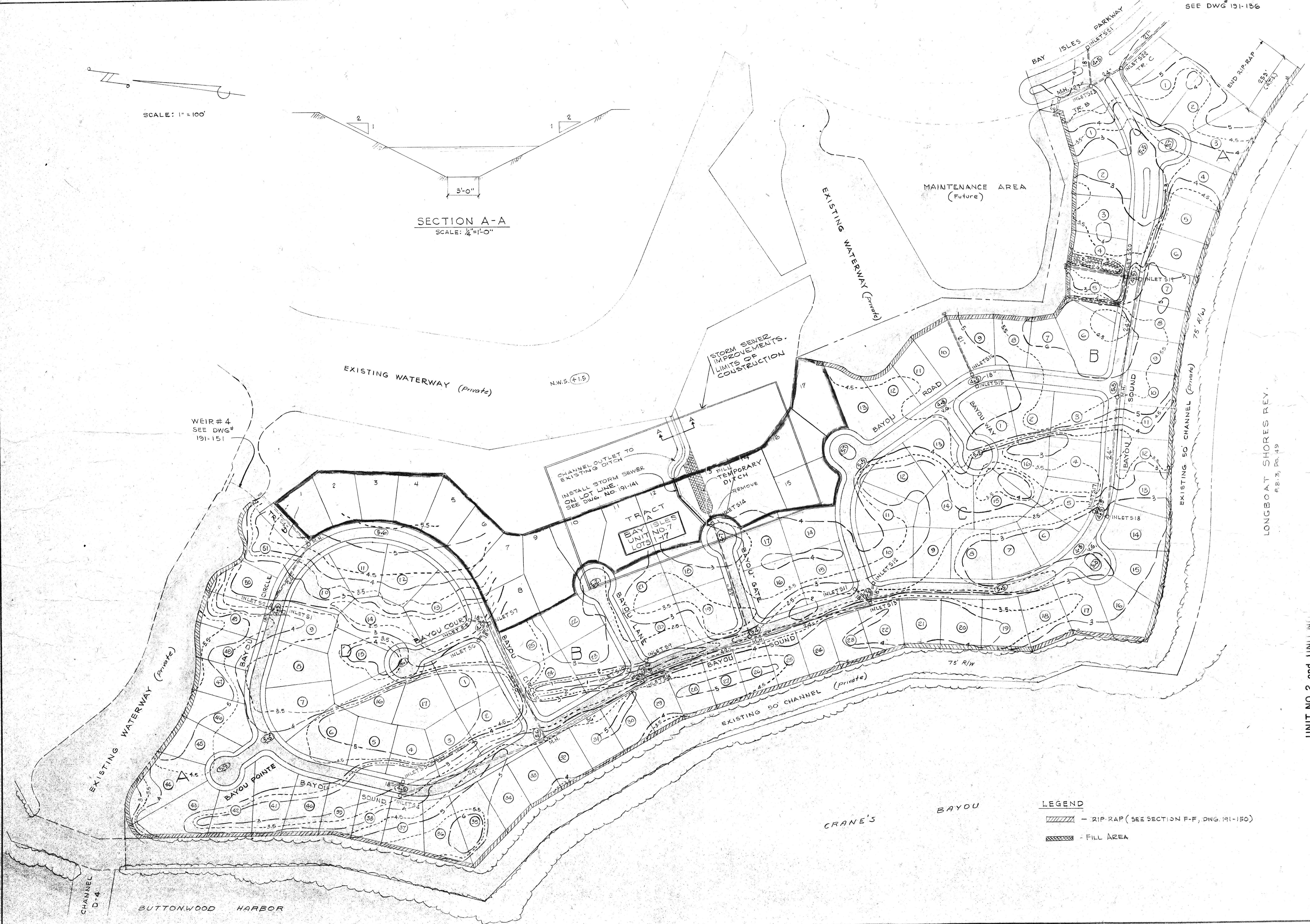
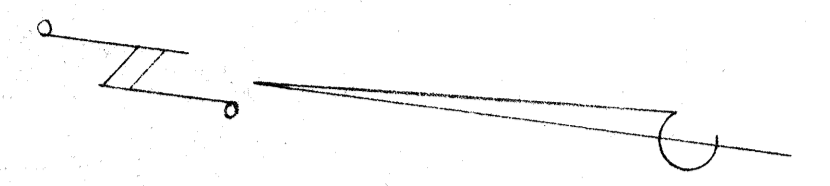
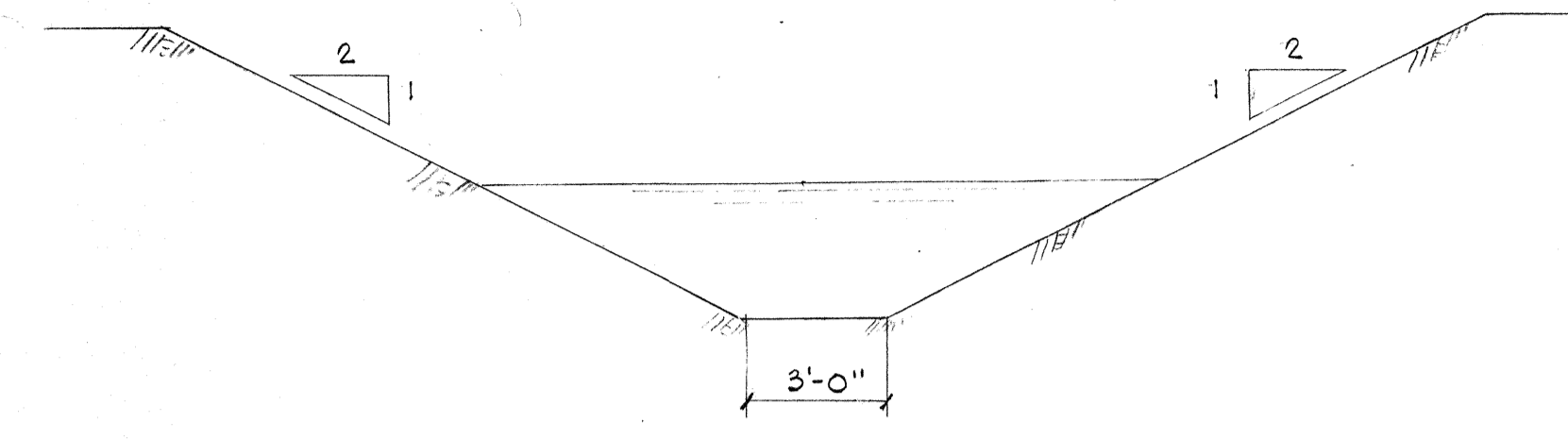

WEIR # 4
SEE DWG#
191-151

CHANNEL OUTLET TO
EXISTING DITCH
INSTALL STORM SEWER
ON LOT LINE.
SEE DWG. NO. 191-141

TRACT
BAY ISLES
UNIT NO. 7
LOTS 1-17

STORM SEWER
IMPROVEMENTS.
LIMITS OF
CONSTRUCTION

LEGEND

- RIP RAP (SEE SECTION F-F, DWG. 191-150)
- FILL AREA

LONGBOAT SHORES REY.
P.B. 3, PG. 49

UNIT NO. 2 and UNIT NO.

ARVIDA CORPORATION
BAY ISLES

DRAINAGE MASTER

BENNETT & BISHOP
CONSULTING ENGINEERS & SURVEYORS
TAMPA, FLORIDA

NO.	DATE	SCALE	DESIGN	DRAWN	CHECK	APPROVED	DESCRIPTION
1	2-15-76	1" = 100'	W.J.G.	W.J.G.			4-14-76 IMPROV. T.D. & WAS. PART OF TR. A
2	5-27-85		W.J.G.	W.J.G.			STORM SEWER, UNIT 7, BETWEEN LOTS 16-17
3	8-22-84		W.J.G.	W.J.G.			REVISED BAYOU GATE STORM
4	12-18-76		W.J.G.	W.J.G.			ADDED R.P. RAP
5							

William Bishop
DATE: 4/11/85