

GENERAL NOTES

- FOR DETAILS OF WATER SYSTEM SEE SHEET NO. 11
- ALL WATER MAINS, SANITARY SEWERS AND STORM DRAINAGE LINES SHALL BE SHOWN AND APPROVED.
- CONNECTIONS TO EXISTING AND PROPOSED WATER MAINS TO BE MADE AS SET FOR THE EXISTING WATER MAIN LOCAL PROPERTIES AND DEPENDENT THEREON IN CONFORMANCE WITH CONTRACT DOCUMENTS.
- ALL SANITARY SEWERS TO BE 15" DIA. UNLESS NOTED OTHERWISE.
- ALL 10" AND 12" WATER MAINS SHALL BE 90% (TYPICAL) CLASS 2000 PIPE UNLESS NOTED OTHERWISE.
- ALL SECTIONS ARE BASED ON M.D. 1993 DATA.
- CONNECTIONS TO EXISTING WATER MAINS SHALL BE MADE AT EXISTING CROSSINGS UNLESS NOTED OTHERWISE.
- CONNECTIONS TO EXISTING SEWERS SHALL BE MADE AT EXISTING CROSSINGS UNLESS NOTED OTHERWISE.
- CONNECTIONS TO EXISTING STORM DRAINS SHALL BE MADE AT EXISTING CROSSINGS UNLESS NOTED OTHERWISE.

INVESTIGATE BEFORE YOU EXCAVATE

CALL CANDY
1-800-282-8581

IF YOU ARE NOT SURE OF THE LOCATION OF ANY UTILITIES, CALL CANDY BEFORE YOU EXCAVATE.

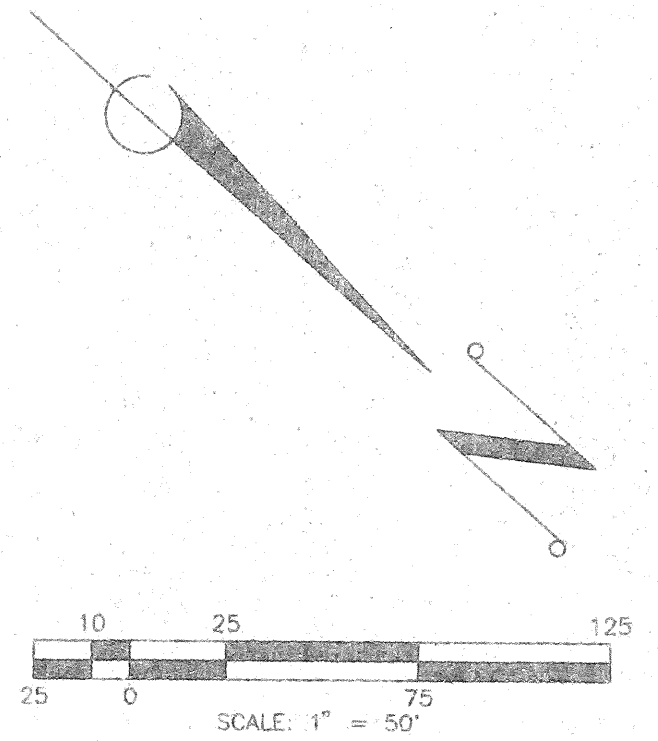

WATER SYSTEM RECORD DRAWING LOCATIONS

WITNESS MARKER	DISTANCE		DESCRIPTION
	WITNESS MARKER	WITNESS MARKER	
20	18.4	51.6	TEE
S-15	S-16		
21	S-15	S-16	45° ELBOW
22	S-15	S-16	45° ELBOW
23	16.5	54.9	TEE
S-15	S-16		
24	S-15	S-16	45° ELBOW
25	S-15	S-16	45° ELBOW
S-15	S-16		
26	9.4	81.6	TEE
S-14	S-15		
28	10.3	87.1	45° ELBOW
S-14	S-15		
29	152.6	240.6	45° ELBOW
S-12	S-13		
30	178.6	261.9	6" GATE VALVE
S-12	S-13		
31	189.9	271.1	90° ELBOW
S-12	S-13		
32	53.4	79.1	VALVE
S-1	S-3		
33	74.9	16.4	6" GATE VALVE
S-2	S-4		
34	80.1	11.2	6" GATE VALVE
S-2	S-4		
35	85.4	54.75	2" GATE VALVE
S-4	S-5		
36	16.6	50.2	6" GATE VALVE
S-15	S-16		
37	14.2	53.1	6" GATE VALVE
S-15	S-16		
38	11.3	84.2	6" GATE VALVE
S-14	S-15		
39	98.0	165.0	PLUG
S-26	S-27		
40	86'	31.7	TEE
S-2	S-4		
41	81.8	52.9	90° ELBOW
S-2	S-4		
42			
43	109.5	55.2'	45° ELBOW
S-2	S-4		
44	111.4	58.5'	45° ELBOW
S-2	S-4		
45	106.7	51.6'	45° & 90° ELBOW
S-2	S-4		
46	104.2	35.7'	90° ELBOW
S-2	S-4		

WATER SYSTEM RECORD DRAWING LOCATIONS

WITNESS MARKER	DISTANCE		DESCRIPTION
	WITNESS MARKER	WITNESS MARKER	
1	17.1	29.4	45° ELBOW
S-1	S-3		
2	46.1	8.6	45° ELBOW
S-1	S-3		
3	51.9	79.4	TEE
S-1	S-4		
4	54.4	79.3	FIRE HYDRANT
S-1	S-4		
5	72.7	16.7	TEE
S-2	S-4		
6	100.5	49.7	45° ELBOW
S-2	S-4		
8	90.8	12.0	TEE
S-2	S-4		
9	78.9	27.9	45° ELBOW
S-2	S-4		
10	108.5	50.9	45° ELBOW
S-2	S-4		
11	12.4	35.0	45° ELBOW
S-4	S-5		
12	34.9	40.2	45° ELBOW
S-4	S-5		
13	85.7	55.8	TEE
S-4	S-5		
14	92.9	128.4	TEE
S-5	S-15		
15	93.4	128.7	6" GATE VALVE
S-5	S-15		
16	135.3'	150.1'	45° ELBOW
S-5	S-15		
17	75.1'	146.4'	ELBOW
S-26	S-27		
18	97.4'	164.6'	22 1/2" ELBOW
S-26	S-27		
19	97.4'	165.3'	FIRE HYDRANT
S-26	S-27		

SANITARY SEWER SYSTEM RECORD DRAWING LOCATIONS

WITNESS MARKER	DISTANCE		DESCRIPTION
	WITNESS MARKER	WITNESS MARKER	
MANHOLE 1	81.9		MANHOLE 1 RIM EL.=7.60 INV. N. EL.=3.47 INV. S. EL.=3.52 INV. W. EL.=3.50
S-2	42.55		
S-4	S-4		
MANHOLE 2	40.2		MANHOLE 2 RIM EL.=7.45 INV. N. EL.=4.66 INV. S. EL.=4.55
S-15	48.1		
S-16	S-16		

REUSE OF DOCUMENTS
THESE DOCUMENTS ARE INSTRUMENTS OF SERVICE IN RESPECT OF THE PROJECT TO WHICH THEY APPLY AND ANY REUSE WITHOUT WRITTEN VERIFICATION OR ADAPTATION BY BISHOP AND ASSOCIATES (B&A) FOR THE SPECIFIC PURPOSES INTENDED WILL BE AT USER'S SOLE RISK AND WITHOUT LIABILITY OR LEGAL EXPOSURE TO B&A, AND USER SHALL INDEMNIFY AND HOLD HARMLESS B&A FROM ALL CLAIMS, DAMAGES, LOSSES AND EXPENSES INCLUDING ATTORNEY'S FEES ARISING OUT OF OR RESULTING THEREFROM. ANY SUCH VERIFICATION OR ADAPTATION WILL ENTITLE B&A TO FURTHER COMPENSATION AT RATES TO BE AGREED UPON BY USER AND B&A.

NOTE
STORM WATER STRUCTURES S-16, S-19 & S-20 ARE NOT CONSTRUCTED.

RECORD DRAWING

CLIENT/TITLE
THE WATER CLUB II AT LONGBOAT KEY
THE WATER CLUB II DEVELOPMENT, INC.
GENERAL DRAINAGE AND UTILITY PLAN

Max A. Callahan
06/11/99

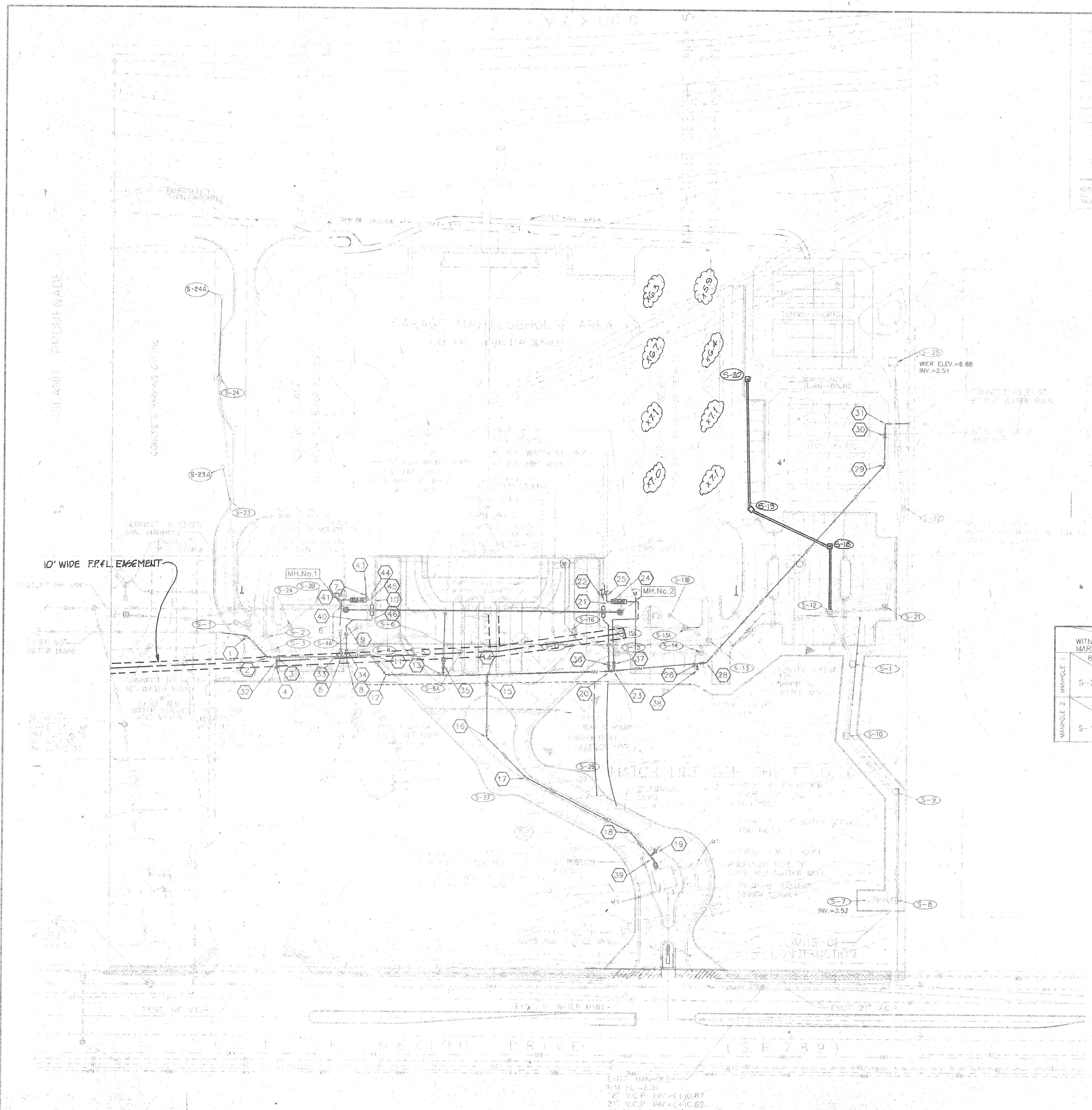

BISHOP & ASSOCIATES
Consulting Engineers • Surveyors
AN EMPLOYEE OWNED COMPANY
78 SARASOTA CENTER BLVD., SARASOTA, FLORIDA 34240
PHONE: (813)-371-6362 • FAX: (813)-378-3215

BY	DATE	Q.C.	DATE	DESCRIPTION
PSN	10-8-93	PCP	10-8-93	REV. CURB TYPE FROM RIBBON TO 7" MOD.
SWS	11/7/94	UD	1/27/94	REV. PROJECT NO., NAME, & OWNER; ADDED S-25
SWS	11/14/94	PCP	1/13/94	RELOCATE W.M. & FIRE HYD. STRUCTS S-1, S-5, & S-6
DHS	4/25/94	PCP	4/25/94	REV. WATERMAIN LOCATION
PSN	6-9-94	FIG	6-9-94	ADD WATERMAIN RECORD INFORMATION
D.B.	3-25-96			REV. AS-BUILT
AD	4-15-97			REV. TITTLE BLOCK & GAS LINE LOCATION
MS	4-21-97			ADDED PPL EASEMENT & SEPT ELEVATION
PS	6-14-99			RECORD DRAWING

TASK	INITIALS	DATE
DESIGN	P.C.P.	4-19-93
DRAWN	P.S.M.	4-28-93
CHECKED	J.W.F.B.	
QUALITY CHK.		
HORIZ. SCALE		1"=50'
VERT. SCALE		

RD-