

UTILITY LEGEND

- PROPOSED WATER METER
- PROPOSED BACKFLOW PREVENTOR
- PROPOSED FIRE HYDRANT
- PROPOSED WATER VALVE
- PROPOSED SANITARY MANHOLE
- PROPOSED BUBBLER BOX
- PROPOSED FIRELINE
- PROPOSED COMCAST CABLE ROUTING
- PROPOSED GTE CABLE ROUTING

WATER AND SEWER CONSTRUCTION NOTES

1. ALL PROPOSED IMPROVEMENTS TO THE SITE TO BE STAKED IN THE FIELD BY OR UNDER THE SUPERVISION OF A FLORIDA REGISTERED LAND SURVEYOR.
2. PRIOR TO THE SCHEDULING OF ANY UNDERGROUND UTILITY PRESSURE TESTS, CONTRACTOR SHALL HAVE OBTAINED ALL NECESSARY FIELD DATA REQUIRED FOR THE PRODUCTION OF RECORD DRAWINGS.
3. CONTRACTOR TO PROVIDE THE ENGINEER OF RECORD WITH REPRODUCIBLE AS-BUILT DRAWINGS SHOWING ALL IMPROVEMENT LOCATIONS AND ELEVATIONS AS REQUIRED BY TOWN OF LONGBOAT KEY. CONTRACTOR TO LEAVE EXPOSED ALL PIPE BENDS OF 45 OR GREATER, TEES, CROSSES, REDUCERS AND PRESSURE PIPING EVERY 200' (OR ALTERNATE LOT LINES, WHICHEVER IS CLOSER). AS AN ALTERNATE TO LEAVING EXPOSED PIPING AND FITTINGS, THE CONTRACTOR, AT HIS OPTION, MAY PLACE A VERTICAL LENGTH OF 3/4" MINIMUM P.V.C. OVER THE PIPING OR FITTINGS SO THAT THESE LOCATIONS MAY BE VERIFIED BY SURVEY CREWS.
4. ALL PROPOSED CONSTRUCTION IS TO MEET OR EXCEED LATEST APPLICABLE TOWN OF LONGBOAT KEY CONSTRUCTION STANDARDS AND TO CONFORM TO ENGINEERS SPECIFICATIONS. PROPOSED CONSTRUCTION IS TO BE PRIVATELY OWNED AND OPERATED.
5. THE CONTRACTOR IS TO COORDINATE THE LOCATION AND ELEVATION OF ALL F.P.L., G.T.E. AND IRRIGATION SERVICE SLEEVES WITH RESPECTIVE AGENCY PRIOR TO CONSTRUCTION.
6. THE CONTRACTOR IS TO COORDINATE THE LOCATION AND ELEVATION OF ALL UTILITY SERVICE CONNECTIONS WITH THE ARCHITECTURAL BUILDING PLANS PRIOR TO CONSTRUCTION.
7. THE CONTRACTOR IS TO ASSURE HIMSELF THAT ALL UNDERGROUND UTILITIES AND STORM SEWER IS CONSTRUCTED, TESTED AND OPERATIONAL PRIOR TO ANY ROADWAY CONSTRUCTION.
8. ALL PROPOSED ELECTRICAL AND COMMUNICATION SERVICES ARE TO BE LOCATED UNDERGROUND AS DIRECTED BY RESPECTIVE AGENCY.
9. WATERMAIN WHERE LOCATED UNDER PAVEMENT TO BE ENCASED IN CLASS 160, SDR-26 PVC OR TO BE C-900 PVC AT CONTRACTOR'S OPTION. WATER SERVICES WHERE LOCATED UNDER PAVEMENT TO BE ENCASED IN CLASS 160, SDR-26 PVC. (3' MIN.)
10. ALL UTILITIES SHOWN AS EXISTING ARE TO BE FIELD VERIFIED FOR LOCATION AND ELEVATION PRIOR TO CONSTRUCTION. CONTRACTOR TO NOTIFY "SUNSHINE" 48 HOURS MINIMUM PRIOR TO START OF CONSTRUCTION FOR POSSIBLE UTILITY LOCATIONS NOT SHOWN. (1-800-282-8881)
11. ALL BIDDERS ARE HEREBY ADVISED THAT ALL EXCAVATION ON THIS PROJECT MUST COMPLY WITH FLORIDA STATUTE 90-95 "TRENCH SAFETY ACT" AND THAT THE COSTS OF COMPLIANCE IS TO BE INCLUDED IN HIS BASE BID. THE BIDDER SHALL INDICATE ON THE BID FORM THE COST ASSOCIATED WITH COMPLIANCE.
12. ALL WATER AND SEWER MAINS TO BE CONSTRUCTED IN PHASE I. SERVICES TO BE CONSTRUCTED IN COMPLIANCE WITH PHASING PLAN.
13. ALL SEWER MAINS TO BE C 900. SEE TECHNICAL SPECIFICATIONS 502730-2, SECTION 2.3
14. WHERE WATER AND SEWER MAINS CROSS, A MINIMUM OF 18" VERTICAL CLEARANCE IS REQ'D. AND THE SEWER MAINS WILL BE ENCASED IN CONCRETE. (SEE WATER AND SEWER DETAILS); WHEN A WATER MAIN PARALLELS A SEWER MAIN, AT LEAST 10' SHALL BE MAINTAINED.
15. WATER SUPPLY TO BUILDINGS SHALL BE D.R. 18; LINE SHALL BE D.R. 18 BETWEEN DOMESTIC AND B.F.P., D.R. 14 BETWEEN PUMPHOUSE AND BUILDING SERVICES.
16. SEE SHEET 7 FOR JACK AND BORE CROSSING DETAIL.

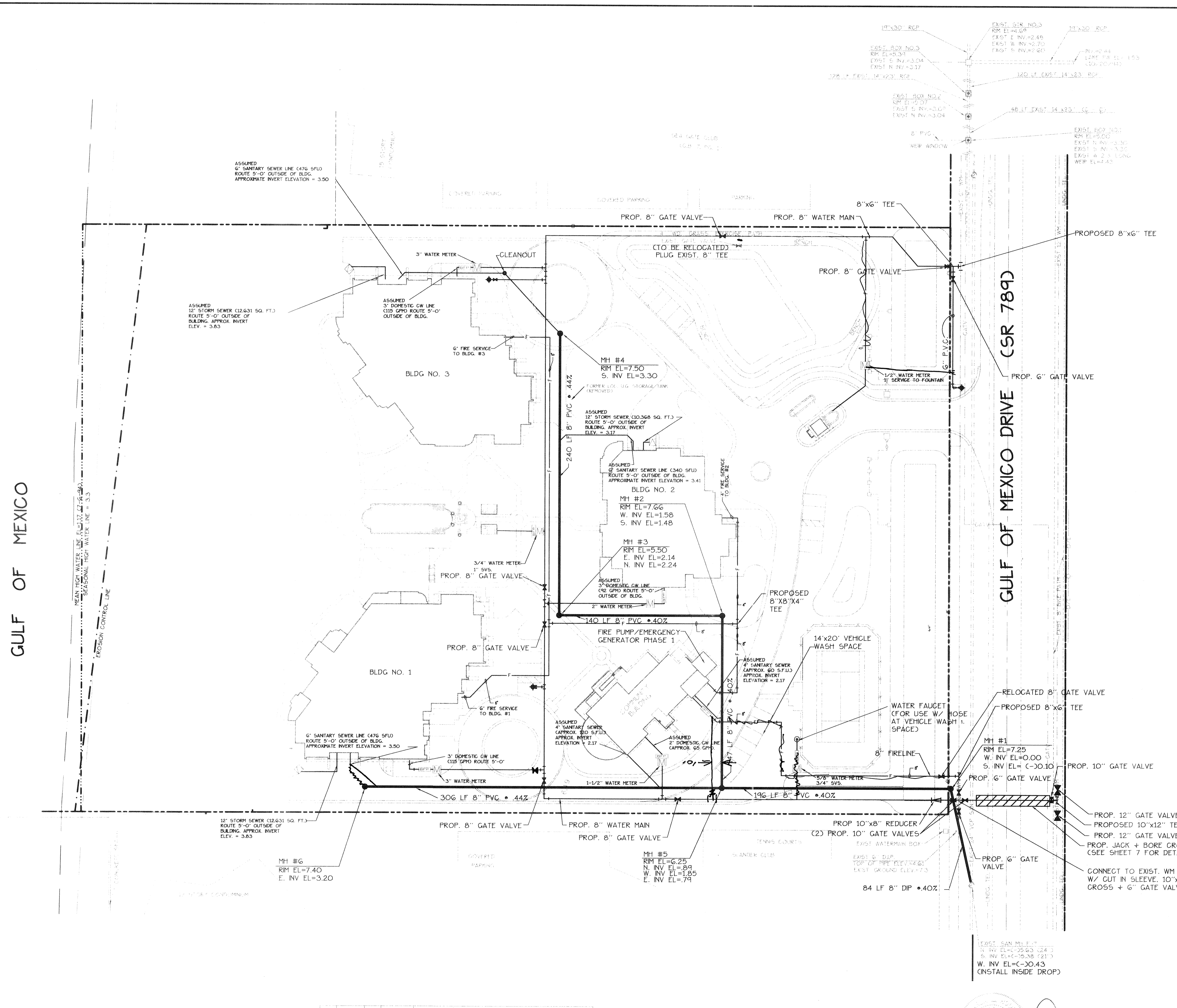

GULF OF MEXICO

GULF OF MEXICO DRIVE (CSR 789)

B **BISHOP & ASSOCIATES**
 Engineers - Surveyors - Planners
 AN EMPLOYEE OWNED COMPANY
 1101 6TH AVE. WEST, SUITE 108, BRADENTON FLORIDA 34205
 PHONE (941) 746-7446 - FAX (941) 746-7809

DATE	BY	DATE	DESCRIPTION
4-29-96	MMH	4-29-96	FIRELINE MODS. (NEW PUMP HOUSE - LOCATED IN COMMUNITY BLDG.)
4-29-96	MMH	4-29-96	MODIFICATIONS TO BE TO EXIST. GULF OF MEXICO DRIVE MANHOLE
7-21-95	MMH	7-21-95	SEPARATE WATER AND FIRE LINE / SWS RELOCATION / INCL. NOTE 11
8-1-95	MMH	8-1-95	ROOF WATER METER SIZES, LOCATIONS, NO. B.F.P.'S, S.W. LOC. ROUNDOFF, STORAGE TANK
10-20-95	MMH	10-20-95	UTILITIES DEPARTMENT REVISIONS (L.L.B.K.)
11-4-95	MMH	11-4-95	UTILITIES DEPARTMENT REVISIONS (L.L.B.K.)
1-6-95	MMH	1-6-95	MODIFIED NOTE 15, / ADDED GATE VALVES / ELIMINATE MANHOLE #A

PROJECT NO. **EGG-01**
 SHEET NO. **4**
 DATE: **AUG 15 1996**
 SCALE: **1" = 40'**

VIZCAYA at LONGBOAT KEY
ECOVENTURE LBK, LTD.
 SITE AND DEVELOPMENT WATER AND SEWER PLAN