

INVESTIGATE BEFORE YOU EXCAVATE
"CALL CANDY"
 1-800-282-8881
 TOLL FREE
 FL. STATUTE 653.851 (1979) REQUIRES MIN. OF 2 DAYS AND MAX. OF 5 DAYS NOTICE BEFORE YOU EXCAVATE.

LEGEND

EXISTING UTILITIES

- SA-1 SANITARY SEWER
- FM-1 FORCE MAIN
- SD-1 STORM DRAIN
- WM-1 WATER MAIN
- GA-1 GAS MAIN
- BE-1 BURIED CABLE TV
- BT-1 BURIED ELECTRIC
- BT-2 BURIED TELEPHONE

PROPOSED UTILITIES

- SAN SANITARY SEWER
- SD STORM DRAIN
- WM WATER MAIN
- FIRE FIRE MAIN
- S-21 PROP. STORM SEWER STRUCTURE
- MH.No.2 PROP. SANITARY SEWER MANHOLE

NOTE:
 ALL UTILITY SLEEVES ARE TO BE CONSTRUCTED 5' BEHIND THE PROP. CURB UNLESS NOTED OTHERWISE.

ALSO NOTIFY:

FP&L 953-7265
 TOWN OF LONGBOAT KEY 383-3721

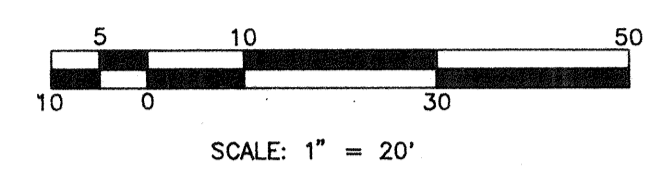

FOR CONTINUATION

SEE SHEET NO. 5

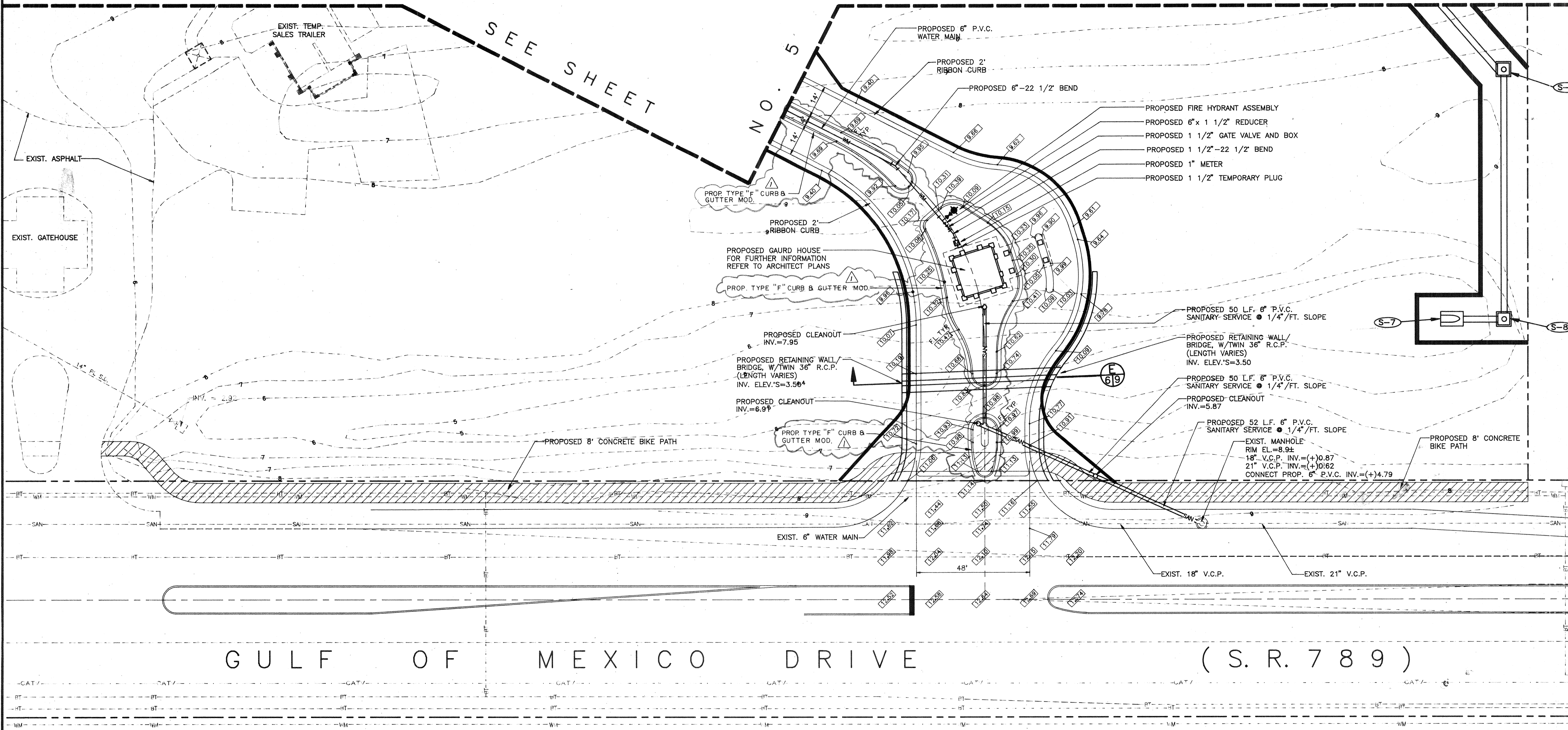

GULF OF MEXICO DRIVE (S.R. 789)

FIELD BOOK NO. _____
 PAGE _____
 Sec. -Twp.-Rng. _____

PILOT DATE: _____
 CAD FILE: _____
 P.O. #: _____

BISHOP & ASSOCIATES
 Consulting Engineers • Surveyors
 AN EMPLOYEE OWNED COMPANY
 78 SARASOTA CENTER BLVD. SARASOTA, FLORIDA 34240
 813/371-6362 • Fax 813/378-3215

REVISION	BY	DATE	Q.C.	DATE	DESCRIPTION
1	PSU	10-8-93	RCP	10-8-93	REV. CURB TYPE FROM RIBBON TO "F" MOD.

TASK	INITIALS	DATE
DESIGN	P.C.P.	4-19-93
DRAWN	P.S.N.	4-28-93
CHECKED	W.F.B.	
QUALITY C.K.		
HORIZ. SCALE:		1"=20'
VERT. SCALE:		

CLIENT/TITLE: **THE ST. JAMES ST. JAMES DEVELOPMENT COMPANY SOUTH, INC. DETAIL DRAINAGE AND UTILITY PLAN**

PROJECT NO: **ANS-10**
 SHEET NO: **6**

