

GULF OF MEXICO
 MEAN HIGH WATER LINE
 20 JANUARY 1972
 1.46' ABOVE M.S.L.

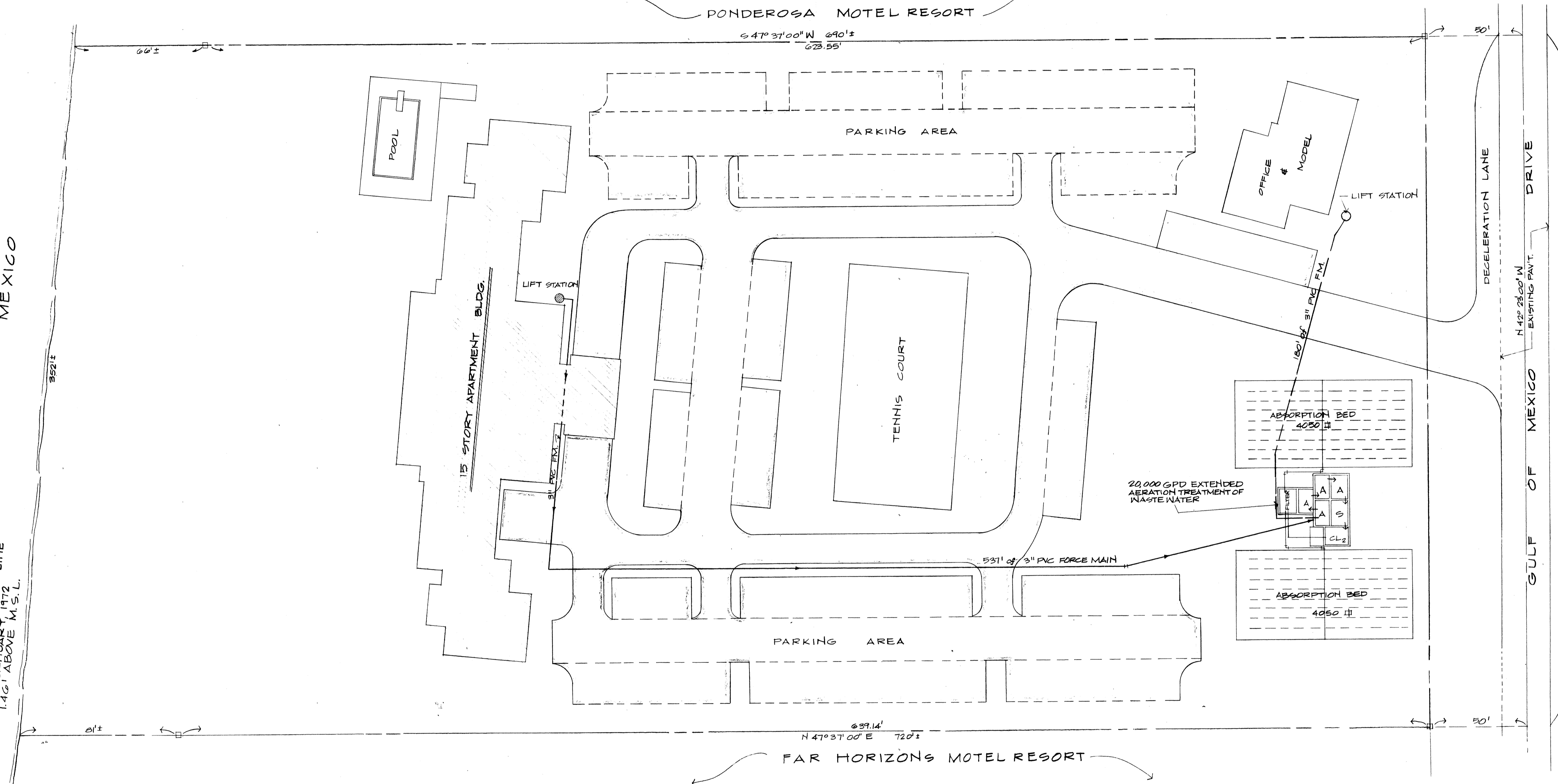

SITE PLAN
 SHOWING "AS BUILT" WASTEWATER COLLECTION SYSTEM

TOWN OF LONGBOAT KEY, FLORIDA		DESIGNED BY PROJECT ENGINEER	
SEA GATE CLUB		DATE:	
GULF OF MEXICO DRIVE SARASOTA, FLORIDA		DRAWN BY	
REVISION		CHECKED BY PROJECT NO.	
SHEET NUMBER		SCALE:	
73-A		BY	
REVISION		REVISION	
T.L.K. FILE NO.		L.T.R. DATE	
		DATE	