

2.5
6
15.0

LEGEND

WM	WM	EXIST. WATERMAIN
SD	SD	EXIST. STORM DRAIN
SN	SN	EXIST. SANITARY SEWER
GM	GM	EXIST. GASMAIN

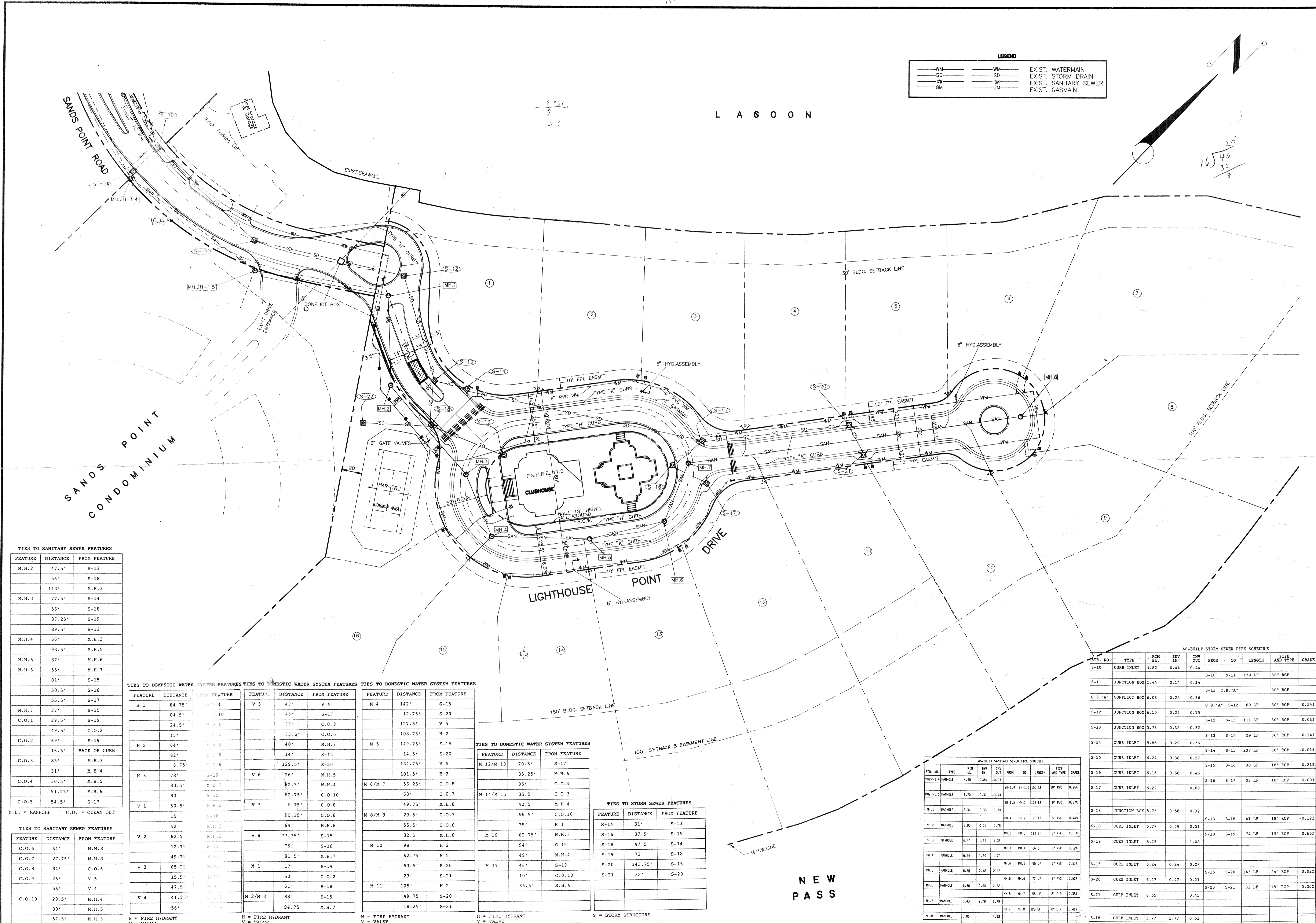

TIES TO SANITARY SEWER FEATURES

FEATURE	DISTANCE	FROM FEATURE
M.H.2	47.5'	S-13
	56'	S-18
	113'	M.H.3
M.H.3	77.5'	S-14
	56'	S-18
	37.25'	S-19
	89.5'	S-13
M.H.4	66'	M.H.3
	93.5'	M.H.5
M.H.5	87'	M.H.6
M.H.6	55'	M.H.7
	81'	S-15
	50.5'	S-16
	55.5'	S-17
M.H.7	27'	S-15
C.O.1	29.5'	S-19
	49.5'	C.O.2
C.O.2	69'	S-19
	16.5'	BACK OF CURB
C.O.3	85'	M.H.3
	31'	M.H.4
C.O.4	30.5'	M.H.5
	91.25'	M.H.6
C.O.5	54.5'	S-17

TIES TO DOMESTIC WATER SYSTEM FEATURES

FEATURE	DISTANCE	FROM FEATURE
H 1	84.75'	V 4
	84.5'	S-10
	24.5'	M.H.5
	15'	C.O.4
H 2	64'	M.H.8
	82'	C.O.6
	6.75'	S-15
H 3	78'	S-16
	83.5'	M.H.7
	80'	S-15
V 1	60.5'	M.H.2
	15'	S-18
	52'	M.H.3
V 2	62.5'	M.H.2
	12.75'	S-16
	49.75'	M.H.8
C.O.6	61'	M.H.8
C.O.7	27.75'	M.H.8
C.O.8	84'	C.O.6
C.O.9	26'	V 5
	56'	V 4
C.O.10	29.5'	M.H.4
	80'	M.H.5
	57.5'	M.H.3

TIES TO DOMESTIC WATER SYSTEM FEATURES

FEATURE	DISTANCE	FROM FEATURE
V 5	47'	V 4
	45'	S-17
	26'	C.O.9
	52.5'	C.O.5
V 6	26'	M.H.5
	14'	S-15
	129.5'	S-20
V 7	6.75'	C.O.8
	80.25'	C.O.6
	64'	M.H.8
V 8	77.75'	S-15
	76'	S-16
	81.5'	M.H.7
M 1	17'	S-14
	50'	C.O.2
	61'	S-18
M 2/M 3	88'	S-15
	94.75'	M.H.7

TIES TO DOMESTIC WATER SYSTEM FEATURES

FEATURE	DISTANCE	FROM FEATURE
M 4	142'	S-15
	12.75'	S-20
	127.5'	V 5
	108.75'	H 2
M 5	149.25'	S-15
	14.5'	S-20
	134.75'	V 5
	101.5'	H 2
M 6/M 7	56.25'	C.O.8
	63'	C.O.7
	49.75'	M.H.8
M 8/M 9	29.5'	C.O.7
	55.5'	C.O.6
	32.5'	M.H.8
M 10	98'	H 2
	62.75'	M 5
	53.5'	S-20
	23'	S-21
M 11	105'	H 2
	49.75'	S-20
	18.25'	S-21

TIES TO DOMESTIC WATER SYSTEM FEATURES

FEATURE	DISTANCE	FROM FEATURE
M 12/M 13	70.5'	S-17
	35.25'	M.H.6
	95'	C.O.4
M 14/M 15	35.5'	C.O.3
	42.5'	M.H.4
	66.5'	C.O.10
	75'	H 1
M 16	62.75'	M.H.3
	94'	S-19
	49'	M.H.4
M 17	46'	S-19
	10'	C.O.10
	35.5'	M.H.4

TIES TO STORM SEWER FEATURES

FEATURE	DISTANCE	FROM FEATURE
S-14	31'	S-13
S-16	37.5'	S-15
S-18	47.5'	S-14
S-19	73'	S-18
S-20	143.75'	S-15
S-21	32'	S-20

TIES TO SANITARY SEWER FEATURES

FEATURE	DISTANCE	FROM FEATURE
C.O.6	61'	M.H.8
C.O.7	27.75'	M.H.8
C.O.8	84'	C.O.6
C.O.9	26'	V 5
	56'	V 4
C.O.10	29.5'	M.H.4
	80'	M.H.5
	57.5'	M.H.3

M.H. = MANHOLE C.O. = CLEAN OUT
H = FIRE HYDRANT V = VALVE
M = METER M/M = HALF WAY BETWEEN TWO ADJACENT METERS

H = FIRE HYDRANT V = VALVE
M = METER M/M = HALF WAY BETWEEN TWO ADJACENT METERS

H = FIRE HYDRANT V = VALVE
M = METER M/M = HALF WAY BETWEEN TWO ADJACENT METERS

H = FIRE HYDRANT V = VALVE
M = METER M/M = HALF WAY BETWEEN TWO ADJACENT METERS

H = FIRE HYDRANT V = VALVE
M = METER M/M = HALF WAY BETWEEN TWO ADJACENT METERS

S = STORM STRUCTURE

AS-BUILT STORM SEWER PIPE SCHEDULE

STR. NO.	TYPE	RIM EL.	INV IN	INV OUT	FROM - TO	LENGTH	SIZE AND TYPE	GRADE
MCH-1.4	MANHOLE	4.48	-0.84	-0.93				
MCH-1.5	MANHOLE	5.70	-0.37	-0.44	MH-1.4	26-1.5	153 LF 18" PVC	0.26%
MH-1	MANHOLE	6.34	0.38	0.38			8" PVC	0.57%
MH-2	MANHOLE	5.86	0.78	0.78	MH-1	90 LF	8" PVC	0.44%
MH-3	MANHOLE	6.44	1.36	1.36	MH-2	113 LF	8" PVC	0.51%
MH-4	MANHOLE	6.76	1.70	1.70	MH-3	66 LF	8" PVC	0.52%
MH-5	MANHOLE	6.86	2.18	2.18	MH-4	95 LF	8" PVC	0.51%
MH-6	MANHOLE	6.56	2.58	2.58	MH-5	77 LF	8" PVC	0.52%
MH-7	MANHOLE	6.43	2.79	2.79	MH-6	56 LF	8" DIP	0.38%
MH-8	MANHOLE	6.85	4.13		MH-7	328 LF	8" DIP	0.41%

AS-BUILT SANITARY SEWER PIPE SCHEDULE

STR. NO.	TYPE	RIM EL.	INV IN	INV OUT	FROM - TO	LENGTH	SIZE AND TYPE	GRADE
S-10	CURB INLET	4.82	0.44	0.44				
S-11	JUNCTION BOX	5.44	0.14	0.14	S-10	S-11	139 LF 30" RCP	
C.B."A"	CONFLICT BOX	6.08	-0.22	-0.36				
C.B."A"	CONFLICT BOX	6.08	-0.22	-0.36	C.B."A"	S-32	69 LF 30" RCP	0.54%
S-12	JUNCTION BOX	6.10	0.29	0.15	S-12	S-13	111 LF 30" RCP	0.03%
S-13	JUNCTION BOX	5.73	0.32	0.32	S-13	S-14	29 LF 30" RCP	0.14%
S-14	CURB INLET	5.85	0.29	0.36				
S-15	CURB INLET	6.24	0.38	0.27	S-14	S-15	237 LF 30" RCP	-0.01%
S-16	CURB INLET	6.16	0.68	0.46	S-15	S-16	38 LF 18" RCP	0.21%
S-17	CURB INLET	6.22		0.68	S-16	S-17	38 LF 18" RCP	0.00%
S-18	CURB INLET	5.73	0.56	0.32	S-18	S-18	41 LF 18" RCP	-0.12%
S-19	CURB INLET	6.25		1.08	S-18	S-19	74 LF 15" RCP	0.66%
S-20	CURB INLET	6.47	0.47	0.21	S-20	S-21	32 LF 18" RCP	-0.06%
S-21	CURB INLET	6.55		0.45				
S-22	YARD DRAIN	3.68		1.48	S-18	S-22	68 LF 12" PVC	-0.43%

TOWN OF LONGBOAT KEY, FLORIDA
LIGHTHOUSE POINT - RECORD DRAWING

DESIGNED BY: PROJECT ENGINEER
 DATE: 12-11-88
 DRAWN BY: S.B.C.
 CHECKED BY: S.B.C.
 PH. (813) 371-6362

78 SARASOTA CENTER BLVD. SARASOTA, FLORIDA 34240
 BISHOP & ASSOCIATES, INC. CONSULTING ENGINEERS & SURVEYORS

SHEET NUMBER: LVDC0015A3
 1 of 1

REVISION: VOID