

LEGEND

| | | |
|----|----|-----------------------|
| WM | WM | EXIST. WATERMAIN |
| SD | SD | EXIST. STORM DRAIN |
| SW | SW | EXIST. SANITARY SEWER |
| GM | GM | EXIST. GASMAIN |

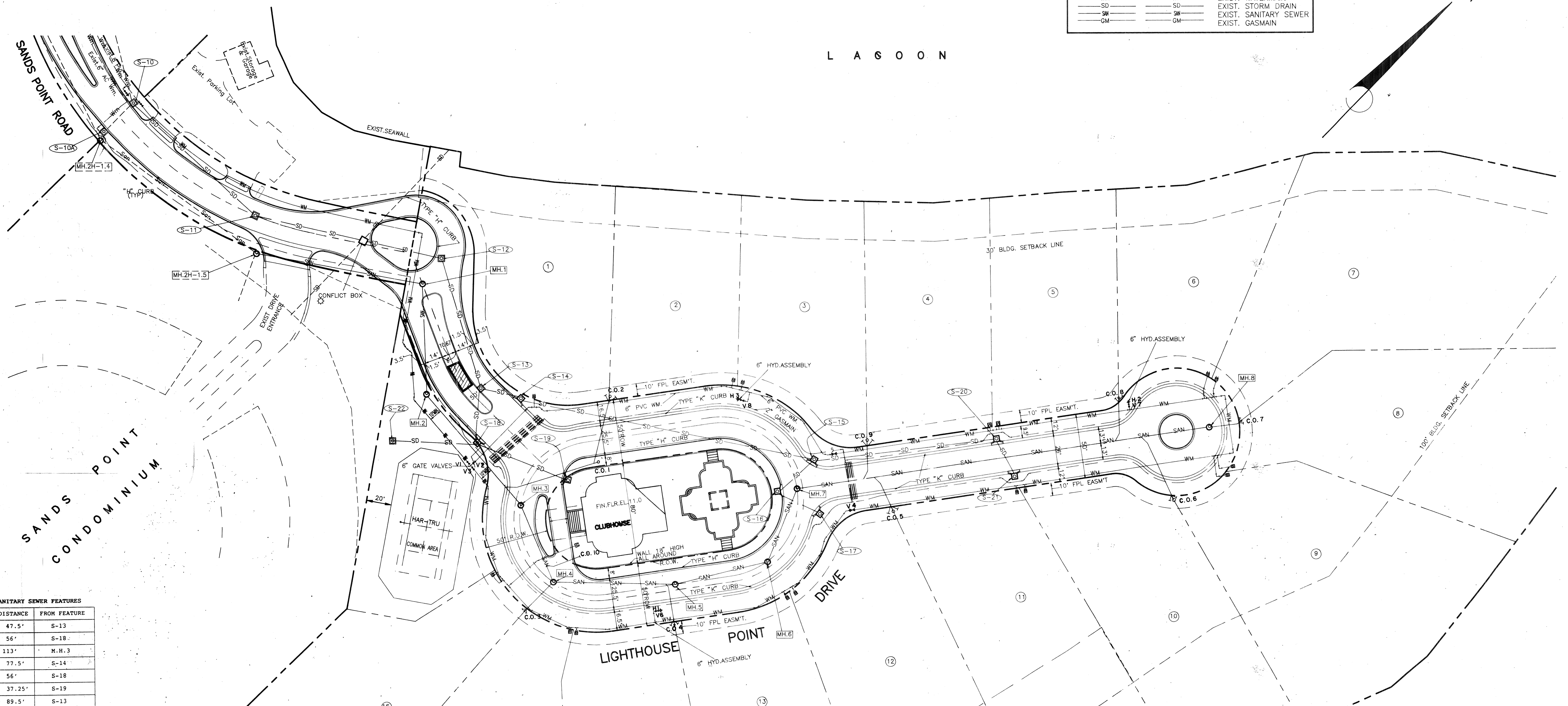

TIES TO SANITARY SEWER FEATURES

| FEATURE | DISTANCE | FROM FEATURE |
|---------|----------|--------------|
| M.H.2 | 47.5' | S-13 |
| | 56' | S-18 |
| | 113' | M.H.3 |
| M.H.3 | 77.5' | S-14 |
| | 56' | S-18 |
| | 37.25' | S-19 |
| | 89.5' | S-13 |
| M.H.4 | 66' | M.H.3 |
| | 93.5' | M.H.5 |
| M.H.5 | 87' | M.H.6 |
| M.H.6 | 55' | M.H.7 |
| | 81' | S-15 |
| | 50.5' | S-16 |
| | 55.5' | S-17 |
| M.H.7 | 27' | S-15 |
| C.O.1 | 29.5' | S-19 |
| | 49.5' | C.O.2 |
| C.O.2 | 69' | S-19 |
| | 16.5' | BACK OF CURB |
| C.O.3 | 85' | M.H.3 |
| | 31' | M.H.4 |
| C.O.4 | 30.5' | M.H.5 |
| | 91.25' | M.H.6 |
| C.O.5 | 54.5' | S-17 |

M.H. = MANHOLE C.O. = CLEAN OUT

TIES TO SANITARY SEWER FEATURES

| FEATURE | DISTANCE | FROM FEATURE |
|---------|----------|--------------|
| C.O.6 | 61' | M.H.8 |
| C.O.7 | 27.75' | M.H.8 |
| C.O.8 | 84' | C.O.6 |
| C.O.9 | 26' | V 5 |
| | 56' | V 4 |
| C.O.10 | 29.5' | M.H.4 |
| | 80' | M.H.5 |
| | 57.5' | M.H.3 |

M.H. = MANHOLE C.O. = CLEAN OUT

TIES TO DOMESTIC WATER SYSTEM FEATURES

| FEATURE | DISTANCE | FROM FEATURE |
|---------|----------|--------------|
| H 1 | 84.75' | M.H.4 |
| | 84.5' | C.O.10 |
| | 24.5' | M.H.5 |
| | 15' | C.O.4 |
| H 2 | 64' | M.H.8 |
| | 82' | C.O.6 |
| | 6.75' | C.O.8 |
| H 3 | 78' | S-16 |
| | 83.5' | M.H.7 |
| | 80' | S-15 |
| V 1 | 60.5' | M.H.2 |
| | 15' | S-18 |
| | 52' | M.H.3 |
| V 2 | 62.5' | M.H.2 |
| | 12.75' | S-18 |
| | 49.75' | M.H.3 |
| V 3 | 65.25' | M.H.2 |
| | 15.5' | S-18 |
| | 47.5' | M.H.3 |
| V 4 | 41.25' | C.O.5 |
| | 56' | C.O.9 |

H = FIRE HYDRANT V = VALVE M = METER M/M = HALF WAY BETWEEN TWO ADJACENT METERS

TIES TO DOMESTIC WATER SYSTEM FEATURES

| FEATURE | DISTANCE | FROM FEATURE |
|---------|----------|--------------|
| V 5 | 47' | V 4 |
| | 45' | S-17 |
| | 26' | C.O.9 |
| | 62.5' | C.O.5 |
| | 40' | M.H.7 |
| H 2 | 64' | S-15 |
| | 14.5' | S-20 |
| | 134.75' | V 5 |
| H 3 | 101.5' | H 2 |
| | 56.25' | C.O.8 |
| | 63' | C.O.7 |
| | 82.75' | C.O.10 |
| V 7 | 6.75' | C.O.8 |
| | 80.25' | C.O.6 |
| | 64' | M.H.8 |
| V 8 | 77.75' | S-15 |
| | 76' | S-16 |
| | 81.5' | M.H.7 |
| M 1 | 17' | S-14 |
| | 50' | C.O.2 |
| | 61' | S-18 |
| M 2/M 3 | 88' | S-15 |
| | 94.75' | M.H.7 |

H = FIRE HYDRANT V = VALVE M = METER M/M = HALF WAY BETWEEN TWO ADJACENT METERS

TIES TO DOMESTIC WATER SYSTEM FEATURES

| FEATURE | DISTANCE | FROM FEATURE |
|---------|----------|--------------|
| M 4 | 142' | S-15 |
| | 12.75' | S-20 |
| | 127.5' | V 5 |
| | 108.75' | H 2 |
| M 5 | 149.25' | S-15 |
| | 14.5' | S-20 |
| | 134.75' | V 5 |
| M 6/M 7 | 101.5' | H 2 |
| | 56.25' | C.O.8 |
| | 63' | C.O.7 |
| | 49.75' | M.H.8 |
| M 8/M 9 | 29.5' | C.O.7 |
| | 55.5' | C.O.6 |
| | 32.5' | M.H.8 |
| M 10 | 98' | H 2 |
| | 62.75' | M 5 |
| | 53.5' | S-20 |
| | 23' | S-21 |
| M 11 | 105' | H 2 |
| | 49.75' | S-20 |
| | 18.25' | S-21 |

H = FIRE HYDRANT V = VALVE M = METER M/M = HALF WAY BETWEEN TWO ADJACENT METERS

TIES TO DOMESTIC WATER SYSTEM FEATURES

| FEATURE | DISTANCE | FROM FEATURE |
|-----------|----------|--------------|
| M 12/M 13 | 70.5' | S-17 |
| | 35.25' | M.H.6 |
| | 95' | C.O.4 |
| M 14/M 15 | 35.5' | C.O.3 |
| | 42.5' | M.H.4 |
| | 66.5' | C.O.10 |
| | 75' | H 1 |
| M 16 | 62.75' | M.H.3 |
| | 94' | S-19 |
| | 49' | M.H.4 |
| M 17 | 46' | S-19 |
| | 10' | C.O.10 |
| | 35.5' | M.H.4 |

H = FIRE HYDRANT V = VALVE M = METER M/M = HALF WAY BETWEEN TWO ADJACENT METERS

TIES TO STORM SEWER FEATURES

| FEATURE | DISTANCE | FROM FEATURE |
|---------|----------|--------------|
| S-14 | 31' | S-13 |
| S-16 | 37.5' | S-15 |
| S-18 | 47.5' | S-14 |
| S-19 | 73' | S-18 |
| S-20 | 143.75' | S-15 |
| S-21 | 32' | S-20 |

S = STORM STRUCTURE

AS-BUILT STORM SEWER PIPE SCHEDULE

| STR. NO. | TYPE | RIM EL. | INV. IN | INV. OUT | FROM - TO | LENGTH | SIZE AND TYPE | GRADE |
|----------|--------------|---------|---------|----------|--------------|--------|---------------|--------|
| S-10 | CURB INLET | 4.82 | 0.44 | 0.44 | S-10 S-11 | 139 LF | 30" RCP | -0.22% |
| S-11 | JUNCTION BOX | 5.44 | 0.14 | 0.14 | S-11 C.B."A" | 74 LF | 30" RCP | -0.64% |
| C.B."A" | CONFLICT BOX | 6.08 | -0.33 | 0.33 | C.B."A" S-12 | 69 LF | 30" RCP | 0.70% |
| S-12 | JUNCTION BOX | 6.10 | 0.29 | 0.15 | S-12 S-13 | 111 LF | 30" RCP | -0.03% |
| S-13 | JUNCTION BOX | 5.73 | 0.32 | 0.32 | S-13 S-14 | 29 LF | 30" RCP | -0.14% |
| S-14 | CURB INLET | 5.85 | 0.29 | 0.36 | S-14 S-15 | 237 LF | 30" RCP | -0.01% |
| S-15 | CURB INLET | 6.24 | 0.38 | 0.27 | S-15 S-16 | 38 LF | 18" RCP | 0.21% |
| S-16 | CURB INLET | 6.16 | 0.68 | 0.46 | S-16 S-17 | 38 LF | 18" RCP | 0.00% |
| S-17 | CURB INLET | 6.22 | | 0.66 | | | | |
| S-18 | JUNCTION BOX | 5.73 | 0.56 | 0.32 | S-18 S-19 | 41 LF | 18" RCP | -0.12% |
| S-19 | CURB INLET | 5.77 | 0.59 | 0.51 | S-19 S-20 | 74 LF | 15" RCP | 0.66% |
| S-20 | CURB INLET | 6.24 | 0.24 | 0.27 | S-20 S-21 | 143 LF | 24" RCP | -0.02% |
| S-21 | CURB INLET | 6.47 | 0.47 | 0.21 | S-21 S-22 | 32 LF | 18" RCP | -0.06% |
| S-22 | YARD DRAIN | 3.68 | | 1.48 | | | | |

AS-BUILT SANITARY SEWER PIPE SCHEDULE

| STR. NO. | TYPE | RIM EL. | INV. IN | INV. OUT | FROM - TO | LENGTH | SIZE AND TYPE | GRADE |
|----------|---------|---------|---------|----------|---------------|--------|---------------|-------|
| M/H-1.4 | MANHOLE | 4.48 | -0.84 | -0.93 | ZN-1.4 ZN-1.5 | 133 LF | 10" PVC | 0.76% |
| M/H-1.5 | MANHOLE | 5.70 | -0.37 | -0.41 | ZN-1.5 M/H-1 | 132 LF | 8" PVC | 0.57% |
| M/H-1 | MANHOLE | 6.31 | 0.38 | 0.30 | M/H-1 M/H-2 | 90 LF | 8" PVC | 0.45% |
| M/H-2 | MANHOLE | 5.86 | 0.78 | 0.76 | M/H-2 M/H-3 | 113 LF | 8" PVC | 0.51% |
| M/H-3 | MANHOLE | 6.41 | 1.36 | 1.36 | M/H-3 M/H-4 | 66 LF | 8" PVC | 0.51% |
| M/H-4 | MANHOLE | 6.76 | 1.70 | 1.70 | M/H-4 M/H-5 | 95 LF | 8" PVC | 0.51% |
| M/H-5 | MANHOLE | 6.86 | 2.18 | 2.18 | M/H-5 M/H-6 | 77 LF | 8" PVC | 0.52% |
| M/H-6 | MANHOLE | 6.60 | 2.58 | 2.58 | M/H-6 M/H-7 | 56 LF | 8" DTP | 0.38% |
| M/H-7 | MANHOLE | 6.23 | 2.79 | 2.79 | M/H-7 M/H-8 | 128 LF | 8" DTP | 0.41% |
| M/H-8 | MANHOLE | 6.85 | | 4.13 | | | | |

TOWN OF LONGBOAT KEY, FLORIDA
LIGHTHOUSE POINT
RECORD DRAWING
 ENGINEER: BISHOP & ASSOCIATES, INC. CONSULTING ENGINEERS & SURVEYORS 78 SARASOTA CENTER BLVD. SARASOTA, FLORIDA 34240
 PROJECT ENGINEER: WILLIAM F. BISHOP
 DESIGNED BY: S.R.
 DATE: 12-21-89
 CHECKED BY: PROJECT NO. LVDC-0015
 R.W.C.
 SCALE: 1" = 40'
 DRAWN BY: R.W.C.
 PH. (813) 371-6362
 SHEET NUMBER LVDC0015AE
 1 of 1
 T.L.K. FILE NO.