

NOTE: THIS PLAN IS FOR STORMWATER ONLY

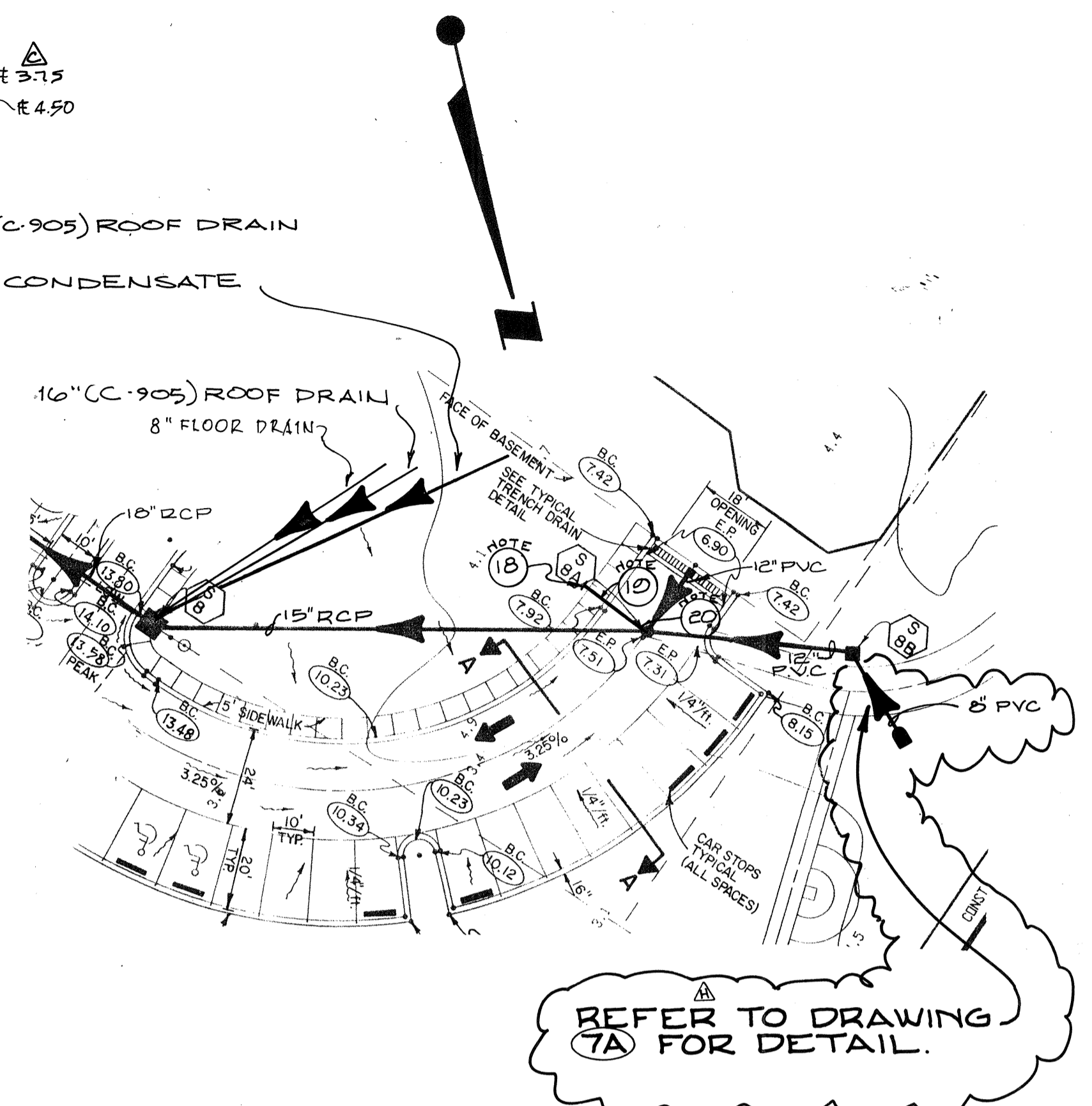

REFER TO DRAWING 7A FOR DETAIL.

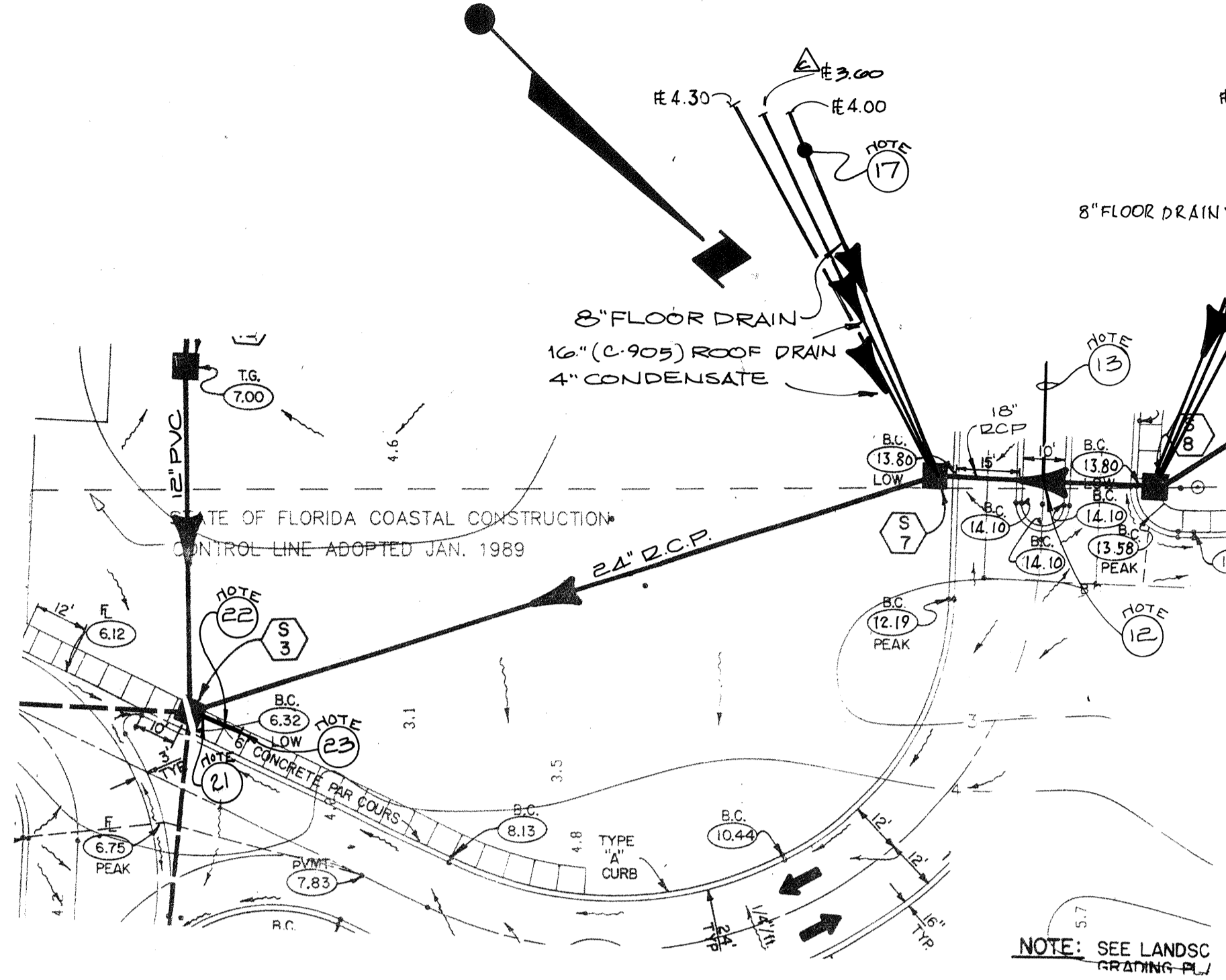
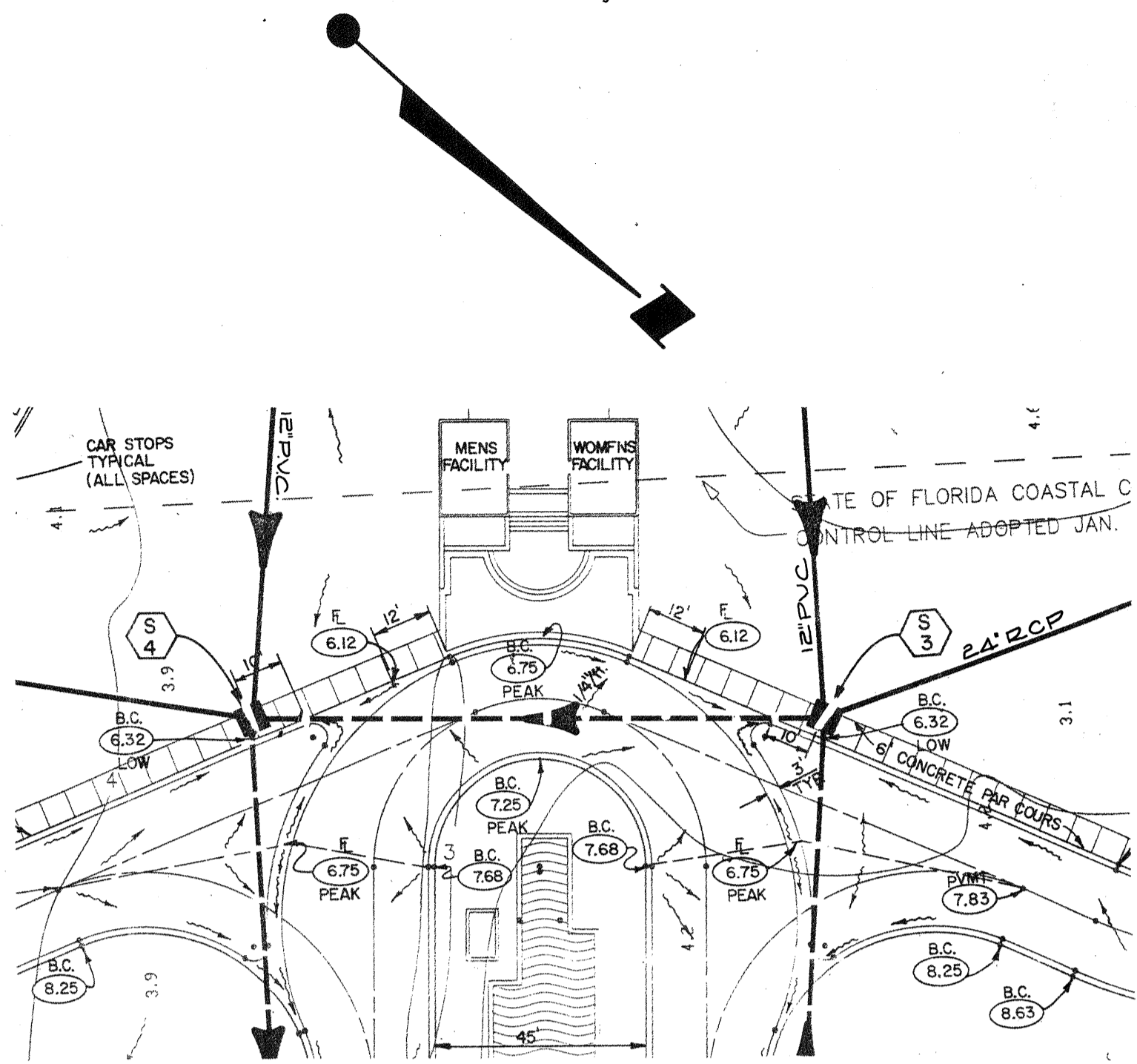
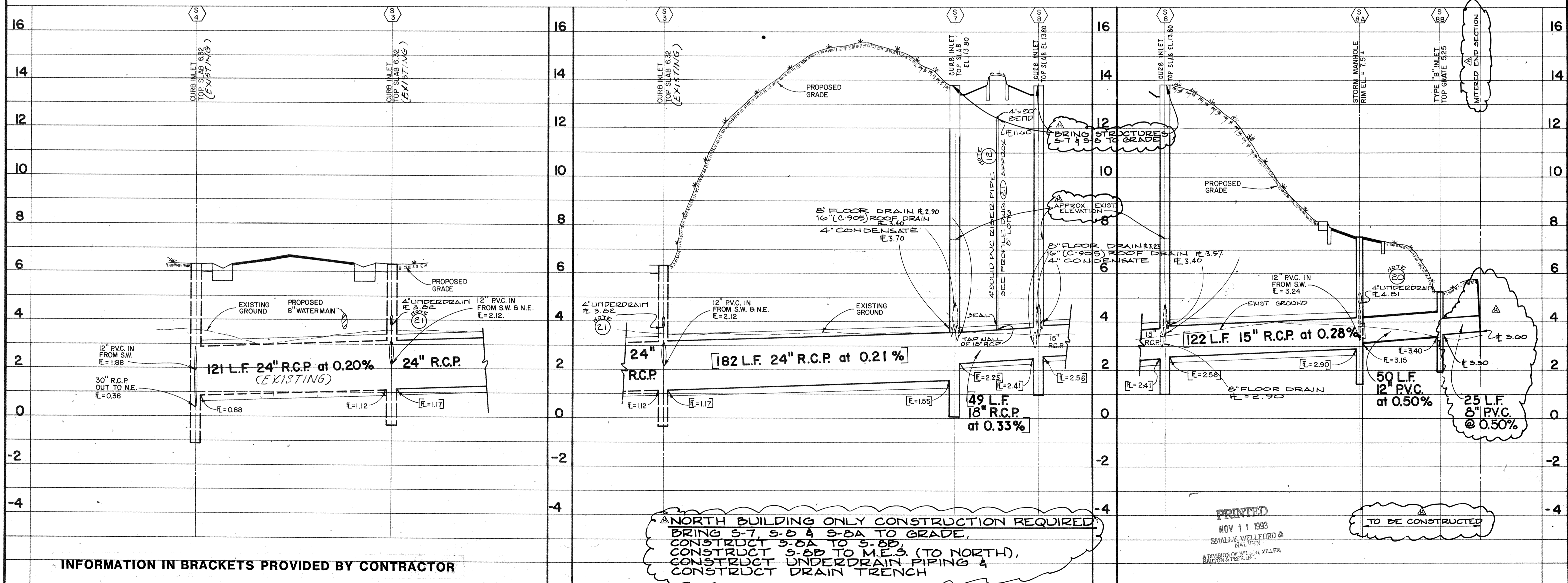

**▲ NORTH BUILDING ONLY CONSTRUCTION REQUIRED:**  
 BRING 5-7, 5-8 & 5-8A TO GRADE,  
 CONSTRUCT 5-8A TO 5-8B,  
 CONSTRUCT 5-8B TO M.E.S. (TO NORTH),  
 CONSTRUCT UNDERDRAIN PIPING &  
 CONSTRUCT DRAIN TRENCH

PRINTED  
 NOV 11 1993  
 SMALLY, WELLFORD & NALVEN  
 A DIVISION OF WELLS, MILLER  
 BARTON & PERK, INC.

TO BE CONSTRUCTED

INFORMATION IN BRACKETS PROVIDED BY CONTRACTOR

DATE: 7/90	DESIGNED BY: J.M.B.	SCALE: HORIZ. 1"=30'	VERT. 1"=2'
CHECKED BY: R.B.K.	DRAWN BY: W.W.J.	PROJECT NO: 2891	FL. CERT. # 33765
REVISION	BY	DATE	DESCRIPTION
1	W.W.J.	7/90	REVISED PER COMMENTS FROM CLIENT
2	R.B.K.	8/90	REVISED PER COMMENTS FROM CLIENT
3	R.B.K.	12/90	REVISED PER COMMENTS FROM CLIENT

FOR: YALE PROPERTIES  
**L'AMBIANCE**  
**STORM WATER PLAN & PROFILE**  
 SMALLY, WELLFORD & NALVEN, INC.  
 CONSULTING ENGINEERS & SURVEYORS  
 133 SOUTH MCINTOSH RD.  
 SARASOTA, FLA. 33582

DRAWING NUMBER: **5**

INDEX NO. 6-2591-010