

GULF OF MEXICO

MEAN HIGH WATER LINE
SEPT 25, 1972
1.46' ABOVE M.S.L.

CONC. PIER

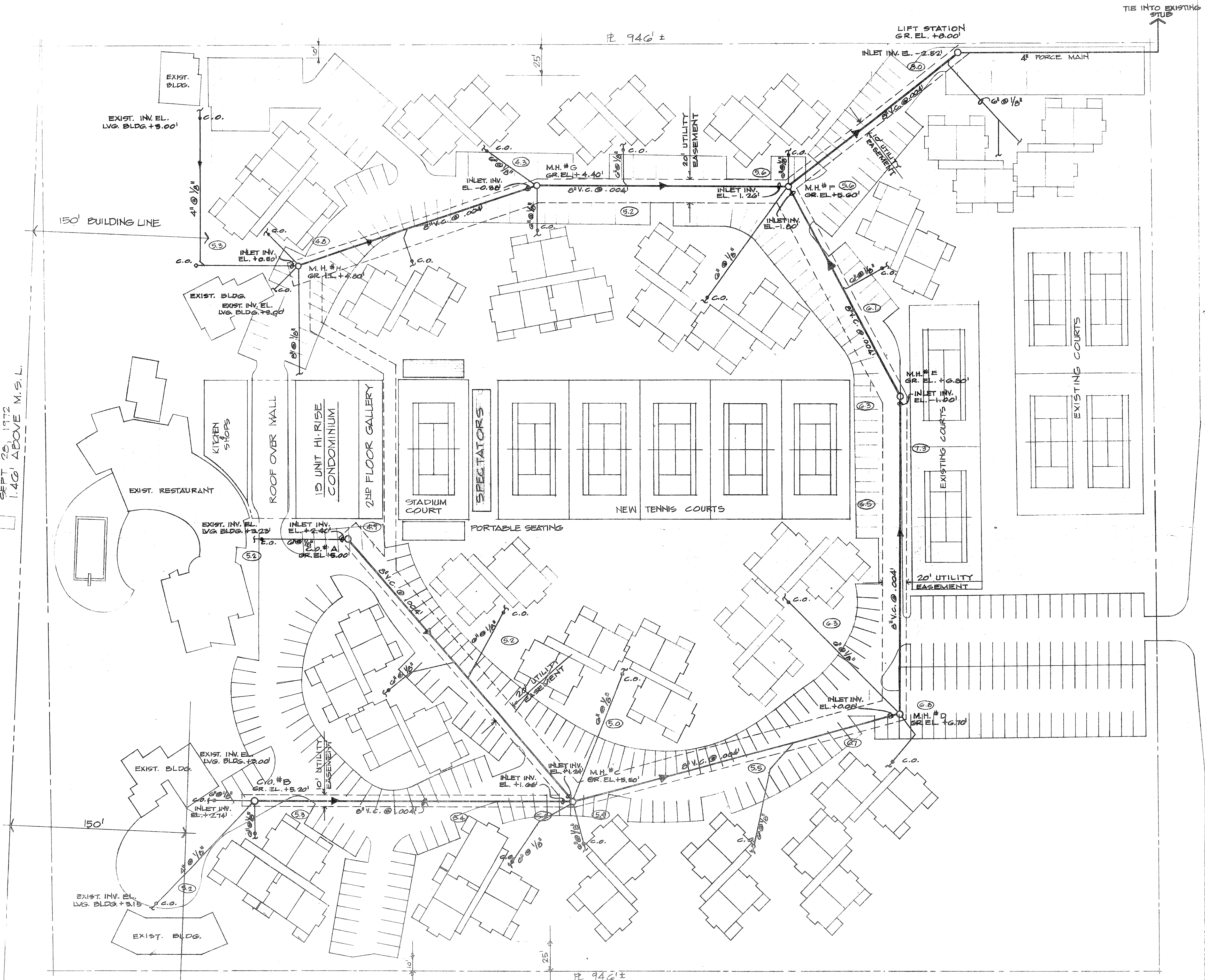

JOHN RINGLING PARKWAY (STATE ROAD 789)

SITE PLAN
SHOWING "AS BUILT" WASTEWATER COLLECTION SYSTEM

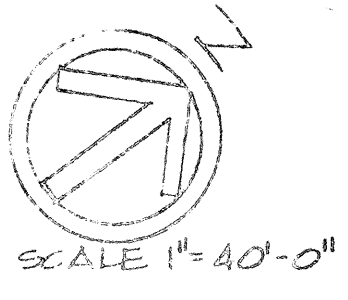

- LEGEND
- M.H. SANITARY MANHOLE
 - HYD. FIRE HYDRANT
 - C.O. CLEAN OUT & GRADE
 - F.G.E. FINAL GRADE ELEV.

PROJECT ENGINEER	DESIGNED BY	DATE:	SCALE:	BY	REVISION	LTR.	DATE
LIC. DR. 117 43346, INC.	PROJECT NO.	CHECKED BY	DRAWN BY				
1628 N. FEDERAL HWY.							
PL. LANGRISH & P.							
FLA. REG. NO. 4700							
FILE # 6217							

WINGBOAT KEY, FLORIDA
CLUB & TENNIS CLUB
SARASOTA, FLORIDA