

GULF OF MEXICO DRIVE

EXIST. 10" F.M. 15" W

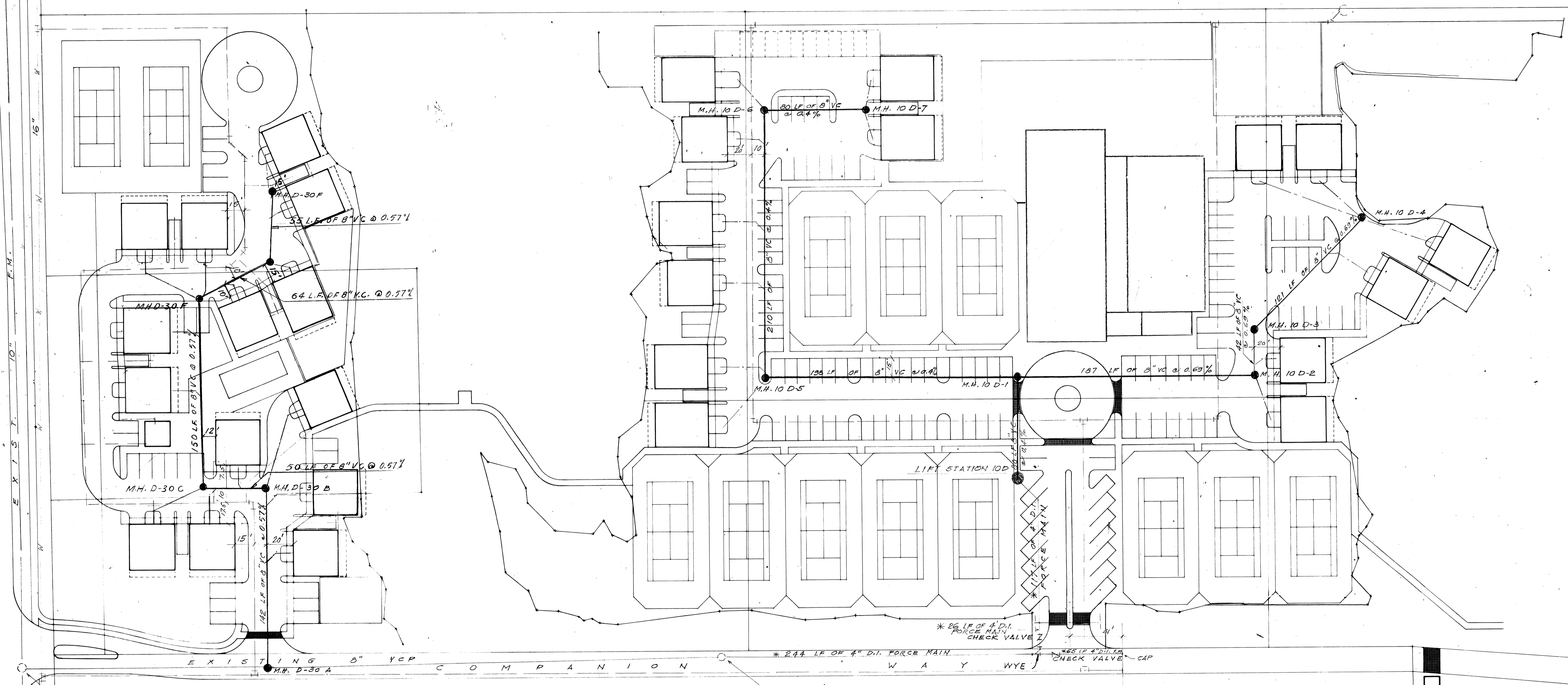
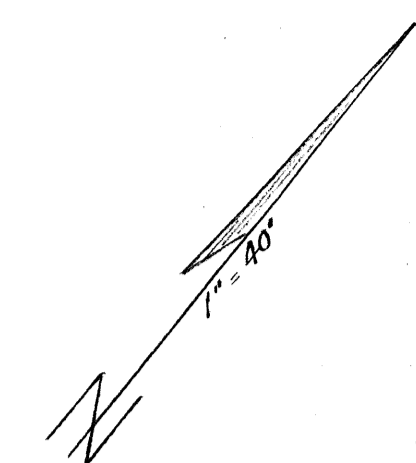

EXIST. M.H. D-30  
RIM EL. = 5.7  
F.L. = 2.94

EXIST. M.H. D-37  
RIM. EL. = +3.0  
F.L. = -0.70

\* NOTE:  
WRAP ALL IRON PIPES AND FITTINGS IN 3 MIL  
POLYETHYLENE IN ACCORDANCE WITH ANS I A 21.5  
PHASE IV PHASE V (N.I.C.)

- LEGEND**
- S — SEWER LINE
  - MANHOLE
  - L — LIFT STATION
  - W — WATER LINE
  - U — UNIT LATERALS

SANITARY SEWER & LIFT STATION LAYOUT

CEDARS EAST  
HUNT BUILDING CORPORATION · EDWARD J. SEIBERT AIA · ARCHITECT & PLANNER PA · A. L. CONYERS CONSULTING ENGINEER PE  
20 NOV 89  
20 OCT  
10.8