

DESIGNED	M.S.D.	DATE	9-16-75
DRAWN	MIKE	JOB NO.	322
CHECKED	M.S.D.	SCALE	1"=40'
APPROVED	D.C.Z.	SHEET	1 OF 3
REVISED			
1.	1-12-76	"AS-BUILT"	
2.			
3.			
4.			

ROBERTS & ZOLLER, INC.
 CONSULTING ENGINEERS
 ENGINEERING, SURVEYING, PLANNING
 P.O. BOX 12
 BRADENTON, FLORIDA 33506



FOR
BUCCANEER INN
 IN
 SEC. 23, TWP. 35 S., RGE. 16 E.
 MANATEE COUNTY, FLORIDA

SEWAGE SYSTEM TIE-IN TO
 MANATEE COUNTY UTILITY SYSTEM
"AS-BUILT"

REVISED: 10/6/75
 TIE-IN LOCATION

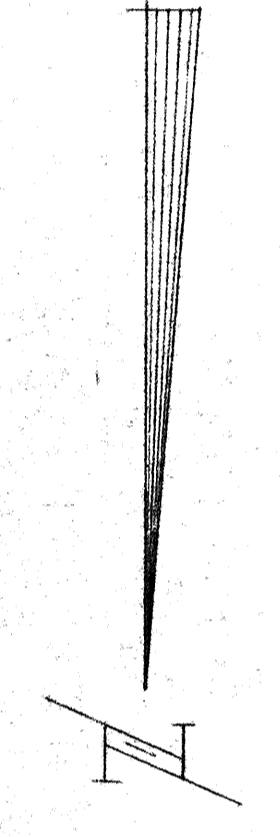

- LEGEND**
- ORIGINAL GROUND ELEVATION
 - EXISTING CONCRETE
 - EXISTING SHELL DRIVE & PARKING
 - EXISTING SEPTIC TANKS
 - PROPOSED CONSTRUCTION
 - EXISTING CONSTRUCTION

- GENERAL NOTES**
1. ELEVATIONS BASED ON U. S. & G. S. 1929 SURVEY DATUM.
 2. BUILDING LAYOUT DATA TAKEN FROM SURVEY DRAWING PREPARED BY "CORBA & HEBB", PROFESSIONAL LAND SURVEYORS.
 3. SEPTIC TANKS TO BE PUMPED OUT AND DISCONNECTED BY A LICENSED DEALER, HOLES KNOCKED OUT IN BOTTOM WALLS AND FILLED WITH ACCEPTABLE FILL MATERIAL.
 4. UPON COMPLETION OF CONSTRUCTION ALL WORK SHALL BE INSPECTED BY: CITY OF LONGBOAT KEY AND ENGINEER OF RECORD.
 5. UPON COMPLETION OF CONSTRUCTION THE CONTRACTOR SHALL FURNISH AS-BUILT PLANS TO THE OWNER, ENGINEER, AND THE CITY OF LONGBOAT KEY.
 6. PRIOR TO CONSTRUCTION, THE CONTRACTOR SHALL FAMILIARIZE HIMSELF WITH THE CITY OF LONGBOAT KEY AND MANATEE COUNTY HEALTH DEPARTMENT APPROVAL CONDITIONS AND REQUIREMENTS AND PROCEED IN ACCORDANCE WITH SAID APPROVALS.
 7. REFER TO "CONSTRUCTION DETAILS" (SHEET 3 OF 3) FOR BUILDING SERVICE CONNECTION.

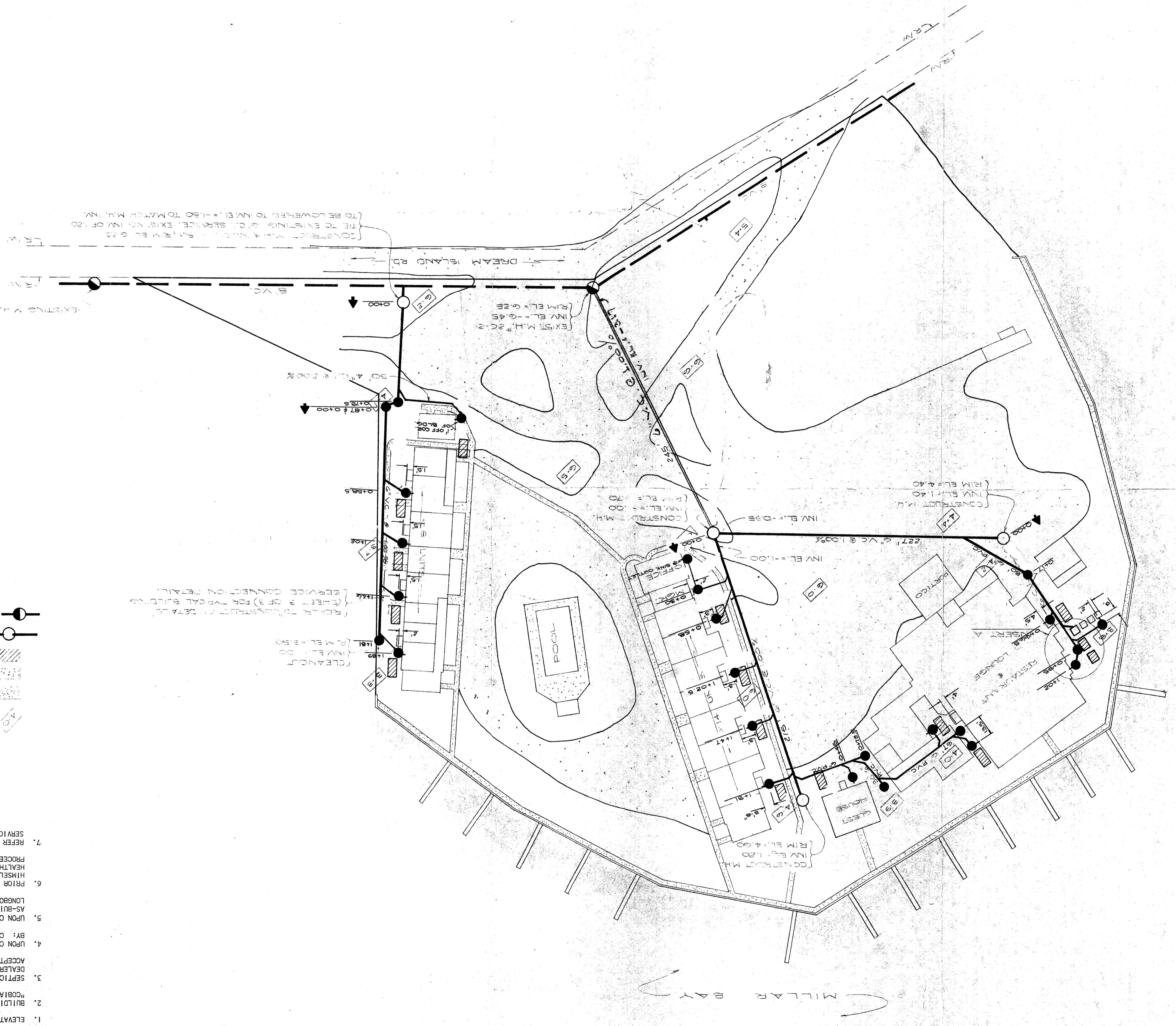

TO BE LOWERED TO INV. EL. = 11.80 TO MATCH M.M. INV.
 TIE TO EXISTING 6\"/>

EXISTING 4\"/>

50' 4\"/>

NO. 1 & 2

NO. 3 & 4

NO. 5 & 6

NO. 7 & 8

NO. 9 & 10

NO. 11 & 12

NO. 13 & 14

NO. 15 & 16

NO. 17 & 18

NO. 19 & 20

NO. 21 & 22

NO. 23 & 24

NO. 25 & 26

NO. 27 & 28

NO. 29 & 30

NO. 31 & 32

NO. 33 & 34

NO. 35 & 36