

STA. 4+00

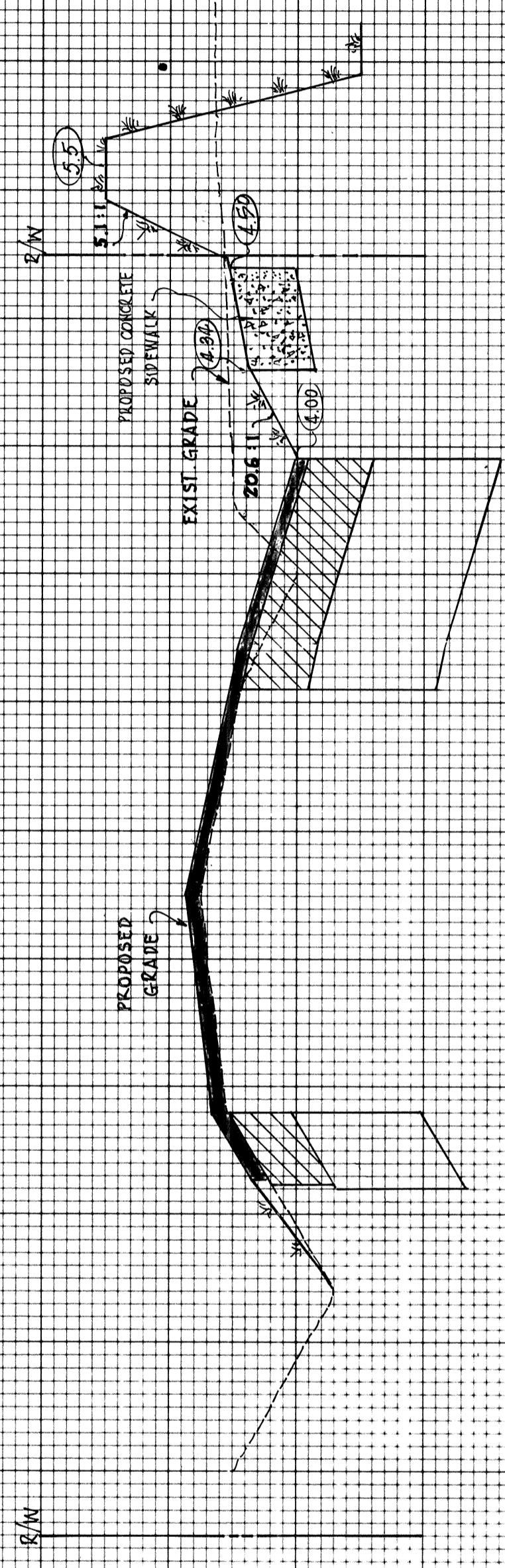

STA. 3+00

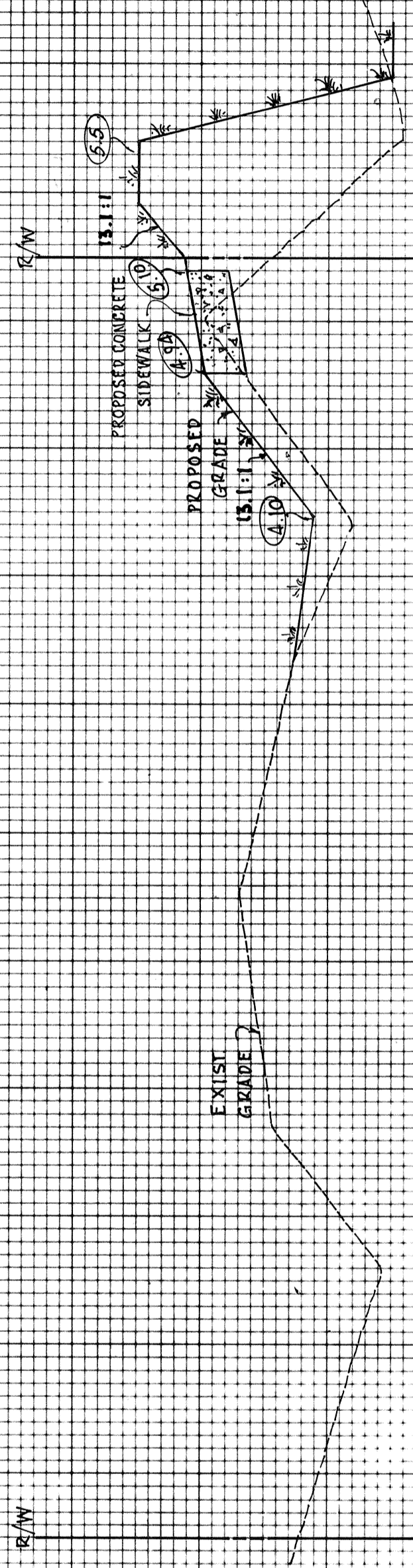

STA. 2+00

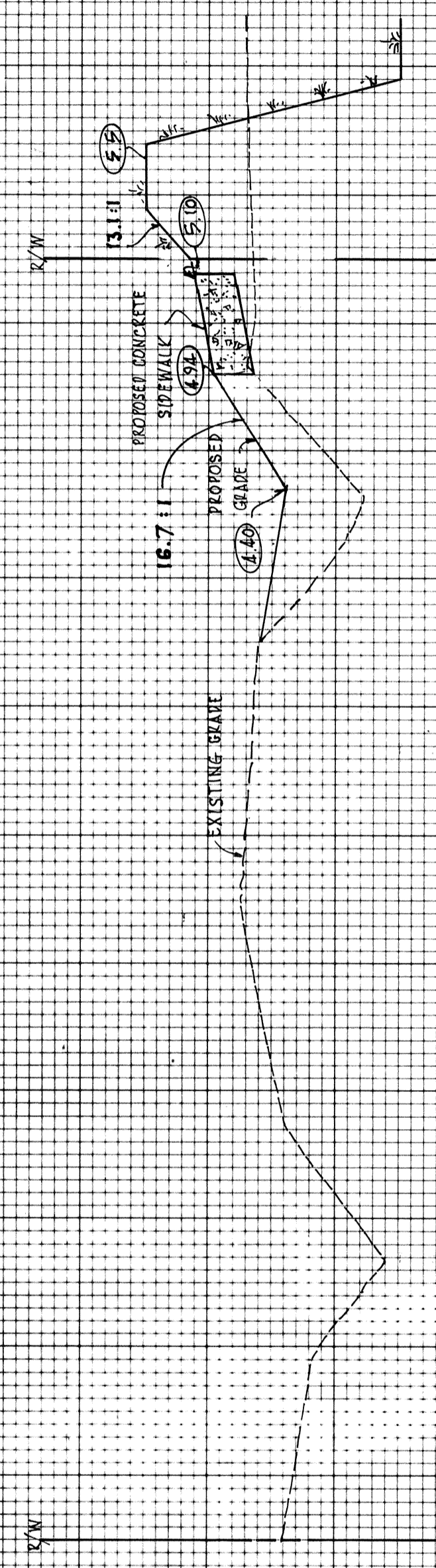

STA. 1+00

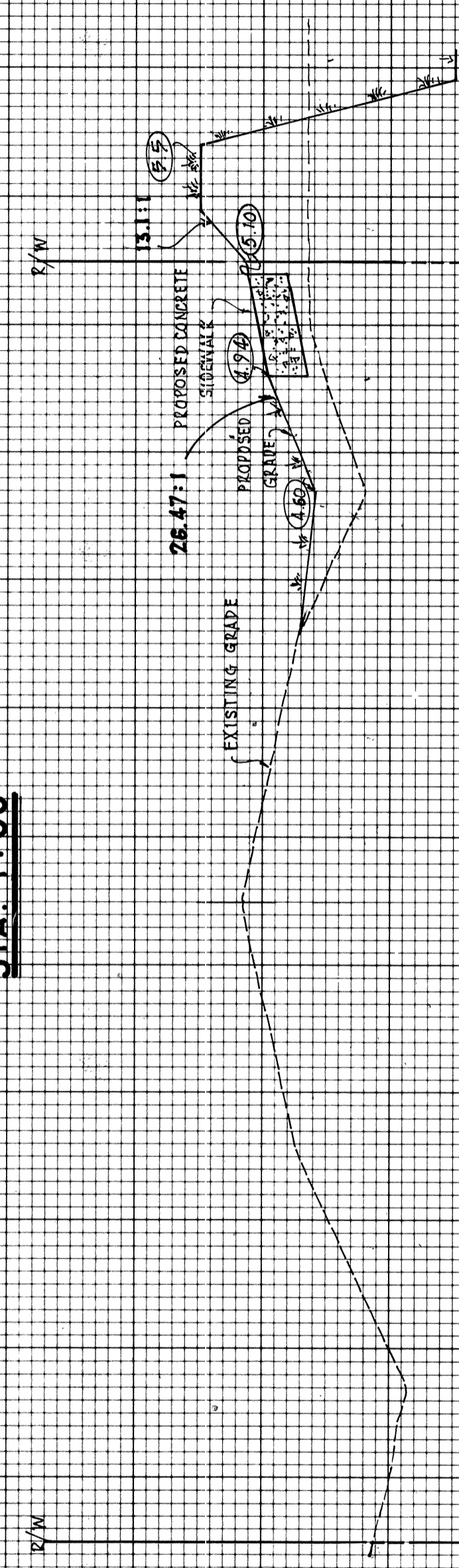

STA. 0+00

RECORD DRAWING

White

FOR: EIVIERA CORPORATION BEACH WALK CONDOMINIUM CROSS - SECTION STA. 0+00 TO 4+00	LTR.	DATE	REVISION	BY	SCALE:	DATE:	DESIGNED BY:	
	C	3/14/89 3/14/91	1. 3/14/89 2. 3/14/91 3. 3/14/91 4. 3/14/91 5. 3/14/91 6. 3/14/91 7. 3/14/91 8. 3/14/91 9. 3/14/91 10. 3/14/91 11. 3/14/91 12. 3/14/91 13. 3/14/91 14. 3/14/91 15. 3/14/91 16. 3/14/91 17. 3/14/91 18. 3/14/91 19. 3/14/91 20. 3/14/91 21. 3/14/91 22. 3/14/91 23. 3/14/91 24. 3/14/91 25. 3/14/91 26. 3/14/91 27. 3/14/91 28. 3/14/91 29. 3/14/91 30. 3/14/91 31. 3/14/91 32. 3/14/91 33. 3/14/91 34. 3/14/91 35. 3/14/91 36. 3/14/91 37. 3/14/91 38. 3/14/91 39. 3/14/91 40. 3/14/91 41. 3/14/91 42. 3/14/91 43. 3/14/91 44. 3/14/91 45. 3/14/91 46. 3/14/91 47. 3/14/91 48. 3/14/91 49. 3/14/91 50. 3/14/91 51. 3/14/91 52. 3/14/91 53. 3/14/91 54. 3/14/91 55. 3/14/91 56. 3/14/91 57. 3/14/91 58. 3/14/91 59. 3/14/91 60. 3/14/91 61. 3/14/91 62. 3/14/91 63. 3/14/91 64. 3/14/91 65. 3/14/91 66. 3/14/91 67. 3/14/91 68. 3/14/91 69. 3/14/91 70. 3/14/91 71. 3/14/91 72. 3/14/91 73. 3/14/91 74. 3/14/91 75. 3/14/91 76. 3/14/91 77. 3/14/91 78. 3/14/91 79. 3/14/91 80. 3/14/91 81. 3/14/91 82. 3/14/91 83. 3/14/91 84. 3/14/91 85. 3/14/91 86. 3/14/91 87. 3/14/91 88. 3/14/91 89. 3/14/91 90. 3/14/91 91. 3/14/91 92. 3/14/91 93. 3/14/91 94. 3/14/91 95. 3/14/91 96. 3/14/91 97. 3/14/91 98. 3/14/91 99. 3/14/91 100. 3/14/91	3/14/89 3/14/91	1. 3/14/89 2. 3/14/91 3. 3/14/91 4. 3/14/91 5. 3/14/91 6. 3/14/91 7. 3/14/91 8. 3/14/91 9. 3/14/91 10. 3/14/91 11. 3/14/91 12. 3/14/91 13. 3/14/91 14. 3/14/91 15. 3/14/91 16. 3/14/91 17. 3/14/91 18. 3/14/91 19. 3/14/91 20. 3/14/91 21. 3/14/91 22. 3/14/91 23. 3/14/91 24. 3/14/91 25. 3/14/91 26. 3/14/91 27. 3/14/91 28. 3/14/91 29. 3/14/91 30. 3/14/91 31. 3/14/91 32. 3/14/91 33. 3/14/91 34. 3/14/91 35. 3/14/91 36. 3/14/91 37. 3/14/91 38. 3/14/91 39. 3/14/91 40. 3/14/91 41. 3/14/91 42. 3/14/91 43. 3/14/91 44. 3/14/91 45. 3/14/91 46. 3/14/91 47. 3/14/91 48. 3/14/91 49. 3/14/91 50. 3/14/91 51. 3/14/91 52. 3/14/91 53. 3/14/91 54. 3/14/91 55. 3/14/91 56. 3/14/91 57. 3/14/91 58. 3/14/91 59. 3/14/91 60. 3/14/91 61. 3/14/91 62. 3/14/91 63. 3/14/91 64. 3/14/91 65. 3/14/91 66. 3/14/91 67. 3/14/91 68. 3/14/91 69. 3/14/91 70. 3/14/91 71. 3/14/91 72. 3/14/91 73. 3/14/91 74. 3/14/91 75. 3/14/91 76. 3/14/91 77. 3/14/91 78. 3/14/91 79. 3/14/91 80. 3/14/91 81. 3/14/91 82. 3/14/91 83. 3/14/91 84. 3/14/91 85. 3/14/91 86. 3/14/91 87. 3/14/91 88. 3/14/91 89. 3/14/91 90. 3/14/91 91. 3/14/91 92. 3/14/91 93. 3/14/91 94. 3/14/91 95. 3/14/91 96. 3/14/91 97. 3/14/91 98. 3/14/91 99. 3/14/91 100. 3/14/91	M.J.Y./CL	HQZ. 1" = 10' VERT. 1" = 1'	DEC. 1988
SMALLY, WELLFORD & NALVEN, INC. CONSULTING ENGINEERS & SURVEYORS 133 SOUTH MCINTOSH RD. SARASOTA, FLA. 33592	DRAWING NUMBER 7	CHECKED BY E.P.	CHECKED BY PROJECT NO. 2499	DESIGNED BY M.J.Y./CL	DRAWN BY E.P.	DATE: DEC. 1988	MILLARD J. JOOPER, P.E. FLA. CERT. NO. 33745	