

ELEVATION CERTIFICATE

Important: Follow the instructions on pages 1-9.

E0294

Copy all pages of this Elevation Certificate and all attachments for (1) community official, (2) insurance agent/company, and (3) building owner.

SECTION A – PROPERTY INFORMATION				FOR INSURANCE COMPANY USE	
A1. Building Owner's Name CRAIG WALTERS				Policy Number:	
A2. Building Street Address (including Apt., Unit, Suite, and/or Bldg. No.) or P.O. Route and Box No. 690 HIBISCUS WAY				Company NAIC Number:	
City TOWN OF LONGBOAT KEY		State Florida		ZIP Code 34228	
A3. Property Description (Lot and Block Numbers, Tax Parcel Number, Legal Description, etc.) TAX PARCEL NUMBER: 77782.0010/0					
A4. Building Use (e.g., Residential, Non-Residential, Addition, Accessory, etc.) <u>RESIDENCE</u>					
A5. Latitude/Longitude: Lat. <u>27°26'07.7" N</u> Long. <u>082°40'50.1" W</u> Horizontal Datum: <input type="checkbox"/> NAD 1927 <input checked="" type="checkbox"/> NAD 1983					
A6. Attach at least 2 photographs of the building if the Certificate is being used to obtain flood insurance.					
A7. Building Diagram Number <u>1A</u>					
A8. For a building with a crawlspace or enclosure(s):					
a) Square footage of crawlspace or enclosure(s) <u>N/A</u> sq ft					
b) Number of permanent flood openings in the crawlspace or enclosure(s) within 1.0 foot above adjacent grade <u>N/A</u>					
c) Total net area of flood openings in A8.b <u>N/A</u> sq in					
d) Engineered flood openings? <input type="checkbox"/> Yes <input checked="" type="checkbox"/> No					
A9. For a building with an attached garage:					
a) Square footage of attached garage <u>493</u> sq ft					
b) Number of permanent flood openings in the attached garage within 1.0 foot above adjacent grade <u>0</u>					
c) Total net area of flood openings in A9.b <u>0</u> sq in					
d) Engineered flood openings? <input type="checkbox"/> Yes <input checked="" type="checkbox"/> No					
SECTION B – FLOOD INSURANCE RATE MAP (FIRM) INFORMATION					
B1. NFIP Community Name & Community Number TOWN OF LONGBOAT KEY 125126			B2. County Name MANATEE COUNTY		B3. State Florida
B4. Map/Panel Number 12081C0291	B5. Suffix E	B6. FIRM Index Date 03-17-2014	B7. FIRM Panel Effective/ Revised Date 03-17-2014	B8. Flood Zone(s) AE	B9. Base Flood Elevation(s) (Zone AO, use Base Flood Depth) 9/10
B10. Indicate the source of the Base Flood Elevation (BFE) data or base flood depth entered in Item B9: <input type="checkbox"/> FIS Profile <input checked="" type="checkbox"/> FIRM <input type="checkbox"/> Community Determined <input type="checkbox"/> Other/Source: _____					
B11. Indicate elevation datum used for BFE in Item B9: <input type="checkbox"/> NGVD 1929 <input checked="" type="checkbox"/> NAVD 1988 <input type="checkbox"/> Other/Source: _____					
B12. Is the building located in a Coastal Barrier Resources System (CBRS) area or Otherwise Protected Area (OPA)? <input type="checkbox"/> Yes <input checked="" type="checkbox"/> No Designation Date: <u>N/A</u> <input type="checkbox"/> CBRS <input type="checkbox"/> OPA					

ELEVATION CERTIFICATE

OMB No. 1660-0008
Expiration Date: November 30, 2018

IMPORTANT: In these spaces, copy the corresponding information from Section A.			FOR INSURANCE COMPANY USE
Building Street Address (including Apt., Unit, Suite, and/or Bldg. No.) or P.O. Route and Box No. 690 HIBISCUS WAY			Policy Number:
City TOWN OF LONGBOAT KEY	State FLORIDA	ZIP Code 34228	Company NAIC Number

SECTION C – BUILDING ELEVATION INFORMATION (SURVEY REQUIRED)

C1. Building elevations are based on: Construction Drawings* Building Under Construction* Finished Construction
*A new Elevation Certificate will be required when construction of the building is complete.

C2. Elevations – Zones A1–A30, AE, AH, A (with BFE), VE, V1–V30, V (with BFE), AR, AR/A, AR/AE, AR/A1–A30, AR/AH, AR/AO. Complete Items C2.a–h below according to the building diagram specified in Item A7. In Puerto Rico only, enter meters.

Benchmark Utilized: SEE COMMENTS Vertical Datum: NAVD 1988

Indicate elevation datum used for the elevations in items a) through h) below.

NGVD 1929 NAVD 1988 Other/Source: _____

Datum used for building elevations must be the same as that used for the BFE.

Check the measurement used.

- | | | | |
|---|-------------|--|---------------------------------|
| a) Top of bottom floor (including basement, crawlspace, or enclosure floor) | <u>5. 5</u> | <input checked="" type="checkbox"/> feet | <input type="checkbox"/> meters |
| b) Top of the next higher floor | <u>5. 8</u> | <input checked="" type="checkbox"/> feet | <input type="checkbox"/> meters |
| c) Bottom of the lowest horizontal structural member (V Zones only) | <u>N/A</u> | <input type="checkbox"/> feet | <input type="checkbox"/> meters |
| d) Attached garage (top of slab) | <u>5. 5</u> | <input checked="" type="checkbox"/> feet | <input type="checkbox"/> meters |
| e) Lowest elevation of machinery or equipment servicing the building
(Describe type of equipment and location in Comments) | <u>5. 6</u> | <input checked="" type="checkbox"/> feet | <input type="checkbox"/> meters |
| f) Lowest adjacent (finished) grade next to building (LAG) | <u>4. 9</u> | <input checked="" type="checkbox"/> feet | <input type="checkbox"/> meters |
| g) Highest adjacent (finished) grade next to building (HAG) | <u>5. 4</u> | <input checked="" type="checkbox"/> feet | <input type="checkbox"/> meters |
| h) Lowest adjacent grade at lowest elevation of deck or stairs, including structural support | <u>N/A</u> | <input type="checkbox"/> feet | <input type="checkbox"/> meters |

SECTION D – SURVEYOR, ENGINEER, OR ARCHITECT CERTIFICATION

This certification is to be signed and sealed by a land surveyor, engineer, or architect authorized by law to certify elevation information. I certify that the information on this Certificate represents my best efforts to interpret the data available. I understand that any false statement may be punishable by fine or imprisonment under 18 U.S. Code, Section 1001.

Were latitude and longitude in Section A provided by a licensed land surveyor? Yes No Check here if attachments.

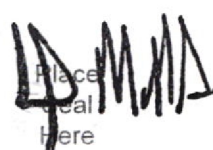
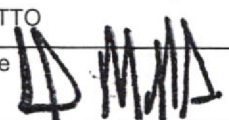
Certifier's Name LEO MILLS, JR	License Number FL 3513	<p style="text-align: center;">3-15-18</p>  <p style="text-align: center;">PSM 3513</p>
Title REGISTERED SURVEYOR		
Company Name LEO MILLS & ASSOCIATES, INC.		
Address 620 8th AVENUE WEST		
City PALMETTO	State Florida	
Signature 	Date 03/15/2018	Telephone (941)722-2460

Copy all pages of this Elevation Certificate and all attachments for (1) community official, (2) insurance agent/company, and (3) building owner.

Comments (including type of equipment and location, per C2(e), if applicable)

SOURCE AND USED BENCH MARK: NORTH BONNET NUT ON FIRE HYDRANT 718 LINLEY ST. ELEVATION = 4.08 NAVD 1988.
C2.a) ELEVATION SHOWN IS FOR OFFICE NEXT TO GARAGE. C2.b) ELEVATION IS FOR MAIN RESIDENCE.
C2.e) ELEVATION SHOWN IS FOR TOP OF PLATFORM FOR A/C UNIT AT SOUTHWESTERLY CORNER OF RESIDENCE AFFIXED TO EXTERIOR WALL; TOP OF PLATFORM FOR A/C UNIT BY GARAGE AFFIXED TO EXTERIOR WALL, ELEVATION = 5.7; TOP OF PLATFORM FOR HOT WATER HEATER AFFIXED TO INTERIOR WALL, ELEVATION = 5.8.

ELEVATION CERTIFICATE

OMB No. 1660-0008
Expiration Date: November 30, 2018

IMPORTANT: In these spaces, copy the corresponding information from Section A.			FOR INSURANCE COMPANY USE
Building Street Address (including Apt., Unit, Suite, and/or Bldg. No.) or P.O. Route and Box No. 690 HIBISCUS WAY			Policy Number:
City TOWN OF LONGBOAT KEY	State FLORIDA	ZIP Code 34228	Company NAIC Number

SECTION E – BUILDING ELEVATION INFORMATION (SURVEY NOT REQUIRED) FOR ZONE AO AND ZONE A (WITHOUT BFE)

For Zones AO and A (without BFE), complete Items E1–E5. If the Certificate is intended to support a LOMA or LOMR-F request, complete Sections A, B, and C. For Items E1–E4, use natural grade, if available. Check the measurement used. In Puerto Rico only, enter meters.

- E1. Provide elevation information for the following and check the appropriate boxes to show whether the elevation is above or below the highest adjacent grade (HAG) and the lowest adjacent grade (LAG).
- a) Top of bottom floor (including basement, crawlspace, or enclosure) is _____ . _____ feet meters above or below the HAG.
- b) Top of bottom floor (including basement, crawlspace, or enclosure) is _____ . _____ feet meters above or below the LAG.
- E2. For Building Diagrams 6–9 with permanent flood openings provided in Section A Items 8 and/or 9 (see pages 1–2 of Instructions), the next higher floor (elevation C2.b in the diagrams) of the building is _____ . _____ feet meters above or below the HAG.
- E3. Attached garage (top of slab) is _____ . _____ feet meters above or below the HAG.
- E4. Top of platform of machinery and/or equipment servicing the building is _____ . _____ feet meters above or below the HAG.
- E5. Zone AO only: If no flood depth number is available, is the top of the bottom floor elevated in accordance with the community's floodplain management ordinance? Yes No Unknown. The local official must certify this information in Section G.

SECTION F – PROPERTY OWNER (OR OWNER'S REPRESENTATIVE) CERTIFICATION

The property owner or owner's authorized representative who completes Sections A, B, and E for Zone A (without a FEMA-issued or community-issued BFE) or Zone AO must sign here. The statements in Sections A, B, and E are correct to the best of my knowledge.

Property Owner or Owner's Authorized Representative's Name

Address City State ZIP Code

Signature Date Telephone

Comments

Check here if attachments.

ELEVATION CERTIFICATE

BUILDING PHOTOGRAPHS

See Instructions for Item A6.

OMB Control Number: 1660-0008

Expiration: 11/30/2018

IMPORTANT: In these spaces, copy the corresponding information from Section A.			FOR INSURANCE COMPANY USE		
Building Street Address (including Apt., Unit, Suite, and/or Bldg. No.) or P.O. Route and Box No. 690 HIBISCUS WAY			Policy Number:		
City	LONGBOAT KEY	State	Florida	Zip Code	34228
Company NAIC Number:					

If using the Elevation Certificate to obtain NFIP insurance, affix at least 2 building photographs below according to the instructions for Item A6. Identify all photographs with date taken, "Front View" and "Rear view", and, if required, "Right Side View" and "Left Side View". When applicable, photographs must show the foundation with representative examples of the flood openings or vents, as indicated in Section A8. If submitting more photographs that will fit on this page, use the Continuation Page.

It is the responsibility of the reviewer (Insurance Agents, Building Officials, etc) of this elevation certificate to analyze all of the data given in conjunction with a site visit to determine the proper Building Diagram Number (Item A7). The building diagram number shown in Item A7 is given as determined by the certificate preparer and should not be used for insurance rating or building compliance purposes unless verified by reviewer

PHOTO 1



PHOTO ONE CAPTION: FRONT VIEW

PHOTO 2

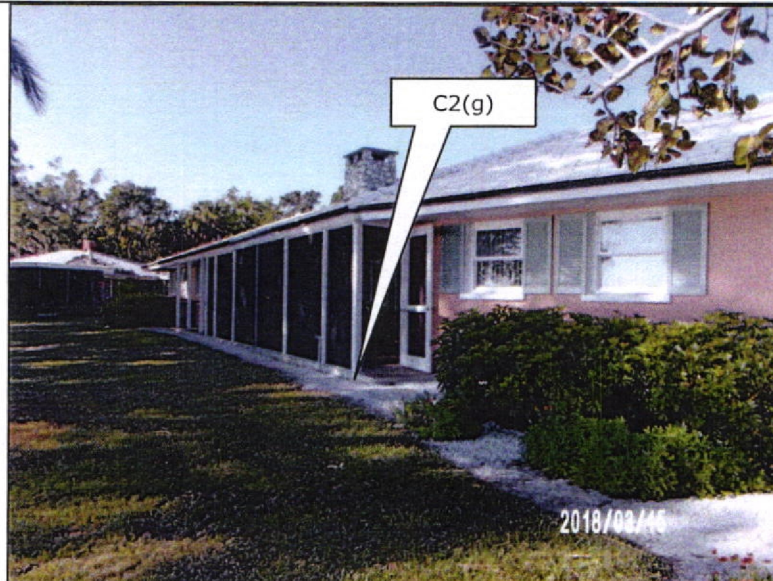

LM
 Leo Mills, Jr.
 Date 03/15/2018
 P.L.S. 3513

Job# E-0294

PHOTO TWO CAPTION: REAR VIEW

ELEVATION CERTIFICATE

BUILDING PHOTOGRAPHS

See Instructions for Item A6.

OMB Control Number: 1660-0008

Expiration: 11/30/2018

IMPORTANT: In these spaces, copy the corresponding information from Section A.			FOR INSURANCE COMPANY USE
Building Street Address (including Apt., Unit, Suite, and/or Bldg. No.) or P.O. Route and Box No. 690 HIBISCUS WAY			Policy Number:
City LONGBOAT KEY	State Florida	Zip Code 34228	Company NAIC Number:

If using the Elevation Certificate to obtain NFIP insurance, affix at least 2 building photographs below according to the instructions for Item A6. Identify all photographs with date taken, "Front View" and "Rear view", and, if required, "Right Side View" and "Left Side View". When applicable, photographs must show the foundation with representative examples of the flood openings or vents, as indicated in Section A8. If submitting more photographs that will fit on this page, use the Continuation Page. It is the responsibility of the reviewer (Insurance Agents, Building Officials, etc) of this elevation certificate to analyze all of the data given in conjunction with a site visit to determine the proper Building Diagram Number (Item A7). The building diagram number shown in Item A7 is given as determined by the certificate preparer and should not be used for insurance rating or building compliance purposes unless verified by reviewer

PHOTO 3



PHOTO THREE CAPTION: RIGHT SIDE VIEW

PHOTO 4

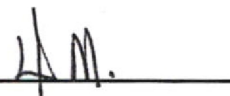

 Leo Mills, Jr.
 Date 03/15/2018
 P.L.S. 3513

Job# E-0294

PHOTO FOUR CAPTION: LEFT SIDE VIEW