

DEPARTMENT OF HOMELAND SECURITY
Federal Emergency Management Agency
ELEVATION CERTIFICATE

IMPORTANT: FOLLOW THE INSTRUCTIONS ON PAGES 9-16

OMB Control Number: 1660-0008
Expiration: 11/30/2018

Copy all pages of this Elevation Certificate and all attachments for (1) community official, (2) insurance agent/company, and (3) building owner.

SECTION A - PROPERTY INFORMATION		FORM INSURANCE COMPANY USE	
A1. Building Owner's Name ORCHID ON LONGBOAT KEY LLC.		Policy Number:	
A2. Building Street Address (including Apt., Unit, Suite, and/or Bldg. No.) or P.O. Route and Box No. 4765 GULF OF MEXICO DRIVE (MID-RISE)		Company NAIC Number:	
City TOWN OF LONGBOAT KEY	State FL	Zip Code 34228	
A3. Property Description (Lot and Block Numbers, Tax Parcel Number, Legal Description, etc.) PART OF SHORE ACRES-LOT 5, BLOCK 7, FIRST ST. AND ATLAS ST., P.I.N. 8017400006-MANATEE COUNTY, FL.			
A4. Building Use (e.g., Residential, Non-Residential, Addition, Accessory, etc.)		RESIDENTIAL	
A5. Latitude/Longitude: Lat. <u>27 24' 02.1"</u> Long. <u>82 38' 59.8"</u> Horizontal Datum: <input type="radio"/> NAD 1927 <input checked="" type="radio"/> NAD 1983			
A6. Attach at least 2 photographs of the building if the Certificate is being used to obtain flood insurance.			
A7. Building Diagram Number <u>6</u>			
A8. For a building with a crawlspace or enclosure(s):		A9. For a building with an attached garage:	
a) Square footage of crawlspace or enclosure(s) <u>789</u> sq ft	b) Number of permanent flood openings in the crawlspace or enclosure(s) within 1.0 foot above adjacent grade <u>12</u>	a) Square footage of attached garage <u>N/A</u> sq ft	b) Number of permanent flood openings in the attached garage within 1.0 foot above adjacent grade <u>N/A</u>
c) Total net area of flood openings in A8.b <u>2,400</u> sq in	d) Engineered flood openings? <input checked="" type="radio"/> Yes <input type="radio"/> No	c) Total net area of flood openings in A9.b <u>N/A</u> sq in	d) Engineered flood openings? <input type="radio"/> Yes <input checked="" type="radio"/> No

SECTION B - FLOOD INSURANCE RATE MAP (FIRM) INFORMATION						
B1. NFIP Community Name & Community Number TOWN OF LONGBOAT KEY - 125126			B2. County Name MANATEE		B3. State FL	
B4. Map/Panel Number 1208C/0294	B5. Suffix E	B6. FIRM Index Date 03/17/2014	B7. FIRM Panel Effective/ Revised Date <u>3/17/14</u>	B8. Flood Zone(s) AE	B9. Base Flood Elevation(s) (Zone AO, use base flood depth) 10	
B10. Indicate the source of the Base Flood Elevation (BFE) data or base flood depth entered in Item B9: <input type="radio"/> FIS Profile <input checked="" type="radio"/> FIRM <input type="radio"/> Community Determined <input type="radio"/> Other/Source: _____						
B11. Indicate elevation datum used for BFE in Item B9: <input type="radio"/> NGVD 1929 <input checked="" type="radio"/> NAVD 1988 <input type="radio"/> Other/Source: _____						
B12. Is the building located in a Coastal Barrier Resources System (CBRS) area or Otherwise Protected Area (OPA)? <input type="radio"/> Yes <input checked="" type="radio"/> No Designation Date: <input type="radio"/> CBRS <input type="radio"/> OPA						

SECTION C - BUILDING ELEVATION INFORMATION (SURVEY REQUIRED)			
C1. Building elevations are based on: <input type="radio"/> Construction Drawings* <input type="radio"/> Building Under Construction* <input checked="" type="radio"/> Finished Construction			
C2. Elevations - Zones A1 - A30, AE, AH, A (with BFE), VE, V1 - V30, V (with BFE), AR, AR/A, AR/AE, AR/A1 - A30, AR/AH, AR/AO. Complete Items C2.a -h below according to the building diagram specified in Item A7. In Puerto Rico only, enter meters. * A new Elevation Certificate will be required when construction of the building is complete.			
Benchmark Utilized: <u>COASTAL CONST. MON. 13 84 B13</u> Vertical Datum: <u>NAVD 1988</u>			
Indicate elevation datum used for the elevations in items a) through h) below. <input type="radio"/> NGVD 1929 <input checked="" type="radio"/> NAVD 1988 <input type="radio"/> Other/Source: _____			
Datum used for building elevations must be the same as that used for the BFE.			Check the measurement used.
a) Top of bottom floor (including basement, crawlspace, or enclosure floor)	<u>7</u> - <u>0</u>	<input checked="" type="radio"/> feet <input type="radio"/> meters	
b) Top of the next higher floor	<u>20</u> - <u>0</u>	<input checked="" type="radio"/> feet <input type="radio"/> meters	
c) Bottom of the lowest horizontal structural member (V Zones only)	<u>17</u> - <u>0</u>	<input checked="" type="radio"/> feet <input type="radio"/> meters	
d) Attached garage (top of slab)	<u>N/A</u> - _____	<input checked="" type="radio"/> feet <input type="radio"/> meters	
e) Lowest elevation of machinery or equipment servicing the building (Describe type of equipment and location in Comments)	<u>14</u> - <u>1</u>	<input checked="" type="radio"/> feet <input type="radio"/> meters	
f) Lowest adjacent (finished) grade next to building (LAG)	<u>6</u> - <u>7</u>	<input checked="" type="radio"/> feet <input type="radio"/> meters	
g) Highest adjacent (finished) grade next to building (HAG)	<u>7</u> - <u>2</u>	<input checked="" type="radio"/> feet <input type="radio"/> meters	
h) Lowest adjacent grade at lowest elevation of deck or stairs, including structural support	<u>7</u> - <u>1</u>	<input checked="" type="radio"/> feet <input type="radio"/> meters	

ELEVATION CERTIFICATE

OMB Control Number: 1660-0008
Expiration: 11/30/2018

4765 GULF OF MEXICO DRIVE (MID-RISE)

TOWN OF LONGBOAT KEY

FL

34228

SECTION D - SURVEYOR, ENGINEER, OR ARCHITECT CERTIFICATION

This certification is to be signed and sealed by a land surveyor, engineer, or architect authorized by law to certify elevation information. I certify that the information on this Certificate represents my best efforts to interpret the data available. I understand that any false statement may be punishable by fine or imprisonment under 18 U.S. Code, Section 1001.

Check here if attachments.

Were latitude and longitude in Section A provided by a licensed land surveyor?

Yes No

Certifier's Name RICHARD M. RITZ		License Number 4009	
Title REGISTERED LAND SURVEYOR	Company Name BANKS ENGINEERING		
Address 10511 SIX MILE CYPRESS PARKWAY	City FT. MYERS	State FL	Zip Code 33966
Signature <i>Richard M. Ritz</i>	Date 05/16/2016	Telephone +1 (239) 939-5490	

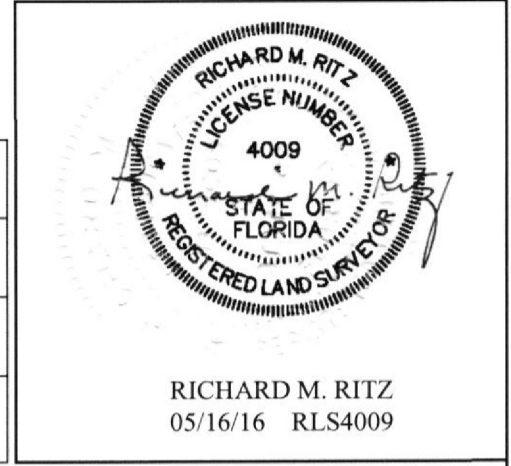

Copy both sides of this Elevation Certificate for (1) community official, (2) insurance agent/company, and (3) building owner.

Comments (including type of equipment and location, per C2(e), if applicable)"

1. Latitude and Longitude were obtained by real time GPS observation.
2. C2(e): Bottom of electric panel.
3. A8(b): "smartvents" model 1540-520 rated for 200 sq. in. each.
4. Note: Elevation of elevator pit is 2.9 feet.

Richard M. Ritz

Signature _____ Date 05/16/2016

SECTION E - BUILDING ELEVATION INFORMATION (SURVEY NOT REQUIRED) FOR ZONE AO AND ZONE A (WITHOUT BFE)

For Zones AO and A (without BFE), complete Items E1 -E5. If the Certificate is intended to support a LOMA or LOMR-F request, complete Sections A, B, and C. For Items E1 -E4, use natural grade, if available. Check the measurement used. In Puerto Rico only, enter meters.

- E1. Provide elevation information for the following and check the appropriate boxes to show whether the elevation is above or below the highest adjacent grade (HAG) and the lowest adjacent grade (LAG).
- a) Top of bottom floor (including basement, crawlspace, or enclosure) is _____ - _____ feet meters above or below the HAG.
- b) Top of bottom floor (including basement, crawlspace, or enclosure) is _____ - _____ feet meters above or below the LAG.
- E2. For Building Diagrams 6 -9 with permanent flood openings provided in Section A Items 8 and/or 9 (see pages 8 -9 of Instructions), the next higher floor (elevation C2.b in the diagrams) of the building is _____ - _____ feet meters above or below the HAG.
- E3. Attached garage (top of slab) is _____ - _____ feet meters above or below the HAG.
- E4. Top of platform of machinery and /or equipment servicing the building is _____ - _____ feet meters above or below the HAG.
- E5. Zone AO only: If no flood depth number is available, is the top of the bottom floor elevated in accordance with the community's floodplain management ordinance? Yes No Unknown. The local official must certify this information in Section G.

SECTION F - PROPERTY OWNER (OR OWNER'S REPRESENTATIVE) CERTIFICATION

The property owner or owner's authorized representative who completes Sections A, B, and E for Zone A (without a FEMA-issued or community-issued BFE) or Zone AO must sign here. The statements in Sections A, B, and E are correct to the best of my knowledge.

Property Owner or Owner's Authorized Representative's Name: _____

Address	City	State	ZIP Code
Signature	Date	Telephone	

Comments

Check here if attachments.

SECTION G - COMMUNITY INFORMATION (OPTIONAL)

A local official who is authorized by law or ordinance to administer the community's floodplain management ordinance can complete Sections A, B, C (or E), and G of this Elevation Certificate. Complete the applicable item(s) and sign below. Check the measurement used in Items G8 -G10. In Puerto Rico only, enter meters.

- G1. The information in Section C was taken from other documentation that has been signed and sealed by a licensed surveyor, engineer, or architect who is authorized by law to certify elevation information. (Indicate the source and date of the elevation data in the Comments area below.)
- G2. A community official completed Section E for a building located in Zone A (without a FEMA-issued or community-issued BFE) or Zone AO.
- G3. The following information (Items G4 -G10) is provided for community floodplain management purposes.

G4. Permit Number	G5. Date Permit Issued	G6. Date Certificate of Compliance/Occupancy
-------------------	------------------------	--

G7. This permit has been issued for: New Construction Substantial Improvement

G8. Elevation of as-built lowest floor (including basement) of the building: _____ - _____ feet meters Datum _____

G9. BFE or (in Zone AO) depth of flooding at the building site: _____ - _____ feet meters Datum _____

G10. Community's design flood elevation: _____ - _____ feet meters Datum _____

Local Official's Name <i>Darin D. Cushing</i>	Title <i>Building Official</i>
Community Name <i>Town of Longboat Key</i>	Telephone <i>941-316-1965</i>
Signature <i>D. D. Cushing</i>	Date <i>10-3-16</i>

Comments
B7- Added correct data.

RECEIVED
 MAY 26 2016
 TOWN OF LONGBOAT KEY
 Planning, Zoning and Building

Check here if attachments.

BUILDING PHOTOGRAPHS

See instructions for Item A6

OMB Control Number: 1660-0008
Expiration: 11/30/2018

IMPORTANT: In these spaces, copy the corresponding information from Section A.			FOR INSURANCE COMPANY USE		
Building Street Address (including Apt., Unit, Suite, and/or Bldg. No.) or P.O. Route and Box No. 4765 GULF OF MEXICO DRIVE (MID-RISE)			Policy Number:		
City TOWN OF LONGBOAT KEY	State FL	Zip Code 34228	Company NAIC Number:		

If using the Elevation Certificate to obtain NFIP flood insurance, affix at least 2 building photographs below according to the instructions for Item A6. Identify all photographs with date taken; "Front view" and Rear view"; and, if required, "Right Side View" and "Left Side View." When applicable, photographs must show the foundation with representative examples of the flood openings or vents, as indicated in Section A8. If submitting more photographs than will fit on this page, use the Continuation Page.



FRONT VIEW



LEFT SIDE VIEW

BUILDING PHOTOGRAPHS
Continuation Page

OMB Control Number: 1660-0008
Expiration: 11/30/2018

IMPORTANT: In these spaces, copy the corresponding information from Section A.			FORM INSURANCE COMPANY USE
Building Street Address (including Apt., Unit, Suite, and/or Bldg. No.) or P.O. Route and Box No. 4765 GULF OF MEXICO DRIVE (MID-RISE)			Policy Number:
City TOWN OF LONGBOAT KEY	State FL	Zip Code 34228	Company NAIC Number:

If submitting more photographs than will fit on the preceding page, affix the additional photographs below. Identify all photographs with: date taken; "Front View" and "Rear View" and, if required, "Right Side View" and "Left Side View." When applicable, photographs must show the foundation with representative examples of the flood openings or vents, as indicated in Section A8.



**RIGHT SIDE VIEW
LOOKING WEST**



**RIGHT SIDE VIEW
LOOKING EAST**



REAR VIEW



SMART VENT



**LEFT SIDE
LOOKING WEST**