

INSTALLATION OF TOWN OWNED FIBER OPTIC AND STREET LIGHTING ALONG GULF OF MEXICO DRIVE

PHASE 4

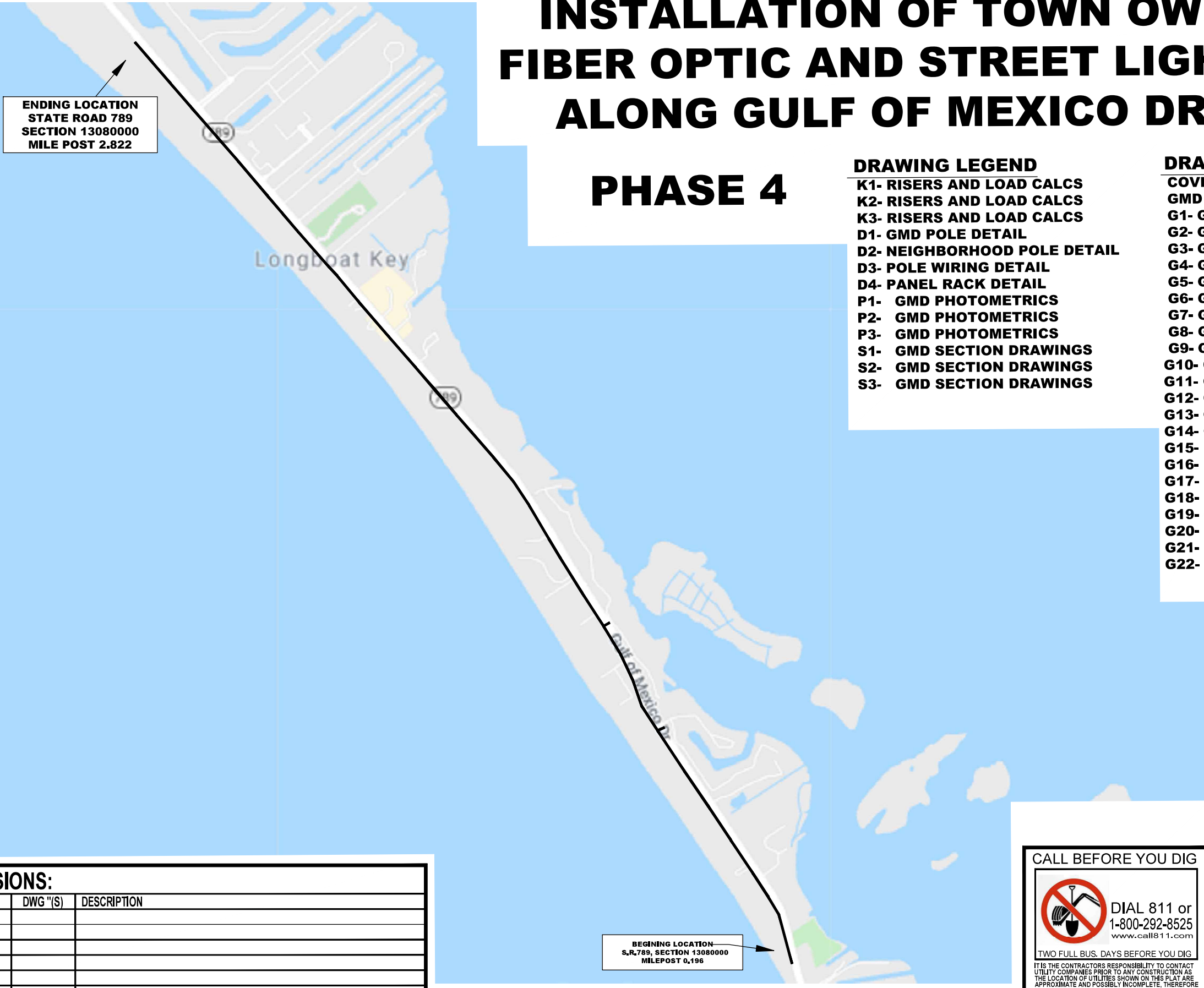

DRAWING LEGEND

- K1- RISERS AND LOAD CALCS
- K2- RISERS AND LOAD CALCS
- K3- RISERS AND LOAD CALCS
- D1- GMD POLE DETAIL
- D2- NEIGHBORHOOD POLE DETAIL
- D3- POLE WIRING DETAIL
- D4- PANEL RACK DETAIL
- P1- GMD PHOTOMETRICS
- P2- GMD PHOTOMETRICS
- P3- GMD PHOTOMETRICS
- S1- GMD SECTION DRAWINGS
- S2- GMD SECTION DRAWINGS
- S3- GMD SECTION DRAWINGS

DRAWING LEGEND

- COVER
- GMD SHEET KEY MAP
- G1- GMD PLAN DRAWING
- G2- GMD PLAN DRAWING
- G3- GMD PLAN DRAWING
- G4- GMD PLAN DRAWING
- G5- GMD PLAN DRAWING
- G6- GMD PLAN DRAWING
- G7- GMD PLAN DRAWING
- G8- GMD PLAN DRAWING
- G9- GMD PLAN DRAWING
- G10- GMD PLAN DRAWING
- G11- GMD PLAN DRAWING
- G12- GMD PLAN DRAWING
- G13- GMD PLAN DRAWING
- G14- GMD PLAN DRAWING
- G15- GMD PLAN DRAWING
- G16- GMD PLAN DRAWING
- G17- GMD PLAN DRAWING
- G18- GMD PLAN DRAWING
- G19- GMD PLAN DRAWING
- G20- GMD PLAN DRAWING
- G21- GMD PLAN DRAWING
- G22- GMD PLAN DRAWING

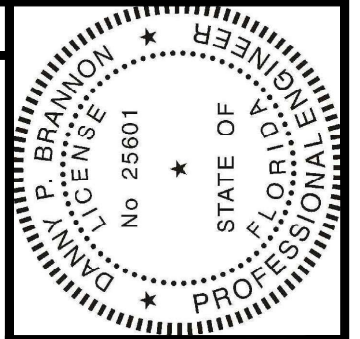

Digitally signed by
 Danny P Brannon
 Date: 2021.09.11
 16:25:18 -04'00'

DANNY P. BRANNON, P. E.,
 FLORIDA P. E. NO. 25601

DATE

Town of Longboat Key

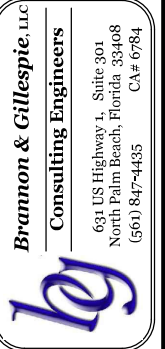

DRAWINGS FOR:
FIBER OPTIC AND STREET LIGHTING UTILITY CONSTRUCTION
 LONGBOAT KEY, FLORIDA



Date: 12/01/2019
 Scale: AS NOTED
 Drawn: DPB
 Checked: DPB
 Job #: 2014-LBK
 Sheet: G1

REVISIONS:		
DATE	DWG "(S)	DESCRIPTION

CALL BEFORE YOU DIG

DIAL 811 or 1-800-292-8525
 www.call811.com

TWO FULL BUS. DAYS BEFORE YOU DIG

IT IS THE CONTRACTORS RESPONSIBILITY TO CONTACT UTILITY COMPANIES PRIOR TO ANY CONSTRUCTION AS THE LOCATION OF UTILITIES SHOWN ON THIS PLAT ARE APPROXIMATE AND POSSIBLY INCOMPLETE. THEREFORE CERTIFICATION TO THE LOCATION OF ALL UNDERGROUND UTILITIES IS WITH HELD.

CONTRACTOR SHALL VERIFY ALL PLAN & EXISTING DIMENSIONS & CONDITIONS ON THE ROUTE BEFORE PROCEEDING WITH THE WORK AND IS RESPONSIBLE FOR SAME

UTILITIES SHOWN ON PLANS ARE APPROXIMATE LOCATIONS AND WERE ACQUIRED FROM THE BEST AVAILABLE DATA AND REASONABLY OBTAINED BY PHYSICAL FIELD SURVEY.

RECLAIMED	YES
WATER MAIN	YES
SEWER - F/M	YES
ELECTRIC	YES
CATV	YES
GAS	YES
TELEPHONE	YES

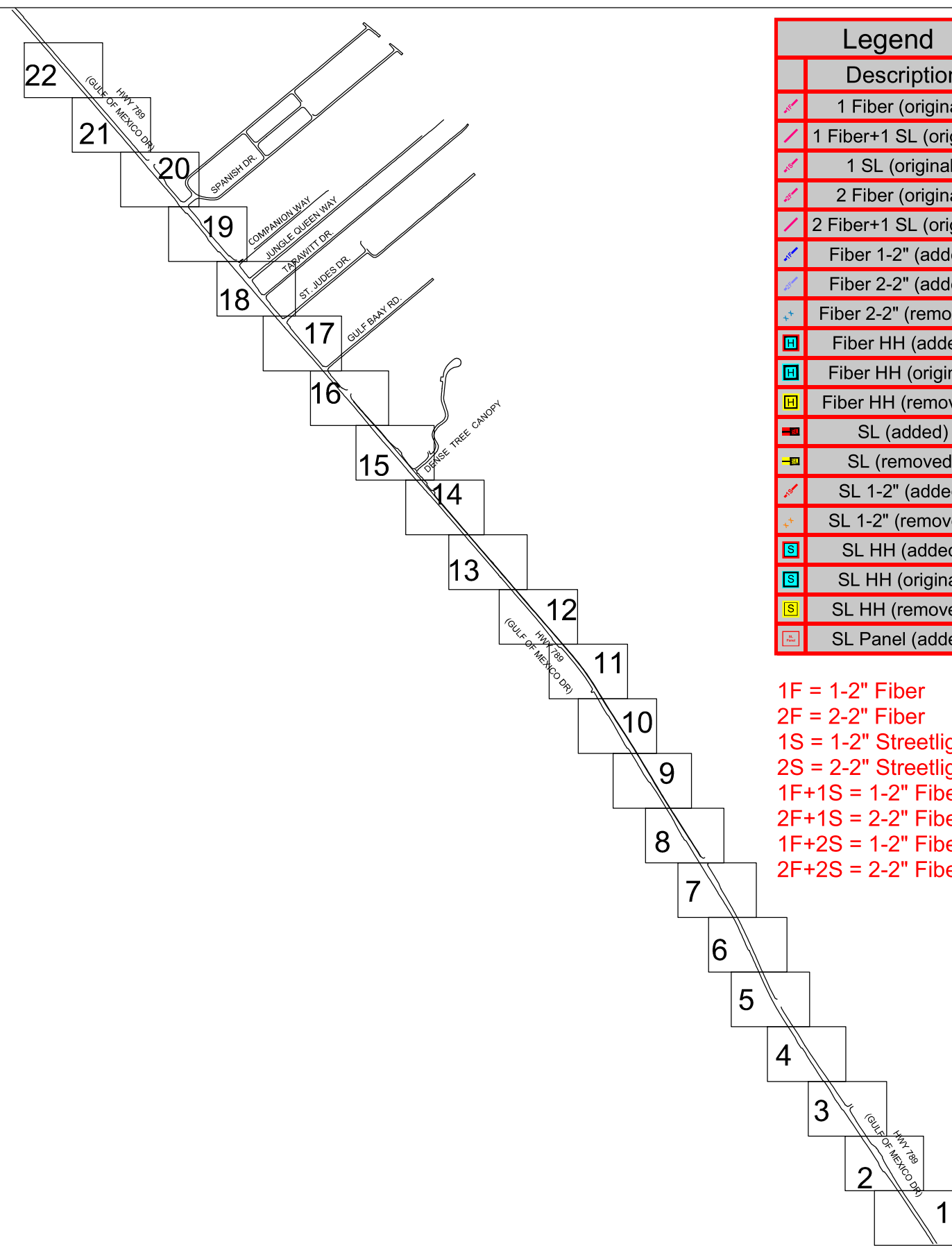

Legend	
	Description
	1 Fiber (original)
	1 Fiber+1 SL (original)
	1 SL (original)
	2 Fiber (original)
	2 Fiber+1 SL (original)
	Fiber 1-2" (added)
	Fiber 2-2" (added)
	Fiber 2-2" (removed)
	Fiber HH (added)
	Fiber HH (original)
	Fiber HH (removed)
	SL (added)
	SL (removed)
	SL 1-2" (added)
	SL 1-2" (removed)
	SL HH (added)
	SL HH (original)
	SL HH (removed)
	SL Panel (added)

1F = 1-2" Fiber
 2F = 2-2" Fiber
 1S = 1-2" Streetlight
 2S = 2-2" Streetlight
 1F+1S = 1-2" Fiber and 1-2" Streetlight
 2F+1S = 2-2" Fiber and 1-2" Streetlight
 1F+2S = 1-2" Fiber and 2-2" Streetlight
 2F+2S = 2-2" Fiber and 2-2" Streetlight

SYMBOL LEGEND	
	CENTERLINE
	EDGE OF PAVEMENT
	RIGHT OF WAY
	SIDEWALK
	PROPOSED CONDUIT
	SANITARY SEWER
	OVERHEAD LINES
	PROPERTY LINES
	SURVEY CONTROL POINT
	CONCRETE MONUMENT FOUND
	IRON PIPE FOUND
	IRON ROD FOUND
	NAIL AND DISC FOUND
	UTILITY POLE (WOOD)
	UTILITY POLE (CONCRETE)
	GUY WIRE
	SANITARY MANHOLE
	CLEANOUT
	GRATE INLET
	STORMWATER MANHOLE
	MITERED END SECTION
	UTILITY MANHOLE
	GAS LINE MARKER
	FIRE HYDRANT
	WATER VALVE
	WATER METER
	BACKFLOW PREVENTER
	TRANSFORMER
	CABLE MARKER
	GAS VALVE / METER
	LIGHT POLE
	LANDSCAPE LIGHT
	BOLLARD
	SIGN
	UTILITY RISER / PEDESTAL
	CONTROL PANEL
	TRAFFIC / PEDESTRIAN CONTROL
	IRRIGATION VALVE
	GUY POLE
	SERVICE BOX (ELECTRIC)
	SERVICE BOX (CABLE)
	SERVICE BOX (TELEPHONE)
	MAILBOX
	STREET LIGHT 10" x 17" HANDHOLE.
	FIBER OPTICS 30"x48" HANDHOLE
	UNLESS MARKED OTHERWISE.
	PROPOSED STREET LIGHT
	EXISTING STREET POST LIGHT
	EXISTING STREET POST LIGHT WITH STREET SIGN
	EXISTING MASTARM STREET LIGHT

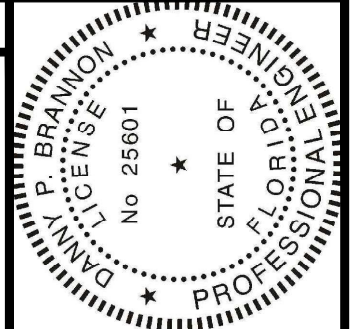

Digitally signed by
 Danny P Brannon
 Date: 2021.09.11
 16:25:18 -04'00'
 DANNY P. BRANNON, P. E.
 FLORIDA P. E. NO. 25601
 DATE:

Town of Longboat Key

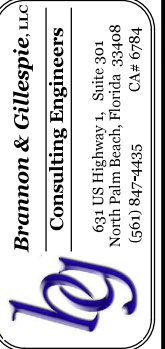

DRAWINGS FOR:
FIBER OPTIC AND STREET LIGHTING UTILITY CONSTRUCTION
 LONGBOAT KEY, FLORIDA



Date: 12/01/2019
 Scale: AS NOTED
 Drawn: DPB
 Checked: DPB
 Job # 2014-LBK

KEY MAP

MATCHLINE-STA 374+33
FOR CONTINUATION SEE SHEET 16

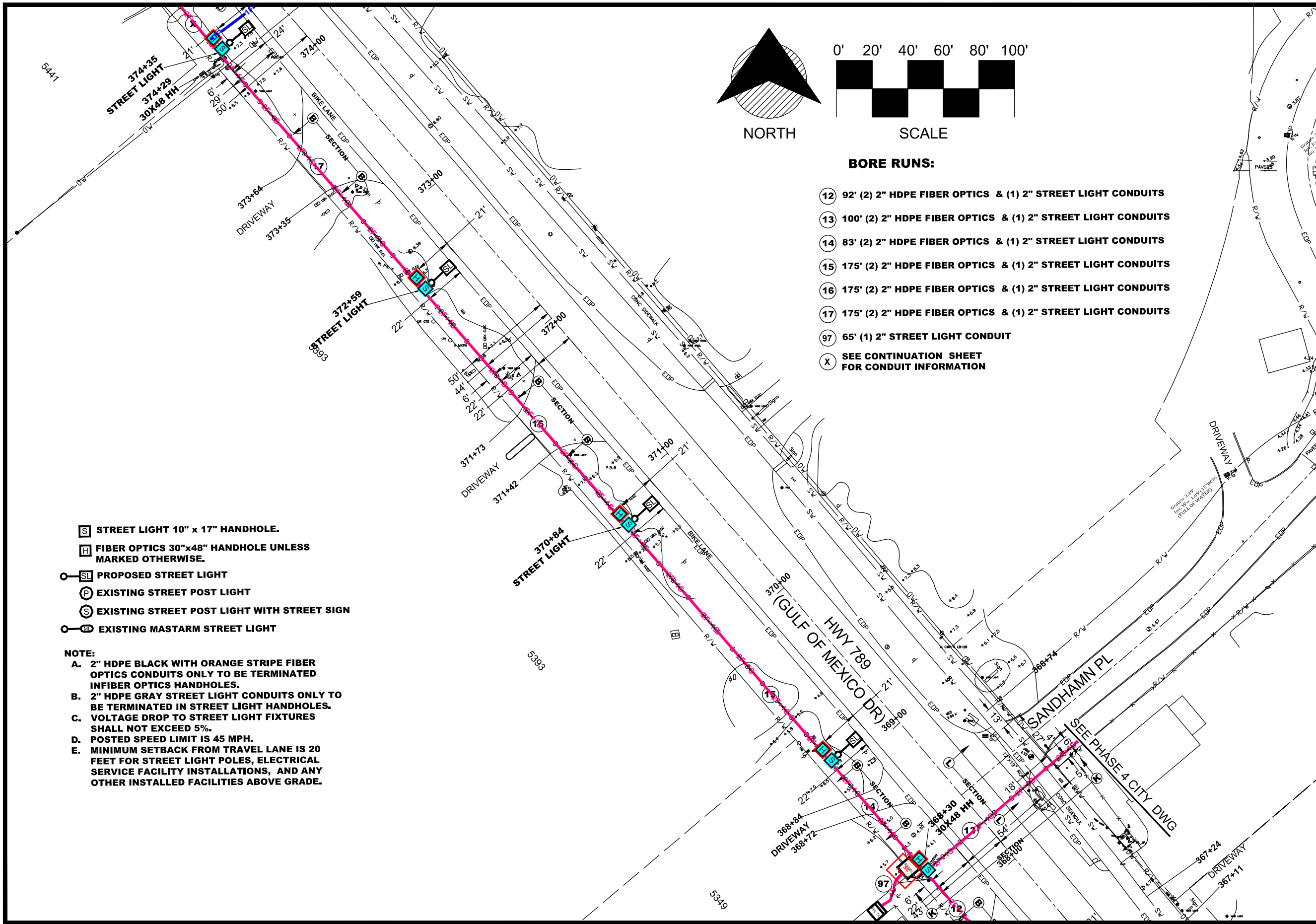

0' 20' 40' 60' 80' 100'
SCALE

BORE RUNS:

- ⑫ 92' (2) 2" HDPE FIBER OPTICS & (1) 2" STREET LIGHT CONDUITS
- ⑬ 100' (2) 2" HDPE FIBER OPTICS & (1) 2" STREET LIGHT CONDUITS
- ⑭ 83' (2) 2" HDPE FIBER OPTICS & (1) 2" STREET LIGHT CONDUITS
- ⑮ 175' (2) 2" HDPE FIBER OPTICS & (1) 2" STREET LIGHT CONDUITS
- ⑯ 175' (2) 2" HDPE FIBER OPTICS & (1) 2" STREET LIGHT CONDUITS
- ⑰ 175' (2) 2" HDPE FIBER OPTICS & (1) 2" STREET LIGHT CONDUITS
- ⑲ 65' (1) 2" STREET LIGHT CONDUIT
- ⓧ SEE CONTINUATION SHEET FOR CONDUIT INFORMATION

- Ⓢ STREET LIGHT 10" x 17" HANDHOLE.
- Ⓜ FIBER OPTICS 30"x48" HANDHOLE UNLESS MARKED OTHERWISE.
- Ⓛ PROPOSED STREET LIGHT
- Ⓟ EXISTING STREET POST LIGHT
- Ⓞ EXISTING STREET POST LIGHT WITH STREET SIGN
- Ⓜ EXISTING MASTARM STREET LIGHT

NOTE:

- A. 2" HDPE BLACK WITH ORANGE STRIPE FIBER OPTICS CONDUITS ONLY TO BE TERMINATED IN FIBER OPTICS HANDHOLES.
- B. 2" HDPE GRAY STREET LIGHT CONDUITS ONLY TO BE TERMINATED IN STREET LIGHT HANDHOLES.
- C. VOLTAGE DROP TO STREET LIGHT FIXTURES SHALL NOT EXCEED 5%.
- D. POSTED SPEED LIMIT IS 45 MPH.
- E. MINIMUM SETBACK FROM TRAVEL LANE IS 20 FEET FOR STREET LIGHT POLES, ELECTRICAL SERVICE FACILITY INSTALLATIONS, AND ANY OTHER INSTALLED FACILITIES ABOVE GRADE.

MATCHLINE-STA 367+53
FOR CONTINUATION SEE SHEET 14

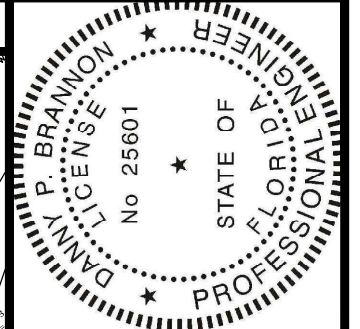

Digitally signed by
Danny P Brannon
Date: 2021.09.11
16:25:18 -04'00'

Dan Brannon

DANNY P. BRANNON, P. E.
FLORIDA P. E. NO. 25601

DATE _____

Town of Longboat Key

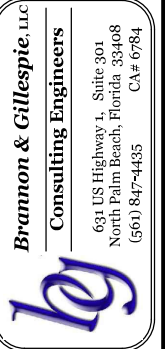

DRAWINGS FOR:
FIBER OPTIC AND STREET LIGHTING UTILITY CONSTRUCTION
LONGBOAT KEY, FLORIDA



Date: 12/01/2019
Scale: AS NOTED
Drawn: DPB
Checked: DPB
Job # 2014-LBK

Sheet
15 OF 22

MATCHLINE-STA 381+14
FOR CONTINUATION SEE SHEET 17

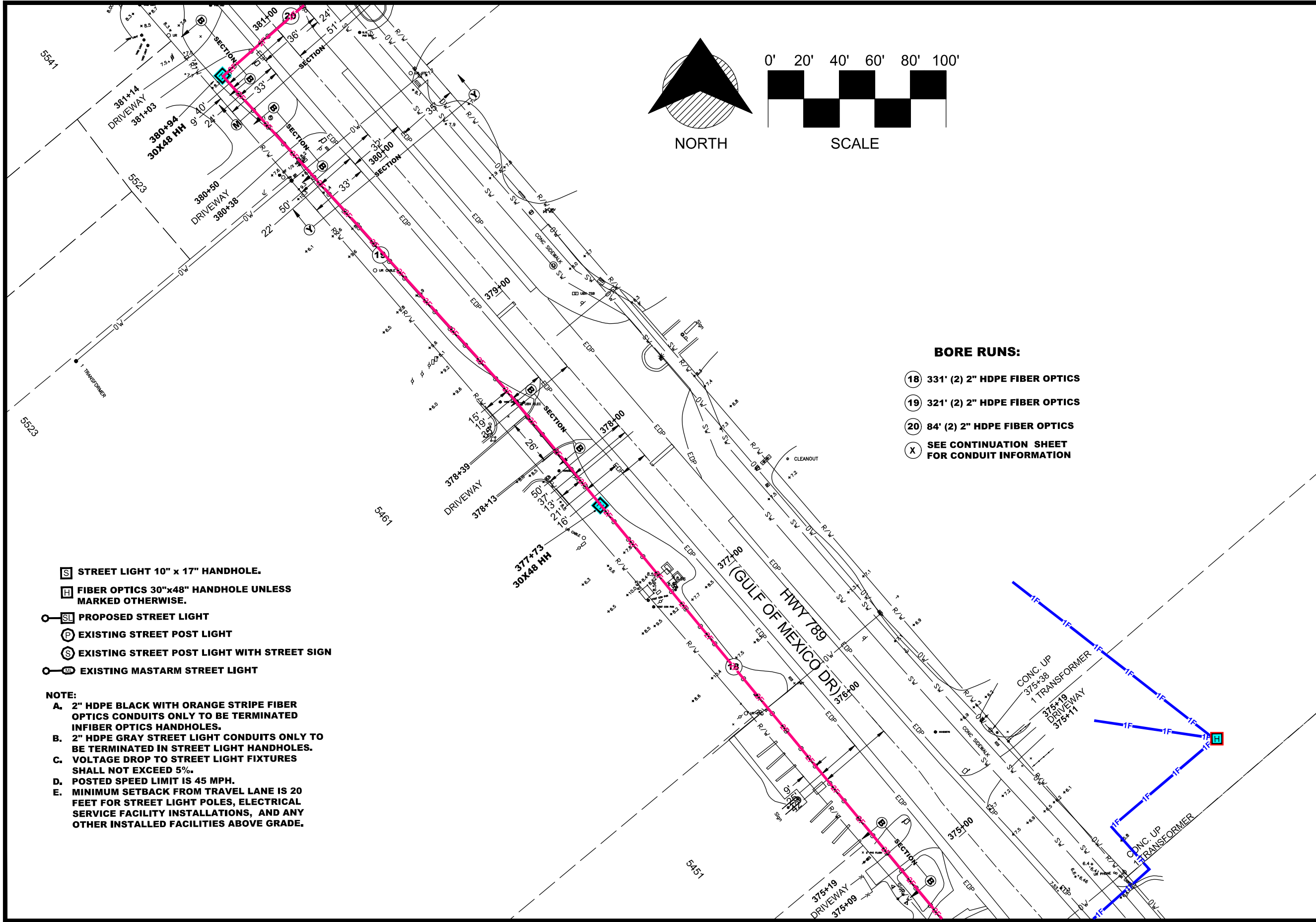

- BORE RUNS:**
- 18 331' (2) 2" HDPE FIBER OPTICS
 - 19 321' (2) 2" HDPE FIBER OPTICS
 - 20 84' (2) 2" HDPE FIBER OPTICS
 - X SEE CONTINUATION SHEET FOR CONDUIT INFORMATION

- [S] STREET LIGHT 10" x 17" HANDHOLE.
- [H] FIBER OPTICS 30"x48" HANDHOLE UNLESS MARKED OTHERWISE.
- [SL] PROPOSED STREET LIGHT
- [P] EXISTING STREET POST LIGHT
- [S] EXISTING STREET POST LIGHT WITH STREET SIGN
- [M] EXISTING MASTARM STREET LIGHT

NOTE:

- A. 2" HDPE BLACK WITH ORANGE STRIPE FIBER OPTICS CONDUITS ONLY TO BE TERMINATED IN FIBER OPTICS HANDHOLES.
- B. 2" HDPE GRAY STREET LIGHT CONDUITS ONLY TO BE TERMINATED IN STREET LIGHT HANDHOLES.
- C. VOLTAGE DROP TO STREET LIGHT FIXTURES SHALL NOT EXCEED 5%.
- D. POSTED SPEED LIMIT IS 45 MPH.
- E. MINIMUM SETBACK FROM TRAVEL LANE IS 20 FEET FOR STREET LIGHT POLES, ELECTRICAL SERVICE FACILITY INSTALLATIONS, AND ANY OTHER INSTALLED FACILITIES ABOVE GRADE.

MATCHLINE-STA 374+33
FOR CONTINUATION SEE SHEET 15

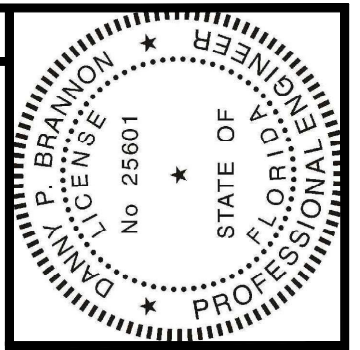

Digitally signed by
Danny P Brannon
Date: 2021.09.11
16:25:18 -04'00'

Danny P. Brannon

DANNY P. BRANNON, P. E.
FLORIDA P. E. NO. 25601

DATE

Town of Longboat Key

Brammon & Gillespie, LLC
Consulting Engineers

631 US Highway 1, Suite 301
North Palm Beach, Florida 33408
(561) 847-4435 CA# 6784

DRAWINGS FOR:
FIBER OPTIC AND STREET LIGHTING UTILITY CONSTRUCTION
LONGBOAT KEY, FLORIDA



Date:	12/01/2019
Scale:	AS NOTED
Drawn:	DPB
Checked:	DPB
Job #	2014-LBK
Sheet	16 OF 22

MATCHLINE-STA 387+95
FOR CONTINUATION SEE SHEET 18

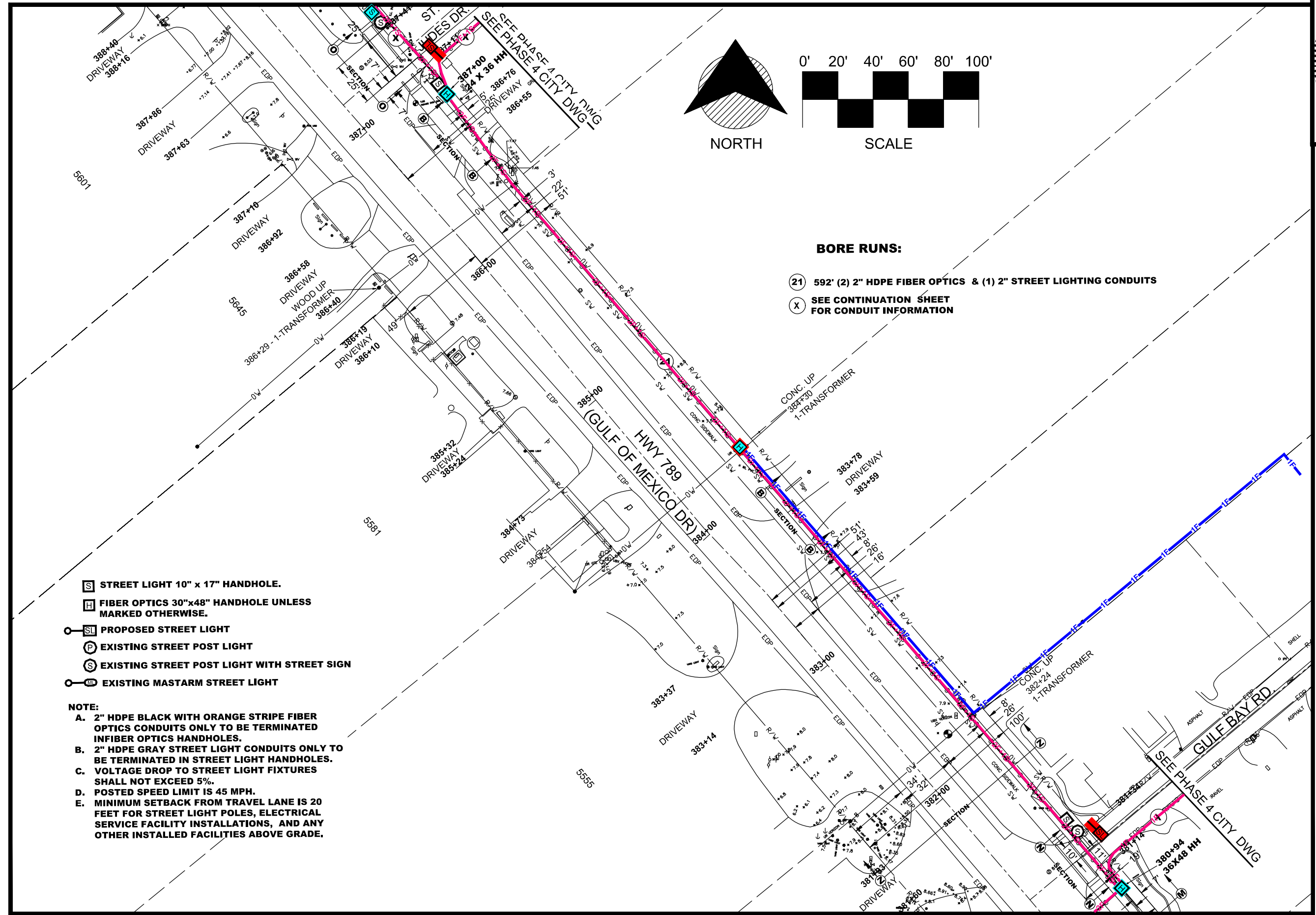

0' 20' 40' 60' 80' 100'
SCALE

BORE RUNS:

- (21) 592' (2) 2" HDPE FIBER OPTICS & (1) 2" STREET LIGHTING CONDUITS
- (X) SEE CONTINUATION SHEET FOR CONDUIT INFORMATION

- [S] STREET LIGHT 10" x 17" HANDHOLE.
- [H] FIBER OPTICS 30"x48" HANDHOLE UNLESS MARKED OTHERWISE.
- [SL] PROPOSED STREET LIGHT
- [P] EXISTING STREET POST LIGHT
- [S] EXISTING STREET POST LIGHT WITH STREET SIGN
- [M] EXISTING MASTARM STREET LIGHT

NOTE:

- A. 2" HDPE BLACK WITH ORANGE STRIPE FIBER OPTICS CONDUITS ONLY TO BE TERMINATED IN FIBER OPTICS HANDHOLES.
- B. 2" HDPE GRAY STREET LIGHT CONDUITS ONLY TO BE TERMINATED IN STREET LIGHT HANDHOLES.
- C. VOLTAGE DROP TO STREET LIGHT FIXTURES SHALL NOT EXCEED 5%.
- D. POSTED SPEED LIMIT IS 45 MPH.
- E. MINIMUM SETBACK FROM TRAVEL LANE IS 20 FEET FOR STREET LIGHT POLES, ELECTRICAL SERVICE FACILITY INSTALLATIONS, AND ANY OTHER INSTALLED FACILITIES ABOVE GRADE.

MATCHLINE-STA 381+14
FOR CONTINUATION SEE SHEET 16

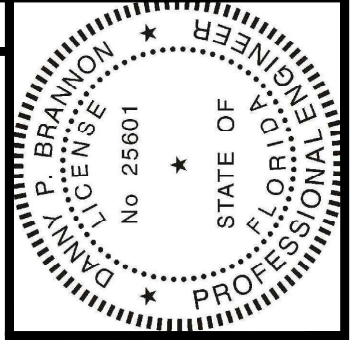

Digitally signed by
Danny P Brannon
Date: 2021.09.11
16:25:18 -04'00'

Danny P. Brannon

DANNY P. BRANNON, P. E.
FLORIDA P. E. NO. 25601

DATE _____

Town of Longboat Key

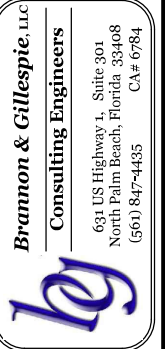

DRAWINGS FOR:
FIBER OPTIC AND STREET LIGHTING UTILITY CONSTRUCTION
LONGBOAT KEY, FLORIDA



Date:	12/01/2019
Scale:	AS NOTED
Drawn:	DPB
Checked:	DPB
Job #	2014-LBK
Sheet	17 OF 22

MATCHLINE-STA 394+72
FOR CONTINUATION SEE SHEET 19

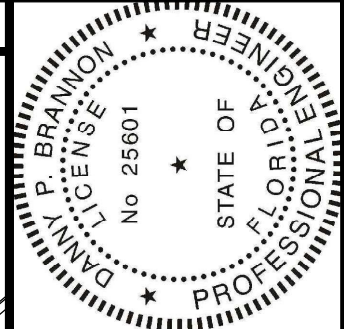

Digitally signed by
Danny P. Brannon
Date: 2021.09.11
16:25:18 -04'00'

DANNY P. BRANNON, P. E.
FLORIDA P. E. NO. 25601

DATE

Town of Longboat Key

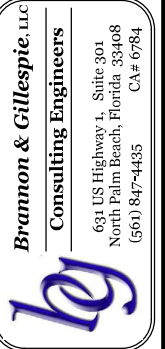

BRANNON & GILLESPIE, LLC
CONSULTING ENGINEERS

631 US Highway 1, Suite 301
North Palm Beach, Florida 33408
(561) 847-4435 CA# 6784



DRAWINGS FOR:
FIBER OPTIC AND STREET LIGHTING UTILITY CONSTRUCTION
LONGBOAT KEY, FLORIDA

Date:	12/01/2019
Scale:	AS NOTED
Drawn:	DPB
Checked:	DPB
Job #	2014-LBK
Sheet	18 OF 22

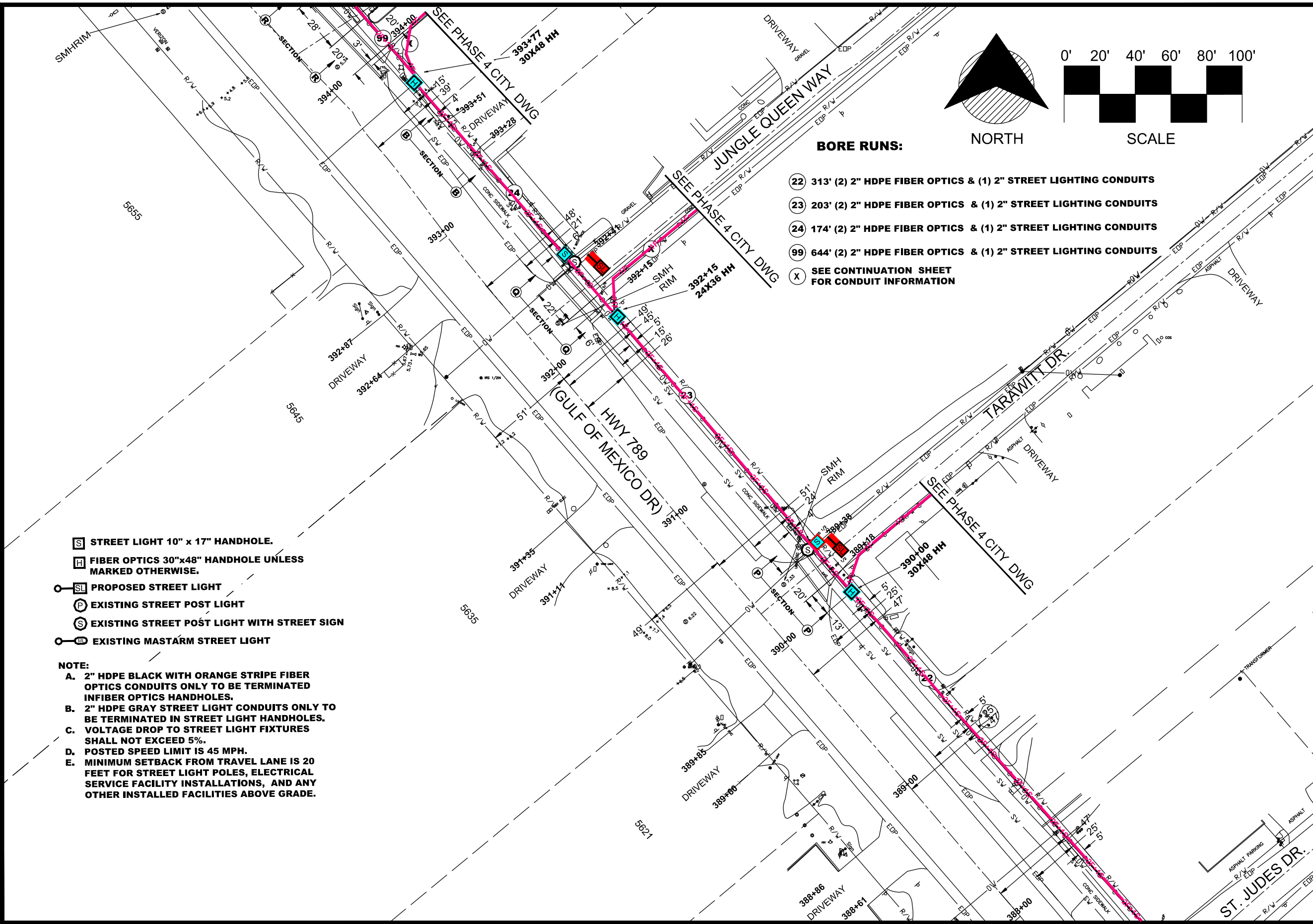

BORE RUNS:

- 22 313' (2) 2" HDPE FIBER OPTICS & (1) 2" STREET LIGHTING CONDUITS
- 23 203' (2) 2" HDPE FIBER OPTICS & (1) 2" STREET LIGHTING CONDUITS
- 24 174' (2) 2" HDPE FIBER OPTICS & (1) 2" STREET LIGHTING CONDUITS
- 99 644' (2) 2" HDPE FIBER OPTICS & (1) 2" STREET LIGHTING CONDUITS
- X SEE CONTINUATION SHEET FOR CONDUIT INFORMATION

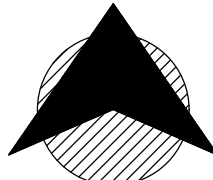

NORTH

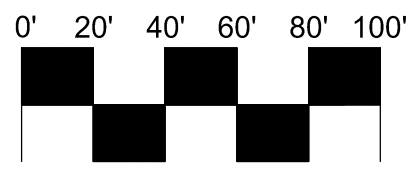

SCALE

- [S] STREET LIGHT 10" x 17" HANDHOLE.
- [F] FIBER OPTICS 30"x48" HANDHOLE UNLESS MARKED OTHERWISE.
- [SL] PROPOSED STREET LIGHT
- [P] EXISTING STREET POST LIGHT
- [S] EXISTING STREET POST LIGHT WITH STREET SIGN
- [M] EXISTING MASTARM STREET LIGHT

- NOTE:**
- A. 2" HDPE BLACK WITH ORANGE STRIPE FIBER OPTICS CONDUITS ONLY TO BE TERMINATED IN FIBER OPTICS HANDHOLES.
 - B. 2" HDPE GRAY STREET LIGHT CONDUITS ONLY TO BE TERMINATED IN STREET LIGHT HANDHOLES.
 - C. VOLTAGE DROP TO STREET LIGHT FIXTURES SHALL NOT EXCEED 5%.
 - D. POSTED SPEED LIMIT IS 45 MPH.
 - E. MINIMUM SETBACK FROM TRAVEL LANE IS 20 FEET FOR STREET LIGHT POLES, ELECTRICAL SERVICE FACILITY INSTALLATIONS, AND ANY OTHER INSTALLED FACILITIES ABOVE GRADE.

MATCHLINE-STA 387+95
FOR CONTINUATION SEE SHEET 17

MATCHLINE-STA 401+55
FOR CONTINUATION SEE SHEET 20

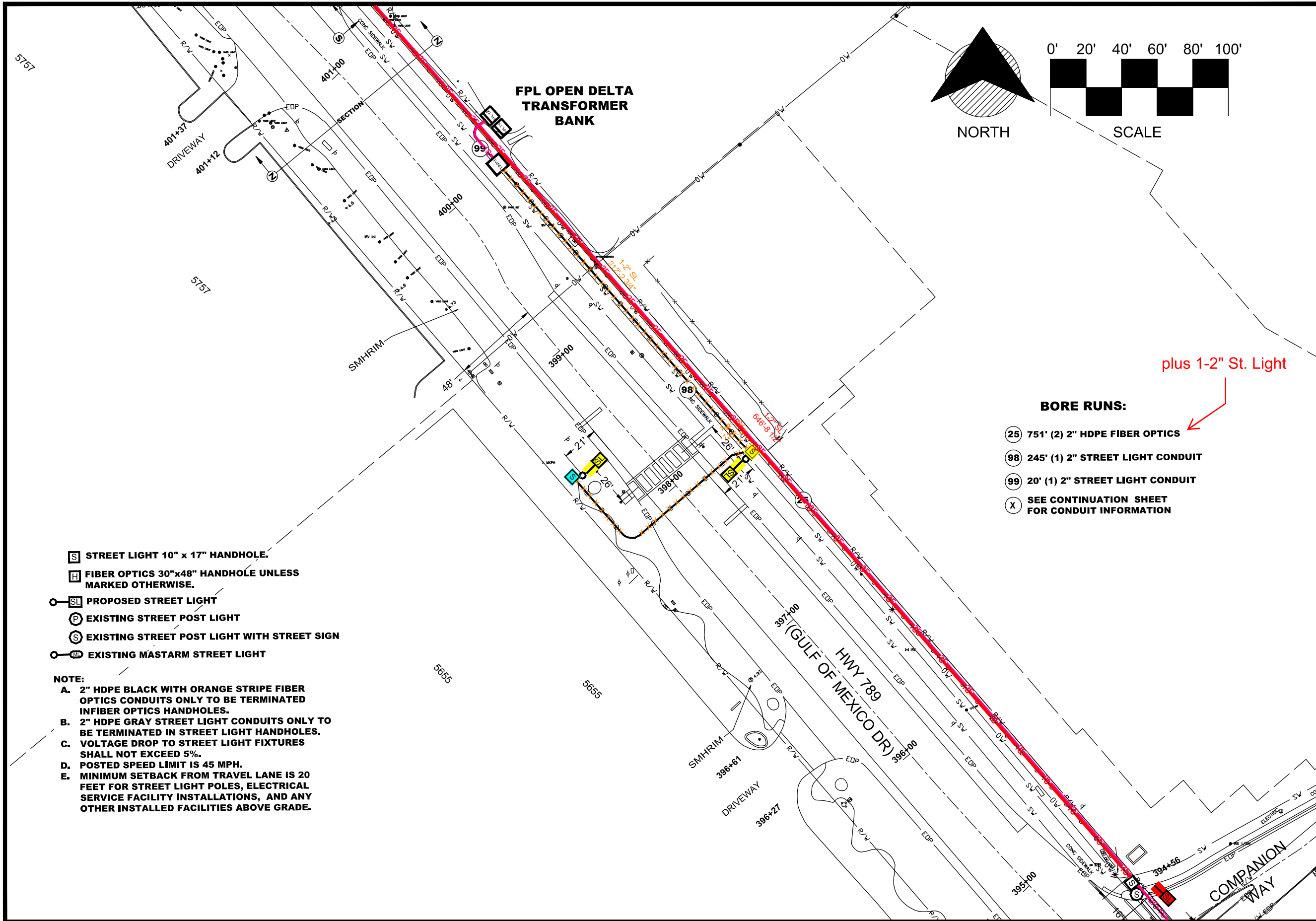

BORE RUNS:

- 25 751' (2) 2" HDPE FIBER OPTICS
- 98 245' (1) 2" STREET LIGHT CONDUIT
- 99 20' (1) 2" STREET LIGHT CONDUIT
- X SEE CONTINUATION SHEET FOR CONDUIT INFORMATION

plus 1-2" St. Light

- STREET LIGHT 10" x 17" HANDHOLE.
- FIBER OPTICS 30"x48" HANDHOLE UNLESS MARKED OTHERWISE.
- PROPOSED STREET LIGHT
- EXISTING STREET POST LIGHT
- EXISTING STREET POST LIGHT WITH STREET SIGN
- EXISTING MASTARM STREET LIGHT

- NOTE:**
- A. 2" HDPE BLACK WITH ORANGE STRIPE FIBER OPTICS CONDUITS ONLY TO BE TERMINATED IN FIBER OPTICS HANDHOLES.
 - B. 2" HDPE GRAY STREET LIGHT CONDUITS ONLY TO BE TERMINATED IN STREET LIGHT HANDHOLES.
 - C. VOLTAGE DROP TO STREET LIGHT FIXTURES SHALL NOT EXCEED 5%.
 - D. POSTED SPEED LIMIT IS 45 MPH.
 - E. MINIMUM SETBACK FROM TRAVEL LANE IS 20 FEET FOR STREET LIGHT POLES, ELECTRICAL SERVICE FACILITY INSTALLATIONS, AND ANY OTHER INSTALLED FACILITIES ABOVE GRADE.

MATCHLINE-STA 394+72
FOR CONTINUATION SEE SHEET 18

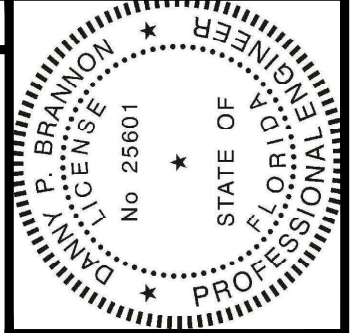

Digitally signed by
Danny P Brannon
Date: 2021.09.11
16:25:18 -04'00'

Danny P. Brannon

DANNY P. BRANNON, P. E.
FLORIDA P. E. NO. 25601

DATE

Town of Longboat Key

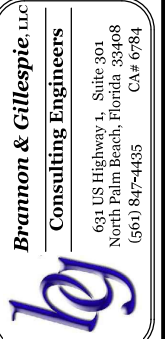

DRAWINGS FOR:
FIBER OPTIC AND STREET LIGHTING UTILITY CONSTRUCTION
LONGBOAT KEY, FLORIDA



Date: 12/01/2019
Scale: AS NOTED
Drawn: DPB
Checked: DPB
Job # 2014-LBK

Sheet
19 OF 22

MATCHLINE-STA 408+38
FOR CONTINUATION SEE SHEET 21

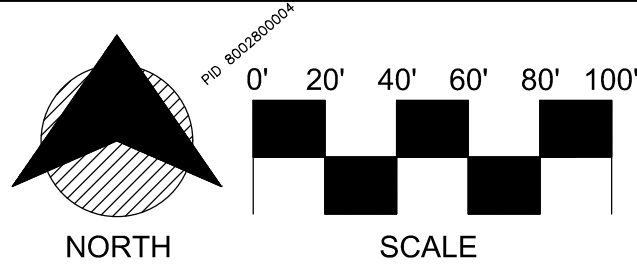
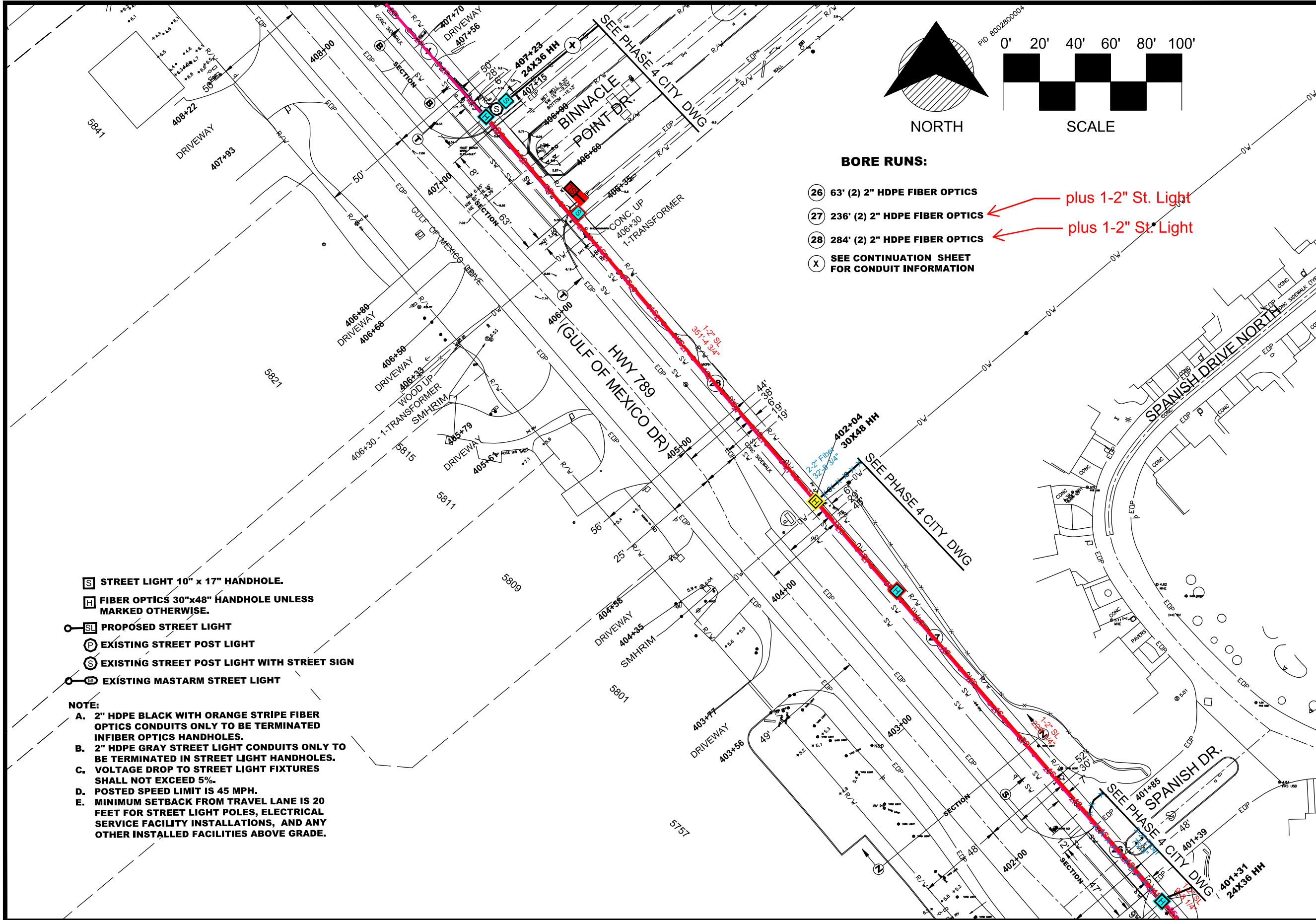

BORE RUNS:

- ②6 63' (2) 2" HDPE FIBER OPTICS ← plus 1-2" St. Light
- ②7 236' (2) 2" HDPE FIBER OPTICS ← plus 1-2" St. Light
- ②8 284' (2) 2" HDPE FIBER OPTICS ← plus 1-2" St. Light
- ⓧ SEE CONTINUATION SHEET FOR CONDUIT INFORMATION

- Ⓢ STREET LIGHT 10" x 17" HANDHOLE.
- Ⓜ FIBER OPTICS 30"x48" HANDHOLE UNLESS MARKED OTHERWISE.
- Ⓛ PROPOSED STREET LIGHT
- Ⓟ EXISTING STREET POST LIGHT
- Ⓞ EXISTING STREET POST LIGHT WITH STREET SIGN
- Ⓜ EXISTING MASTARM STREET LIGHT

- NOTE:**
- A. 2" HDPE BLACK WITH ORANGE STRIPE FIBER OPTICS CONDUITS ONLY TO BE TERMINATED IN FIBER OPTICS HANDHOLES.
 - B. 2" HDPE GRAY STREET LIGHT CONDUITS ONLY TO BE TERMINATED IN STREET LIGHT HANDHOLES.
 - C. VOLTAGE DROP TO STREET LIGHT FIXTURES SHALL NOT EXCEED 5%.
 - D. POSTED SPEED LIMIT IS 45 MPH.
 - E. MINIMUM SETBACK FROM TRAVEL LANE IS 20 FEET FOR STREET LIGHT POLES, ELECTRICAL SERVICE FACILITY INSTALLATIONS, AND ANY OTHER INSTALLED FACILITIES ABOVE GRADE.

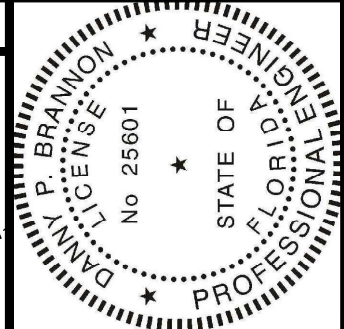

Digitally signed by
Danny P Brannon
Date: 2021.09.11
16:25:18 -04'00'

Dan Brannon

DANNY P. BRANNON, P. E.
FLORIDA P. E. NO. 25601

DATE

Town of Longboat Key

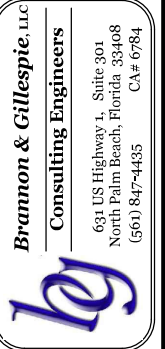

DRAWINGS FOR:
FIBER OPTIC AND STREET LIGHTING UTILITY CONSTRUCTION
LONGBOAT KEY, FLORIDA



Date:	12/01/2019
Scale:	AS NOTED
Drawn:	DPB
Checked:	DPB
Job #	2014-LBK
Sheet	20 OF 22

MATCHLINE-STA 401+55
FOR CONTINUATION SEE SHEET 19

MATCHLINE-STA 415+18
FOR CONTINUATION SEE SHEET 22

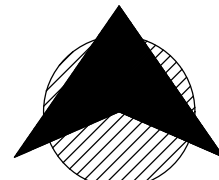
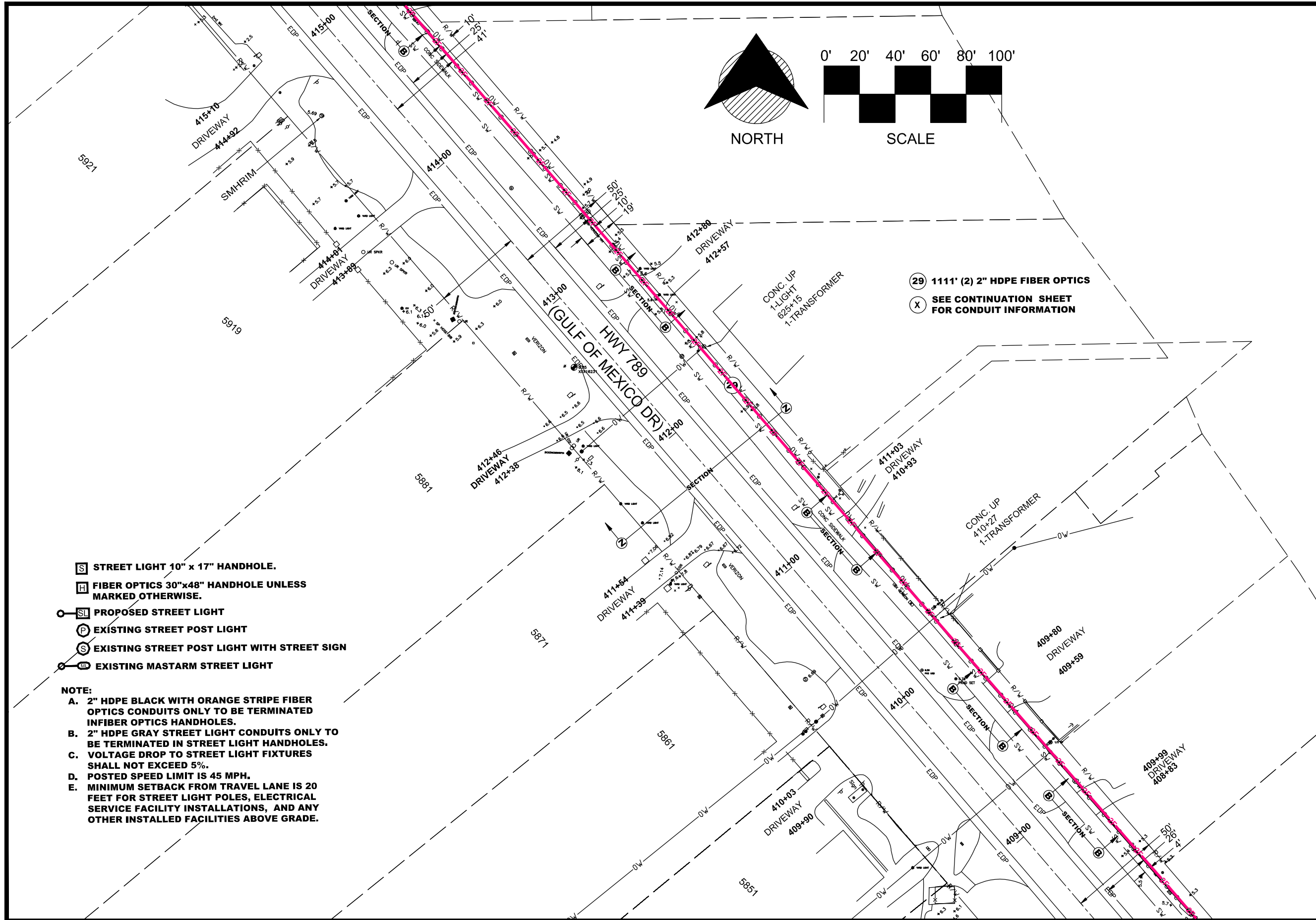

0' 20' 40' 60' 80' 100'

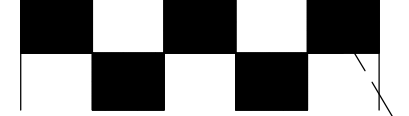

SCALE

- 29 1111' (2) 2" HDPE FIBER OPTICS
- X SEE CONTINUATION SHEET FOR CONDUIT INFORMATION

- [S] STREET LIGHT 10" x 17" HANDHOLE.
- [H] FIBER OPTICS 30"x48" HANDHOLE UNLESS MARKED OTHERWISE.
- [SL] PROPOSED STREET LIGHT
- [P] EXISTING STREET POST LIGHT
- [S] EXISTING STREET POST LIGHT WITH STREET SIGN
- [M] EXISTING MASTARM STREET LIGHT

- NOTE:**
- A. 2" HDPE BLACK WITH ORANGE STRIPE FIBER OPTICS CONDUITS ONLY TO BE TERMINATED IN FIBER OPTICS HANDHOLES.
 - B. 2" HDPE GRAY STREET LIGHT CONDUITS ONLY TO BE TERMINATED IN STREET LIGHT HANDHOLES.
 - C. VOLTAGE DROP TO STREET LIGHT FIXTURES SHALL NOT EXCEED 5%.
 - D. POSTED SPEED LIMIT IS 45 MPH.
 - E. MINIMUM SETBACK FROM TRAVEL LANE IS 20 FEET FOR STREET LIGHT POLES, ELECTRICAL SERVICE FACILITY INSTALLATIONS, AND ANY OTHER INSTALLED FACILITIES ABOVE GRADE.

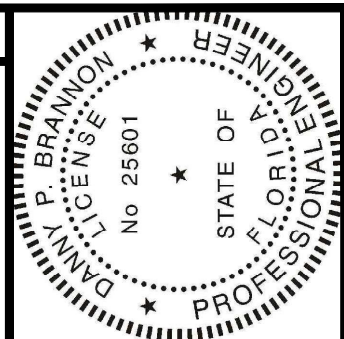

Digitally signed by
Danny P Brannon
Date: 2021.09.11
16:25:18 -04'00'

Danny P. Brannon

DANNY P. BRANNON, P. E.
FLORIDA P. E. NO. 25601

DATE _____

Town of Longboat Key

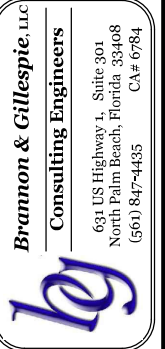

BRANNON & GILLESPIE, LLC
Consulting Engineers

631 US Highway 1, Suite 301
North Palm Beach, Florida 33408
(561) 847-4435 CA# 6784



DRAWINGS FOR:
FIBER OPTIC AND STREET LIGHTING UTILITY CONSTRUCTION
LONGBOAT KEY, FLORIDA

Date:	12/01/2019
Scale:	AS NOTED
Drawn:	DPB
Checked:	DPB
Job #	2014-LBK
Sheet	21 OF 22

MATCHLINE-STA 408+38
FOR CONTINUATION SEE SHEET 20

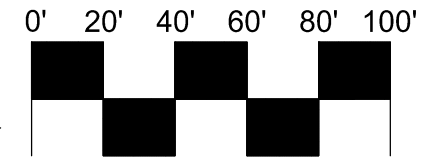
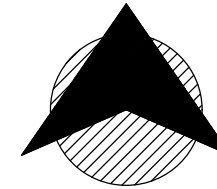

NORTH

SCALE

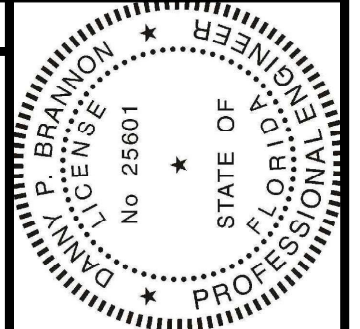

Digitally signed by
Danny P Brannon
Date: 2021.09.11
16:25:18 -04'00'

DANNY P. BRANNON, P. E.
FLORIDA P. E. NO. 25601

DATE

BORE RUNS:

(X) SEE CONTINUATION SHEET
FOR CONDUIT INFORMATION

- STREET LIGHT 10" x 17" HANDHOLE.
- FIBER OPTICS 30"x48" HANDHOLE UNLESS MARKED OTHERWISE.
- PROPOSED STREET LIGHT
- EXISTING STREET POST LIGHT
- EXISTING STREET POST LIGHT WITH STREET SIGN
- EXISTING MASTARM STREET LIGHT

NOTE:

- A. 2" HDPE BLACK WITH ORANGE STRIPE FIBER OPTICS CONDUITS ONLY TO BE TERMINATED IN FIBER OPTICS HANDHOLES.
- B. 2" HDPE GRAY STREET LIGHT CONDUITS ONLY TO BE TERMINATED IN STREET LIGHT HANDHOLES.
- C. VOLTAGE DROP TO STREET LIGHT FIXTURES SHALL NOT EXCEED 5%.
- D. POSTED SPEED LIMIT IS 45 MPH.
- E. MINIMUM SETBACK FROM TRAVEL LANE IS 20 FEET FOR STREET LIGHT POLES, ELECTRICAL SERVICE FACILITY INSTALLATIONS, AND ANY OTHER INSTALLED FACILITIES ABOVE GRADE.

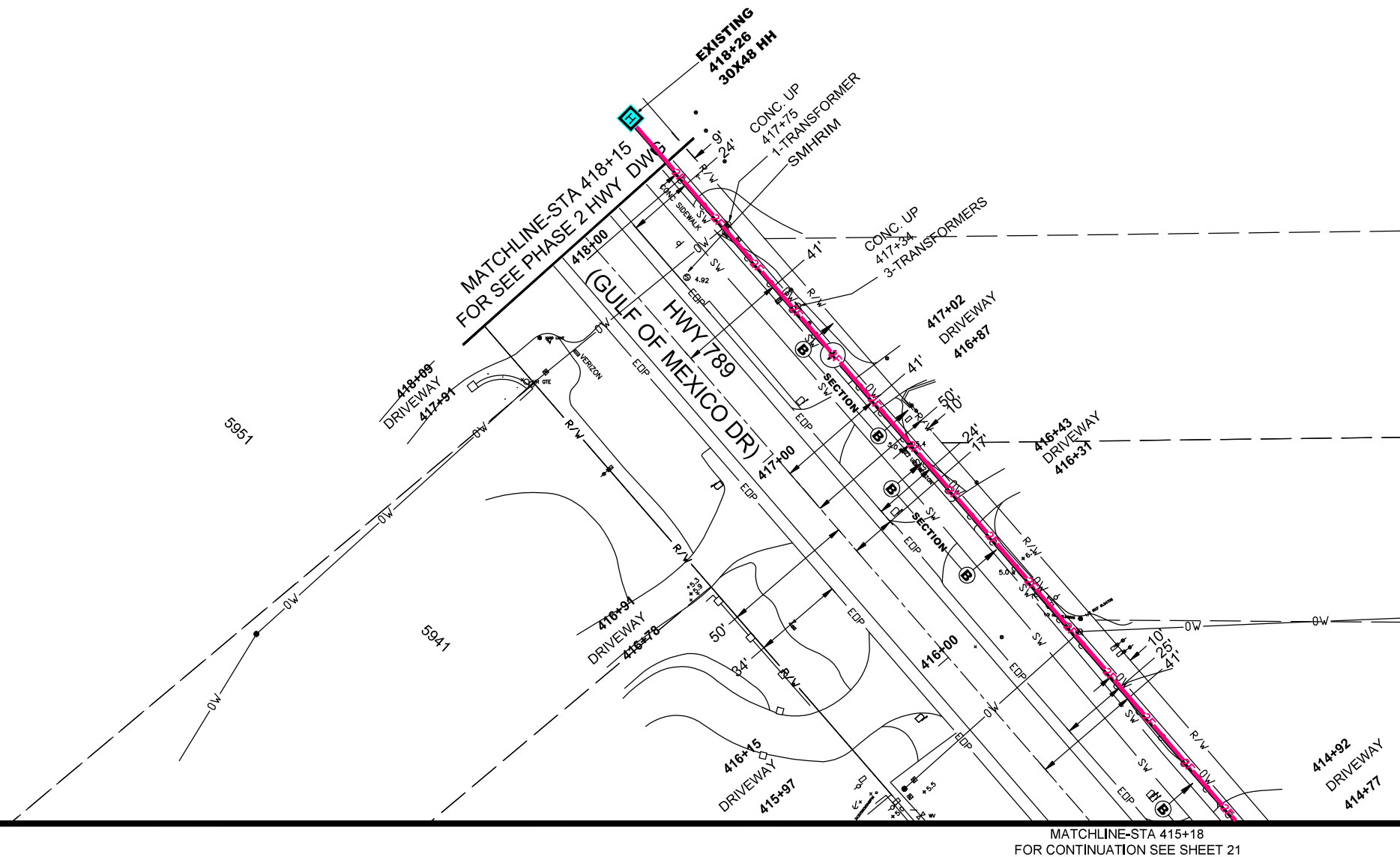

Town of Longboat Key

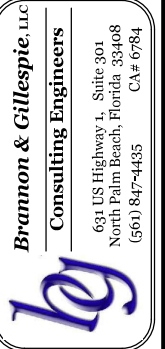

DRAWINGS FOR:
FIBER OPTIC AND STREET LIGHTING UTILITY CONSTRUCTION
LONGBOAT KEY, FLORIDA



Date:	12/01/2019
Scale:	AS NOTED
Drawn:	DPB
Checked:	DPB
Job #	2014-LBK
Sheet	22 OF 22